

John Lewis

## ABACUS Filing desk LH, RH

Stock number: 816 / 22370

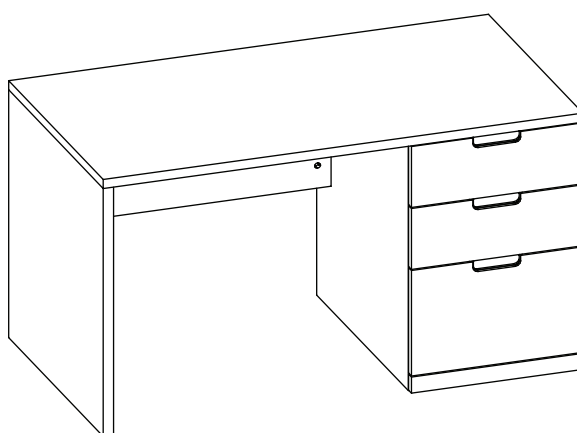
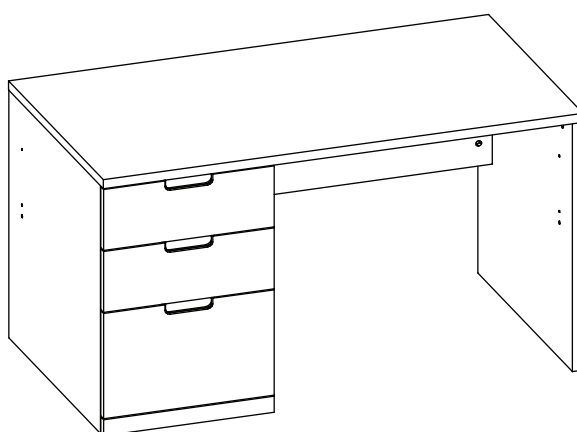

H74 W120 D65cm

Thank you for purchasing the ABACUS filing desk LH, RH. Please read the instructions and warnings carefully before use, to ensure safe and satisfactory operation of this product.

At John Lewis, we are committed to making great products possible.

From our in-house Design Team, to our Buyers, we work together to bring great design to life.

Our expert Product Technologists work collaboratively with our buyers and suppliers to assure the legality, safety and quality of the product we sell.

We are all committed to designing and developing products to the highest industry standards.

We hope you are happy with your product and welcome any feedback or comments you may have.

The John Lewis Team

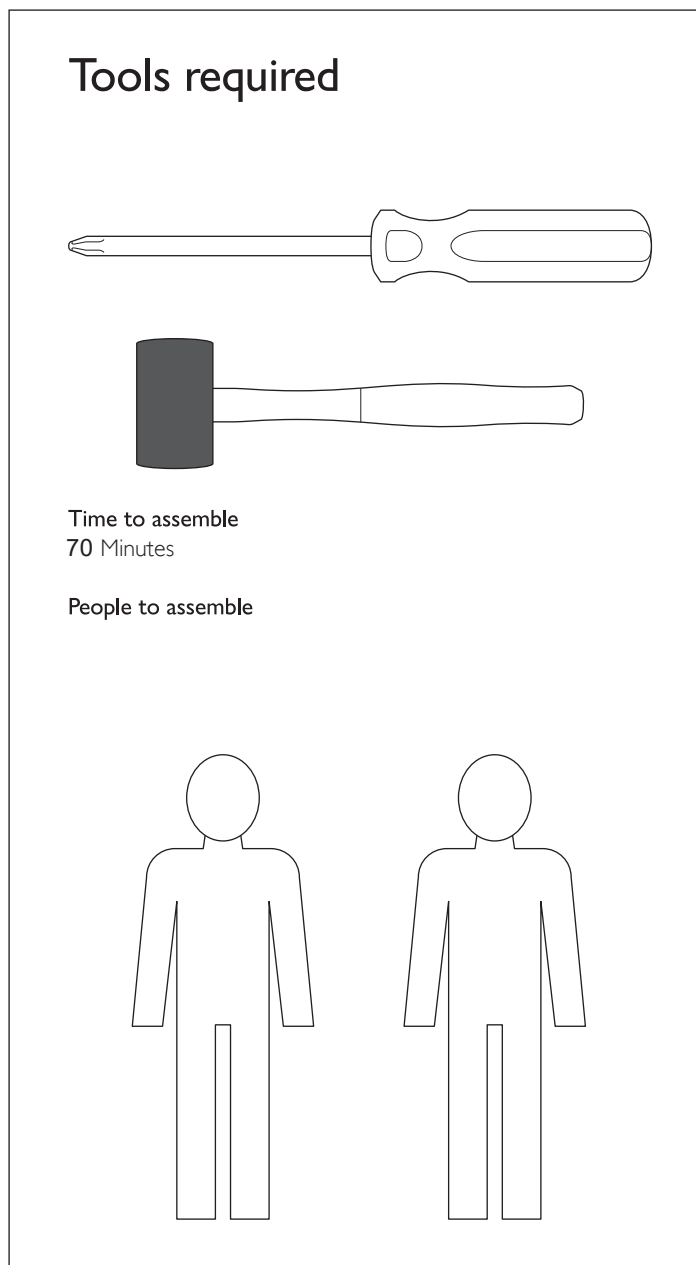

# Important safety information

## Warnings

- ⚠ The product should only be used on firm, level ground.
- ⚠ Keep small parts out of reach of children .
- ⚠ Ensure the product is fully assembled as illustrated before use.

## Do's

- ✓ Check the pack and make sure you have all the parts listed.
- ✓ Check all screws or bolts are tightened and inspect regularly.
- ✓ Make sure the legs remain in contact with the ground at all times.

## Don'ts

- ✗ Do not over tighten screws or bolts.
- ✗ Do not stand on the product.
- ✗ Do not use power tools to construct as overtightening and panel failure may occur.

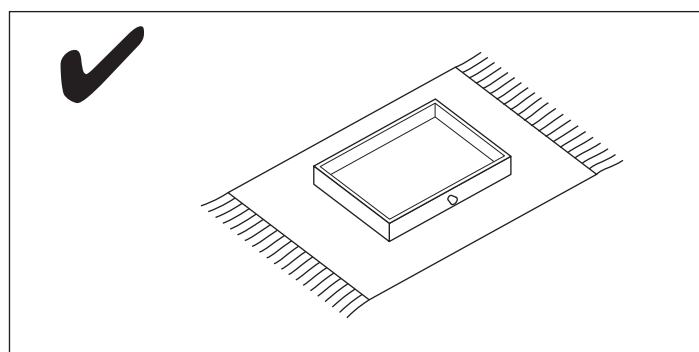
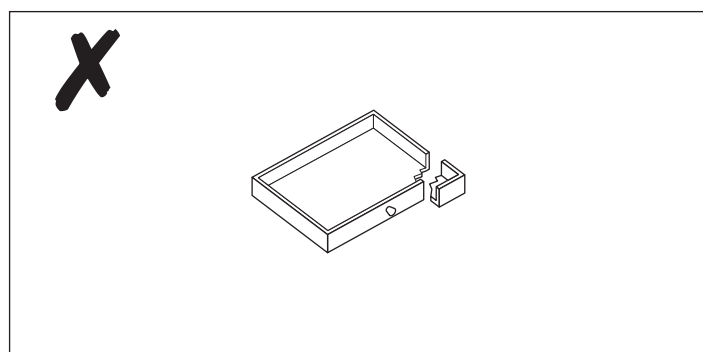
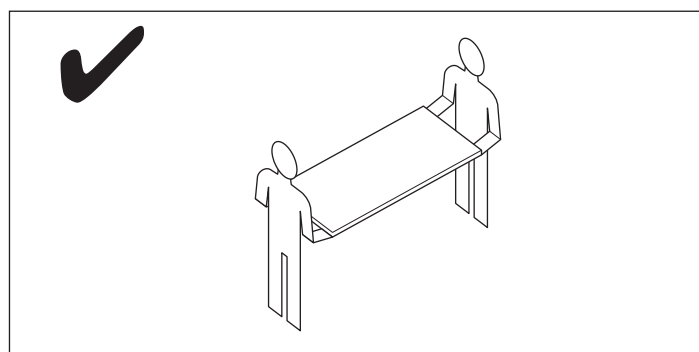
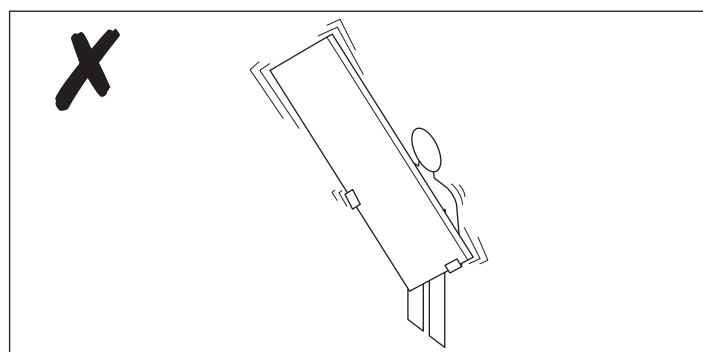
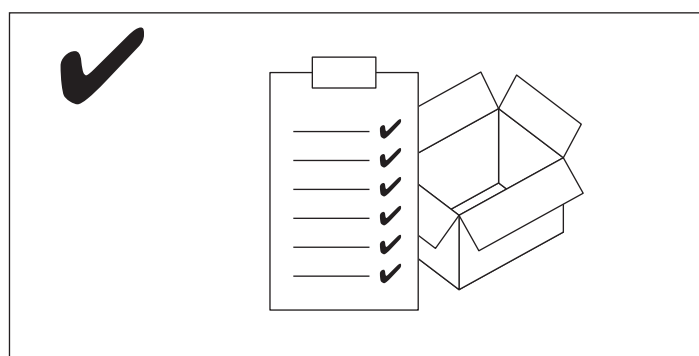
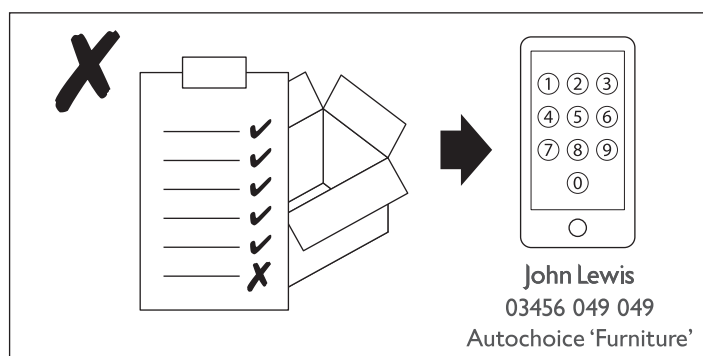

# Your filing desk

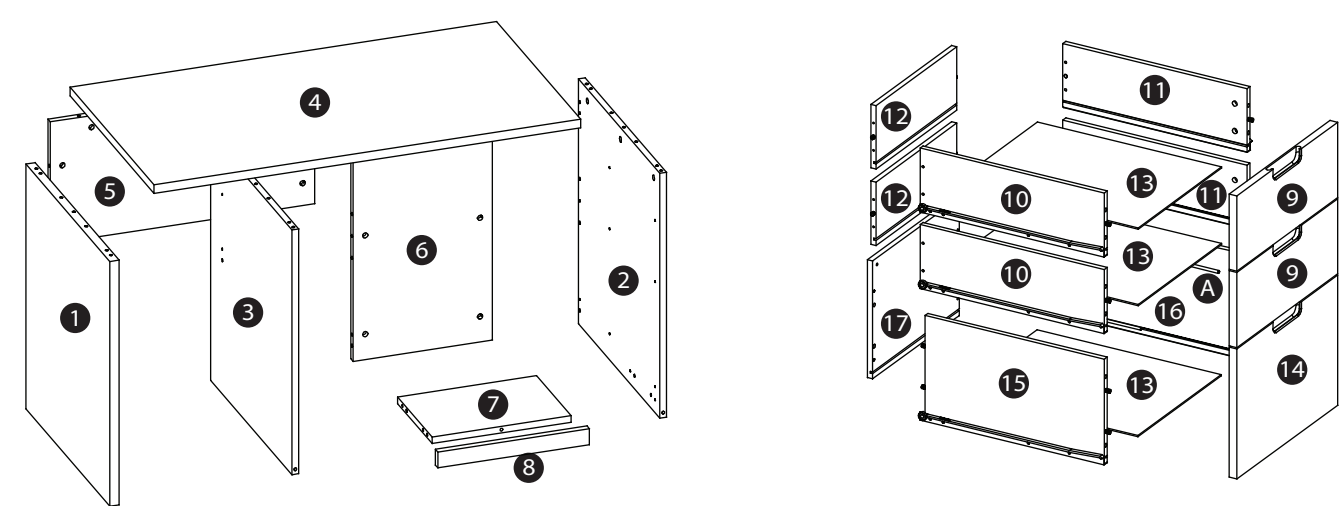

Ref	Description	Dimensions	Qty
1	Left side panel		1
2	Right side panel		1
3	Middle side panel		1
4	Desk top		1
5	Back panel A		1
6	Back panel B		1
7	Connecting rail		1
8	Front rail		1
9	Drawer front A		2
10	Left drawer side A		2
11	Right drawer side A		2
12	Drawer back A		2
13	Drawer bottom		3
14	Drawer front B		1
15	Left drawer side B		1
16	Right drawer side B		1
17	Drawer back B		1

Internal dimensions  
Stock number: 22370  
Filing desk overall size: H74 W120 D65 cm

# Fixtures and fittings

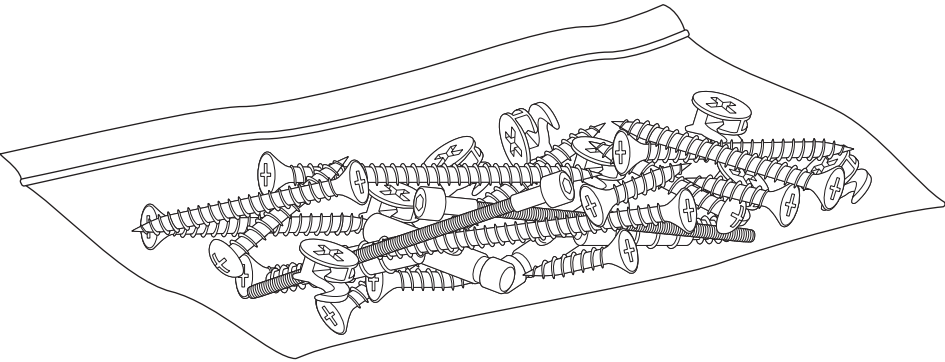

Fixtures and fittings  
supplied (actual size)

				mm									
Ref	Description	Dimensions	Qty										
C	Screw		12										
D	Camlocks		12										
F	Screw		12										
G	Dowels		32										
H	Camlocks		26										
I	Connecting bolts		38										

Fixtures and fittings  
supplied (not actual size)

Ref	Description	Dimensions	Qty	
A	File hanging rods		2	
B	Cover caps		9	
E	Plastic buffers		3	
J	Runners		6	
K	Cover caps		4	
L	Cover caps		2	

# Product assembly

ABACUS filing desk  
22370

## Step 1

Parts, fittings and tools

6 G H

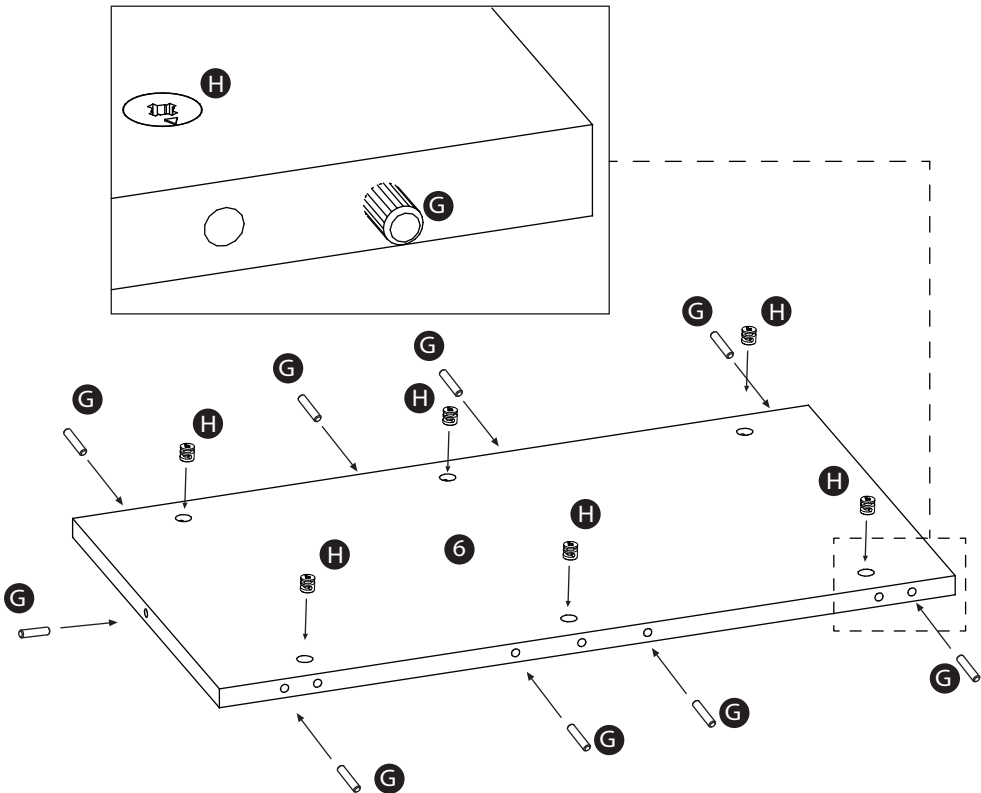
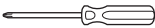

## Step 2

Parts, fittings and tools

2 3 G H

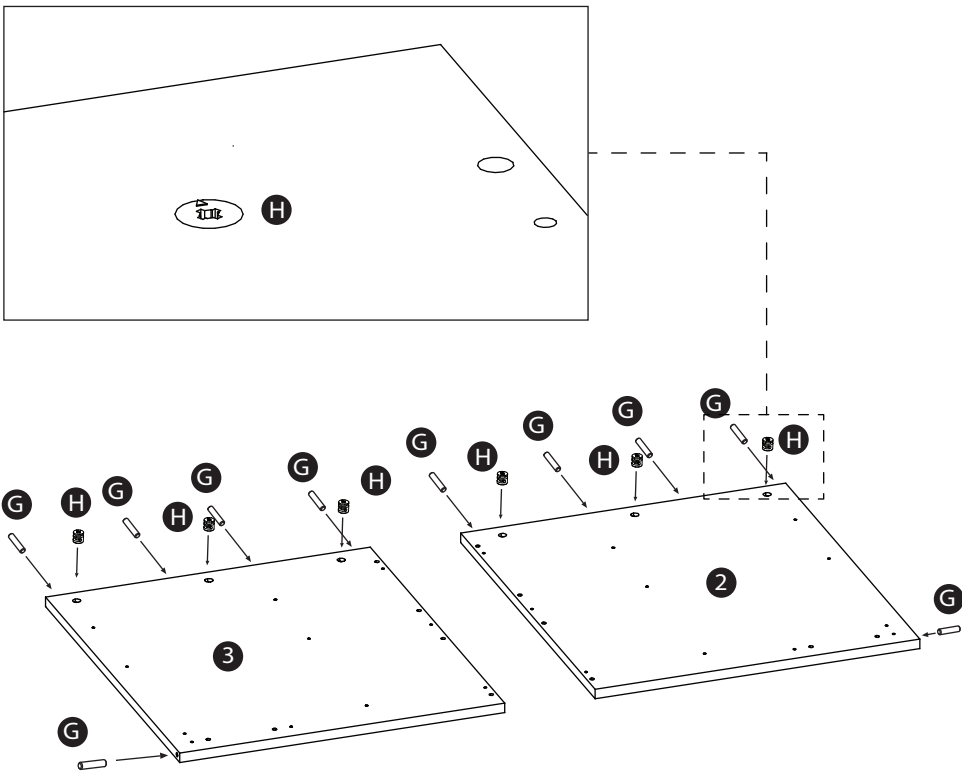
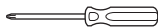

# Step 3

Parts, fittings and tools

- 2
- 3
- J
- F

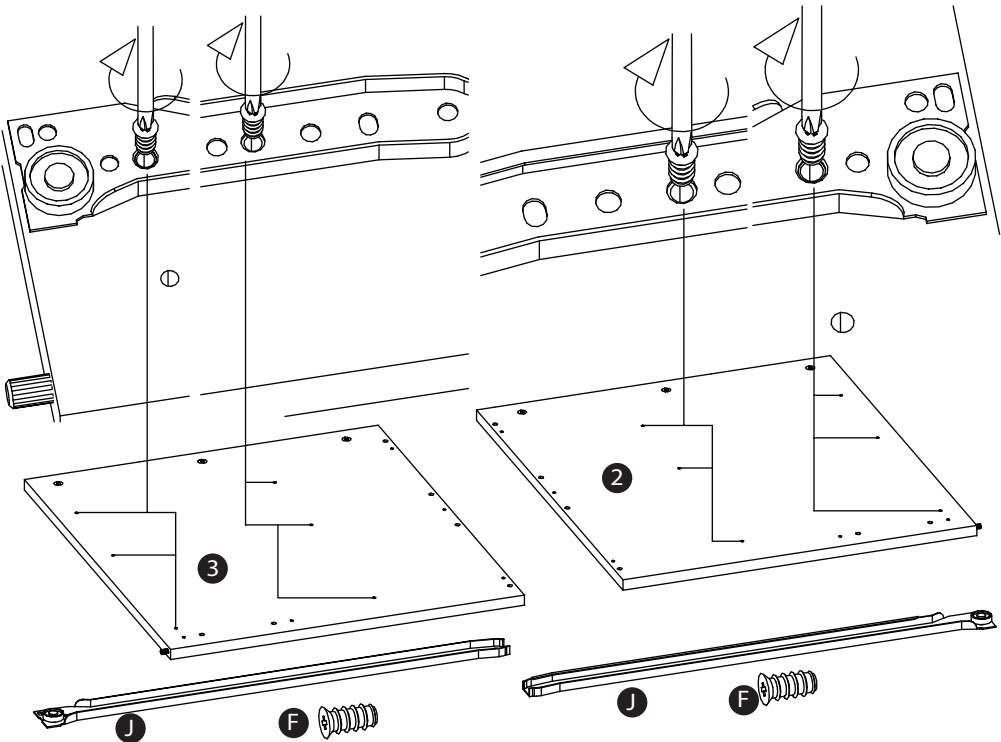
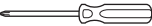

# Step 4

Parts, fittings and tools

- 7
- G
- H

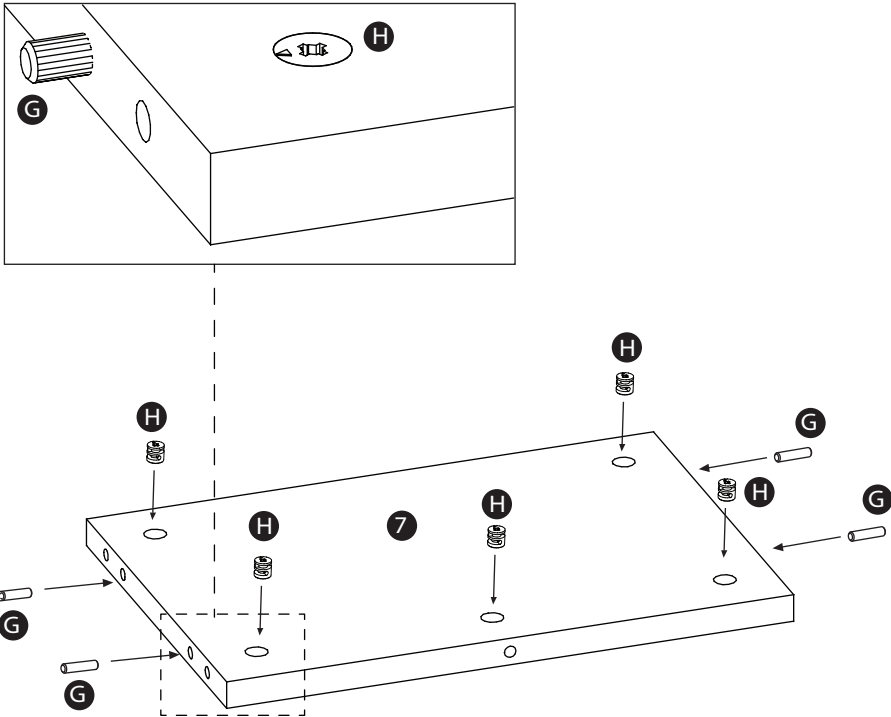
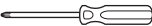

Step 5

Parts, fittings and tools

- 2
- 3
- 1

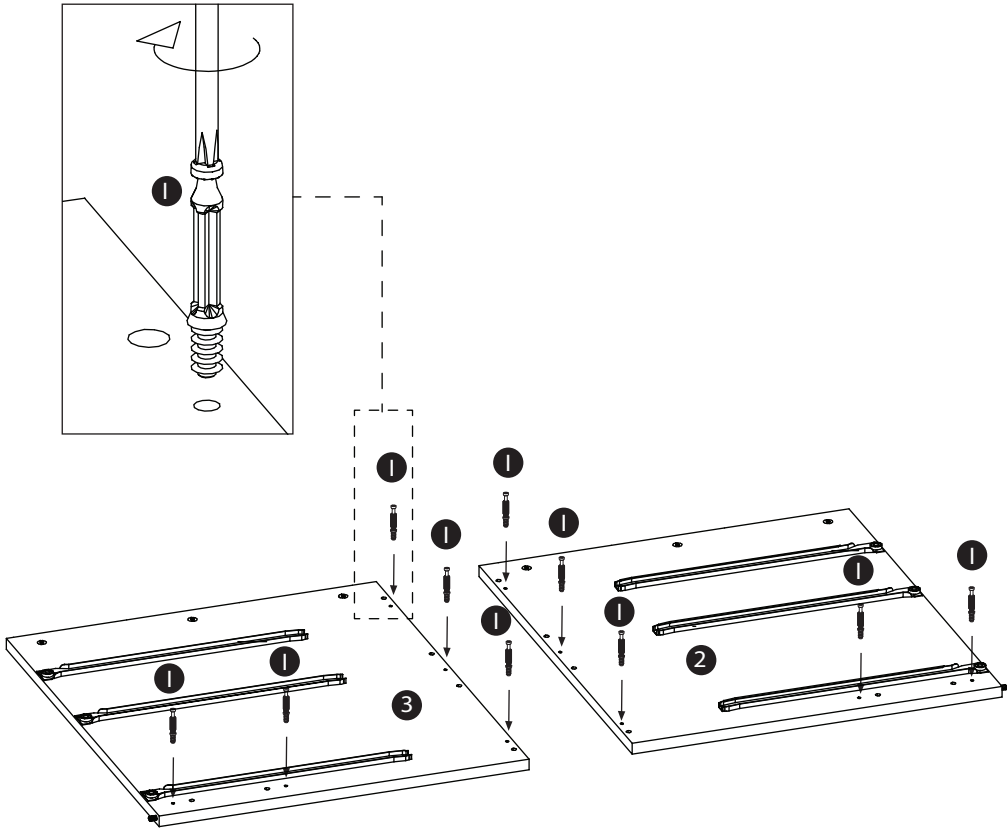
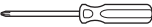

Step 6

Parts, fittings and tools

- 8
- 1

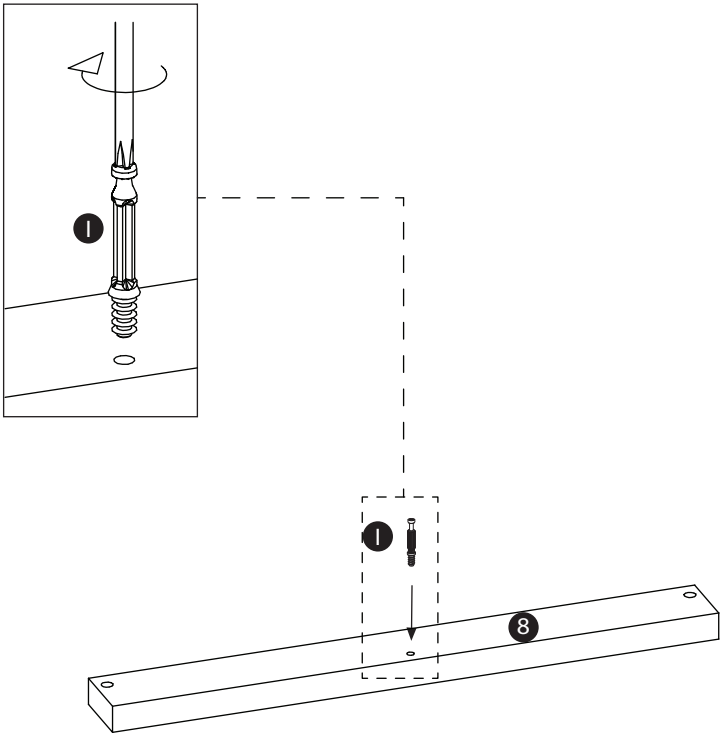
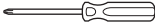



# Step 7

Parts, fittings and tools

- 3
- 6
- 7
- H

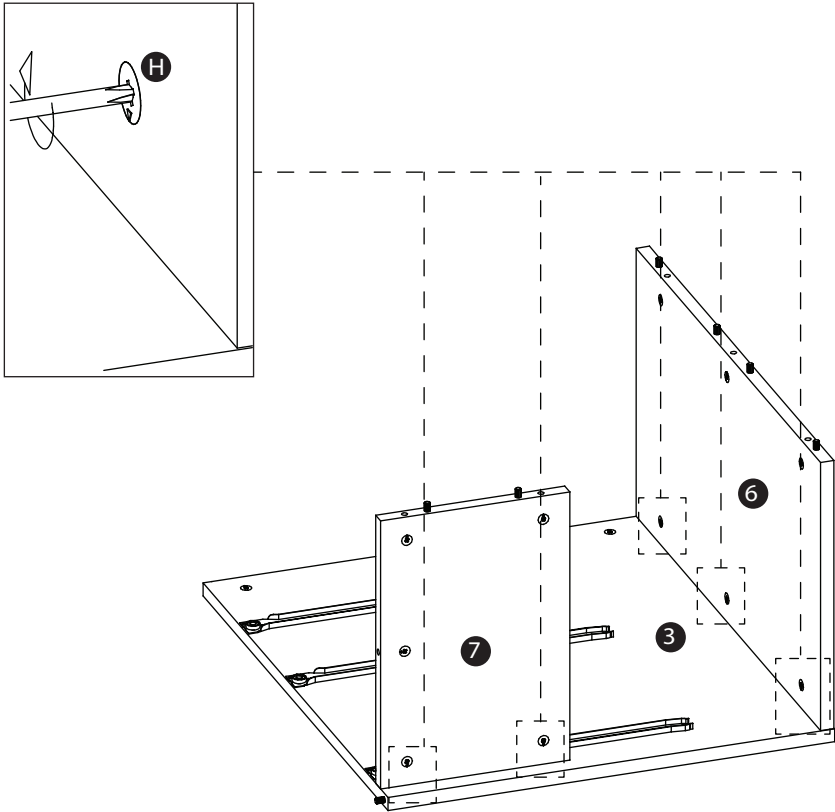
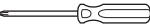

# Step 8

Parts, fittings and tools

- 3
- 6
- 7
- 2
- H

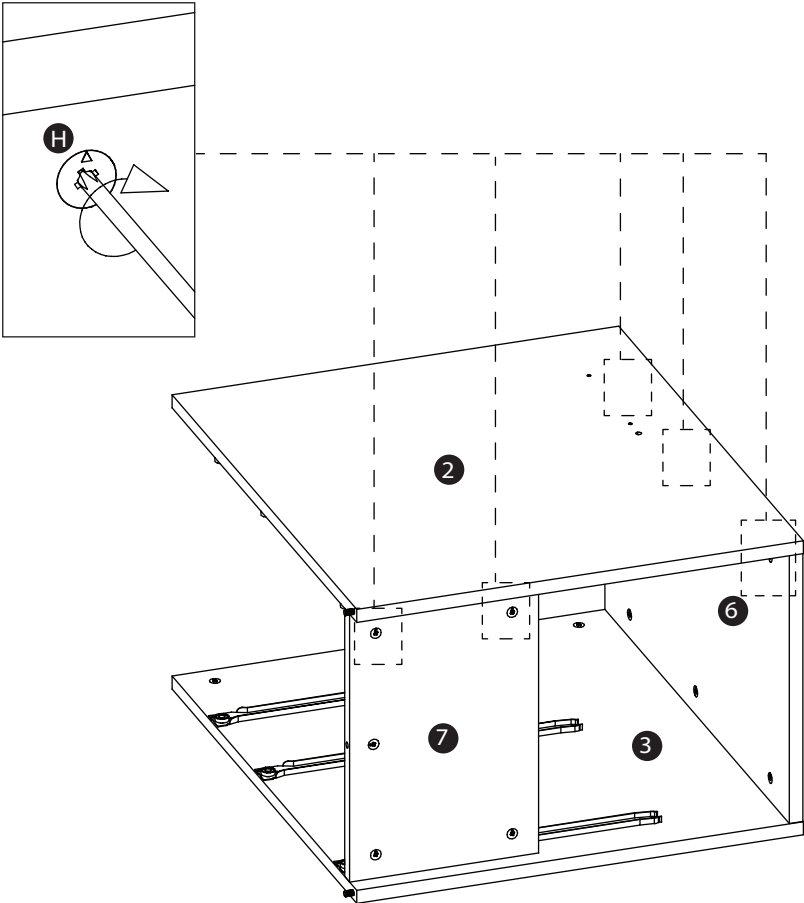
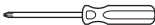

## Step 9

Parts, fittings and tools

3 6 7 2 8 H

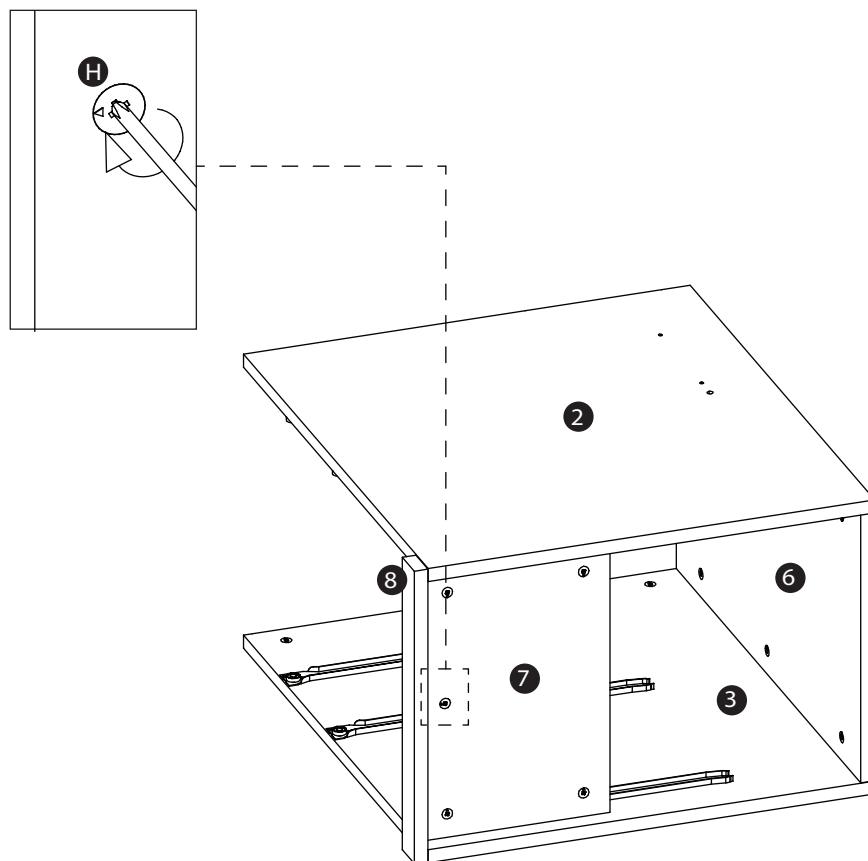
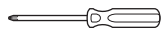

VERSION A => drawers on the right side of table

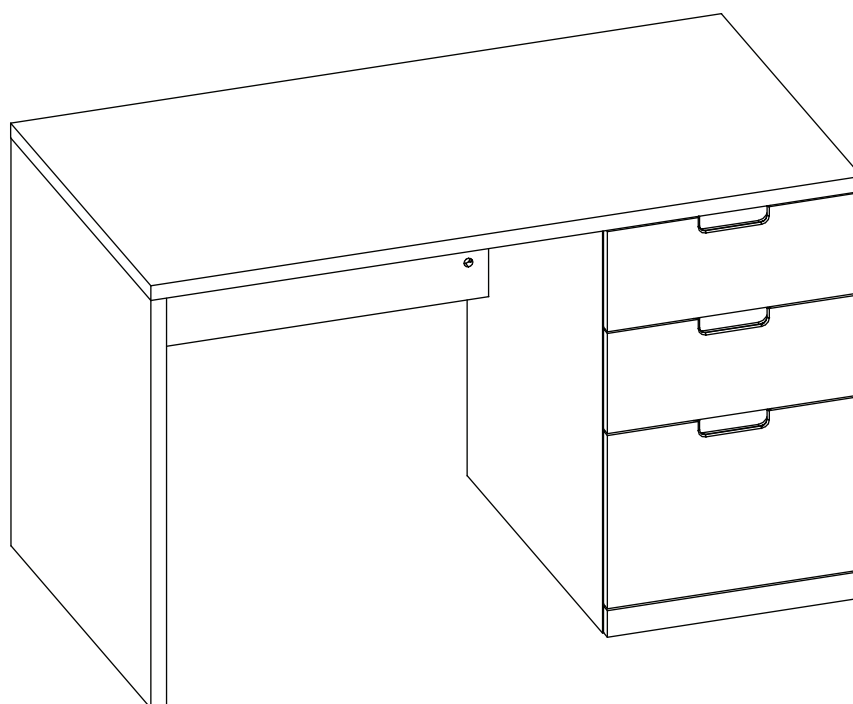

# Step 10

Parts, fittings and tools

- 1
- H
- G

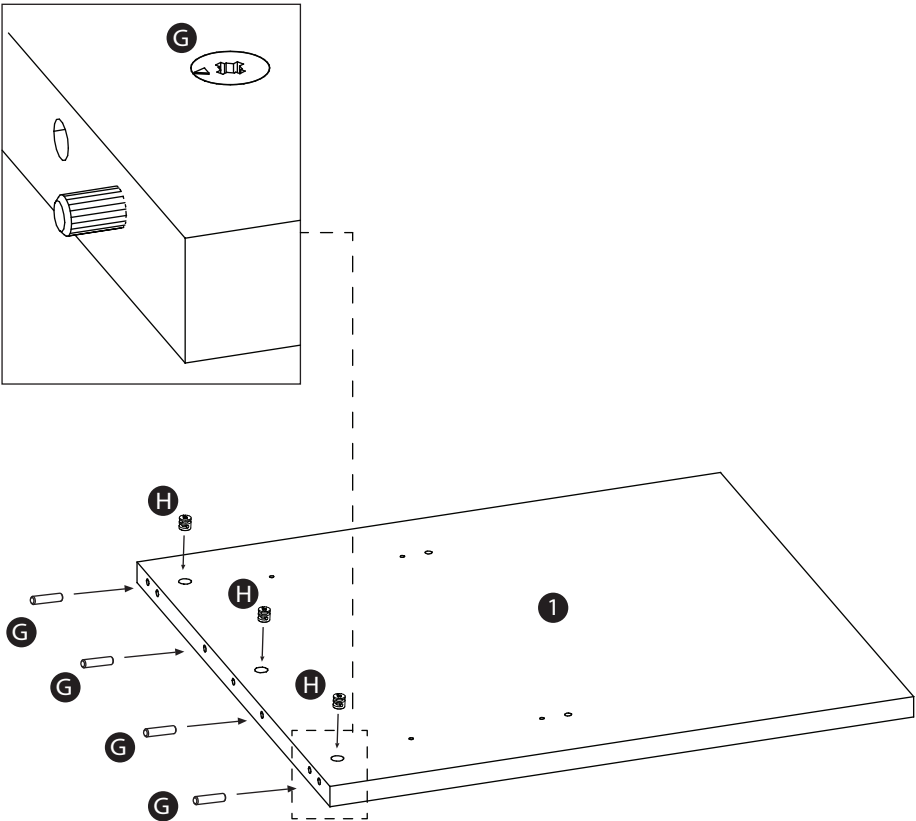
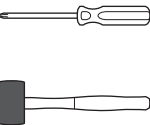

# Step 11

Parts, fittings and tools

- 1
- I

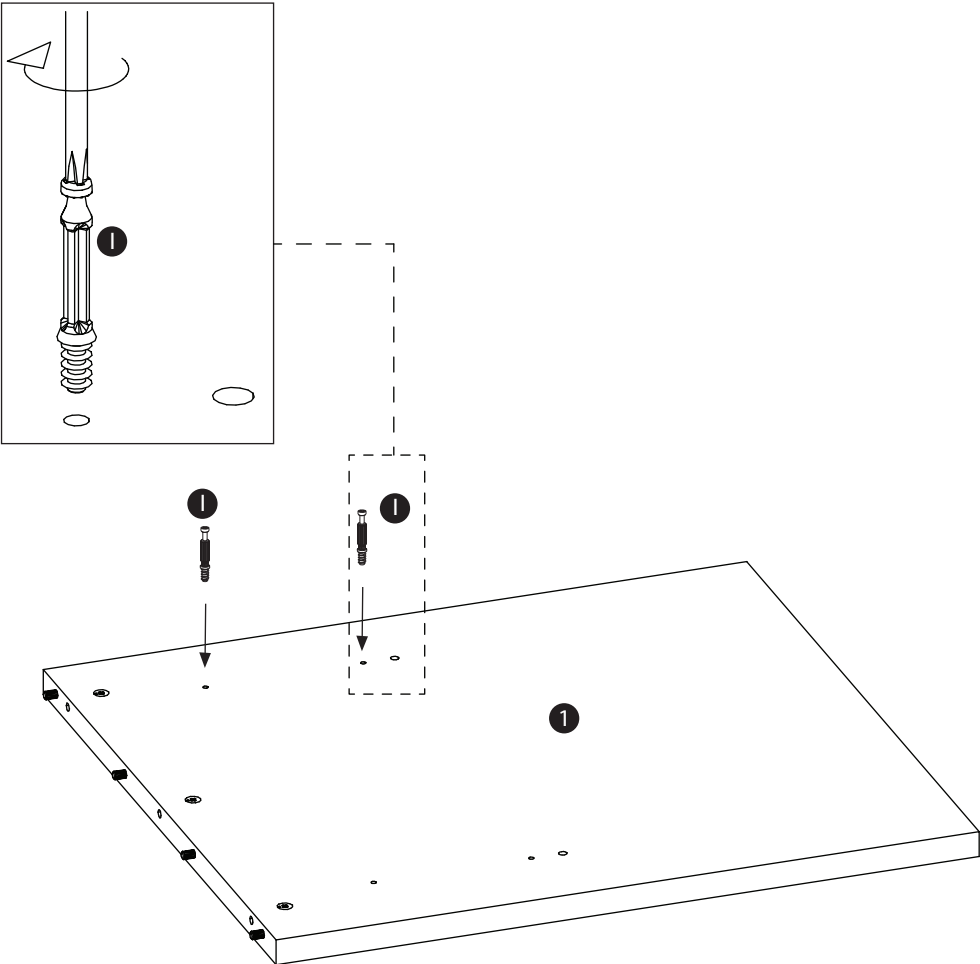
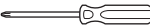

# Step 12

Parts, fittings and tools

5      G      H

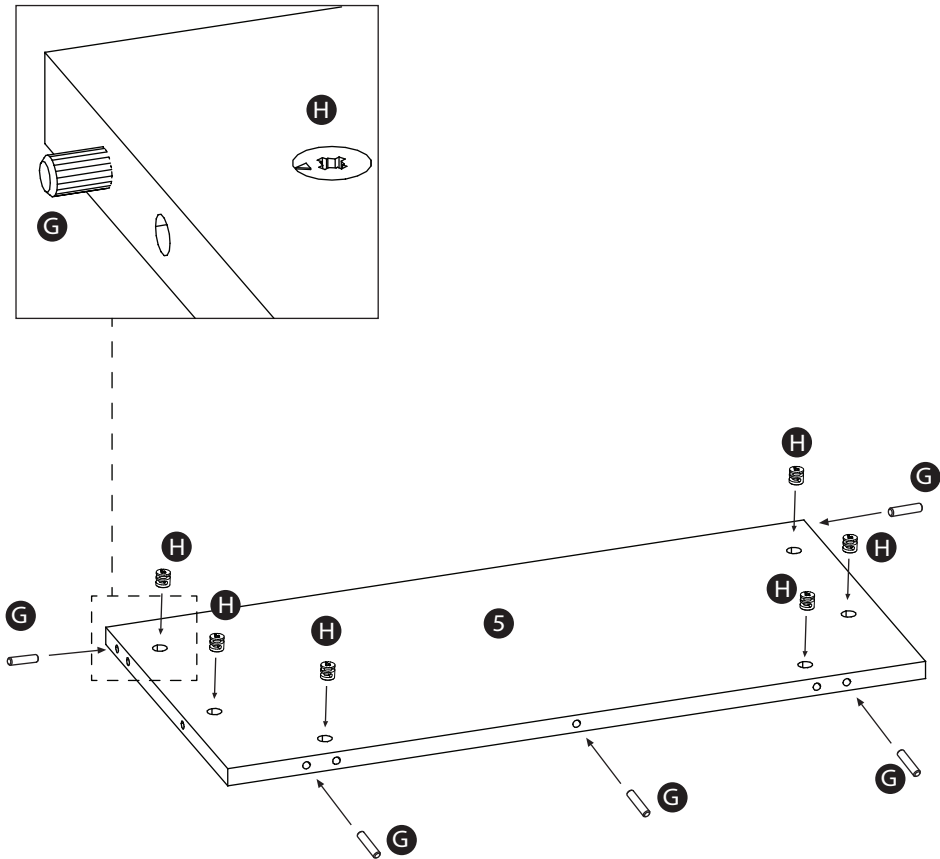
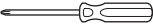

# Step 13

Parts, fittings and tools

1      5      H

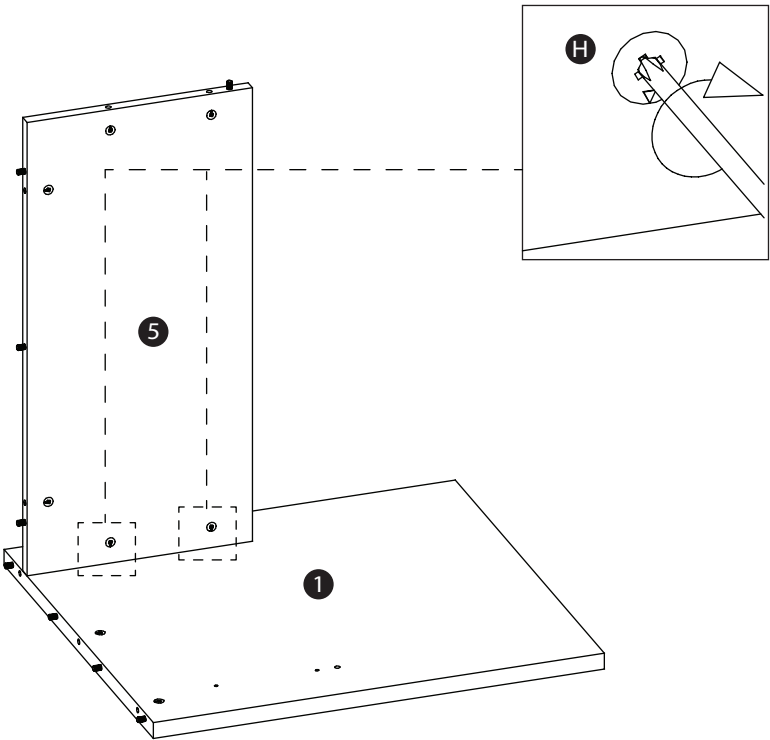
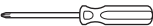

# Step 14

Parts, fittings and tools

- 3
- 6
- 7
- 2
- 8
- 1

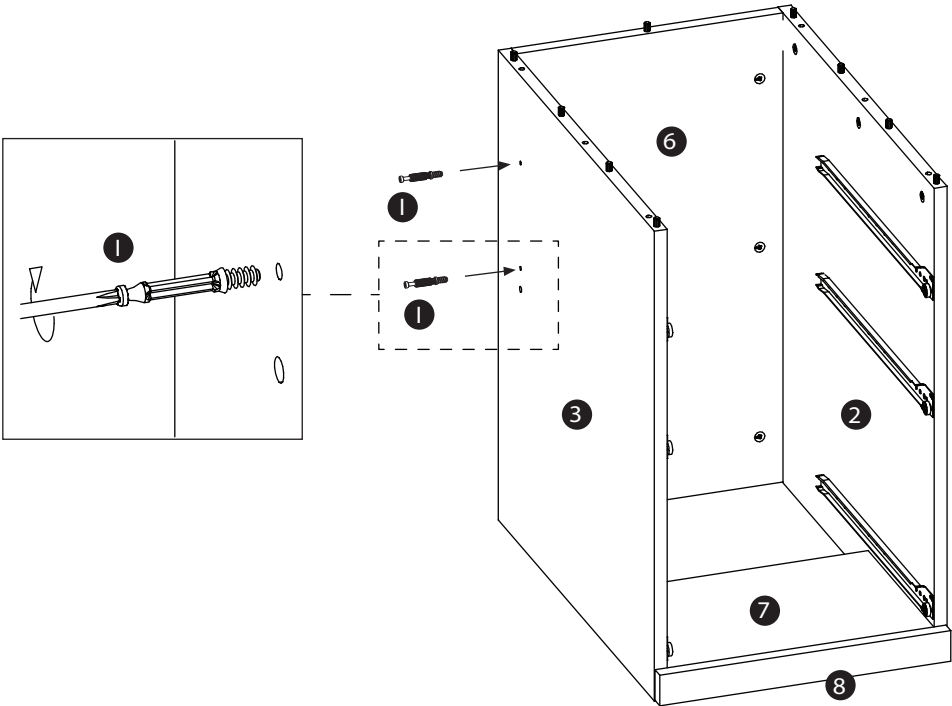
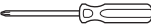

# Step 15

Parts, fittings and tools

- 1
- 5
- H

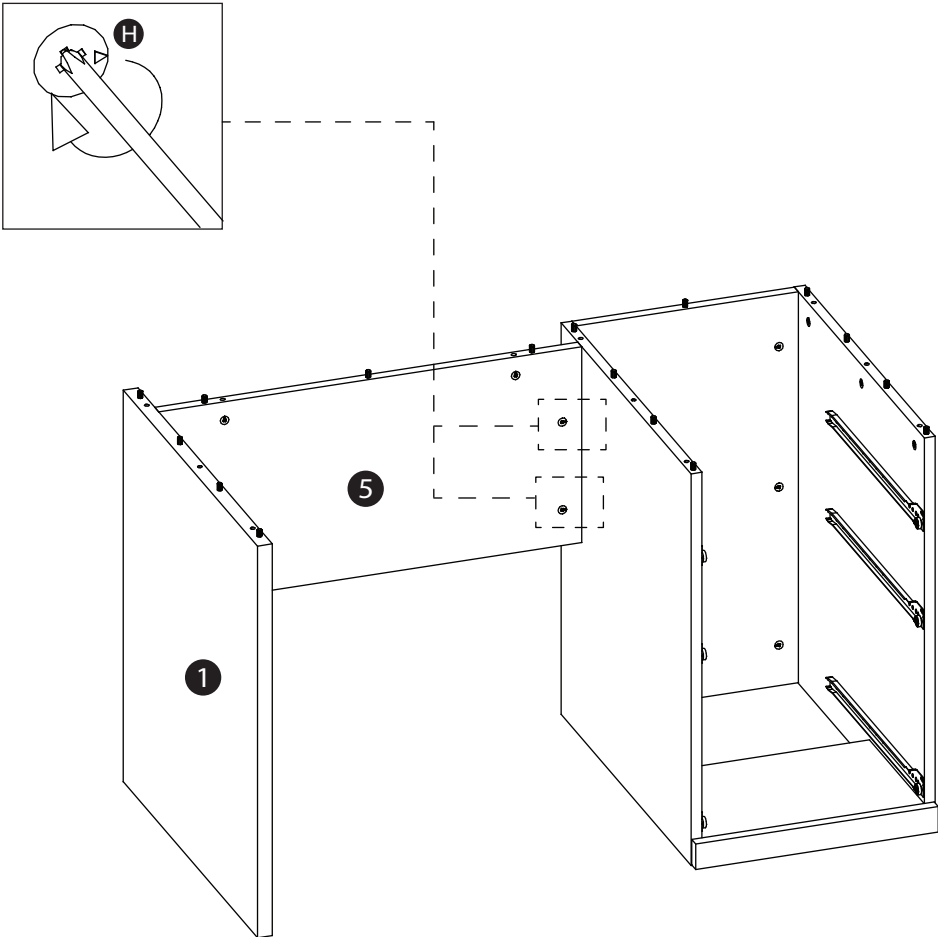
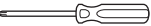

# Step 16

Parts, fittings and tools

4 I

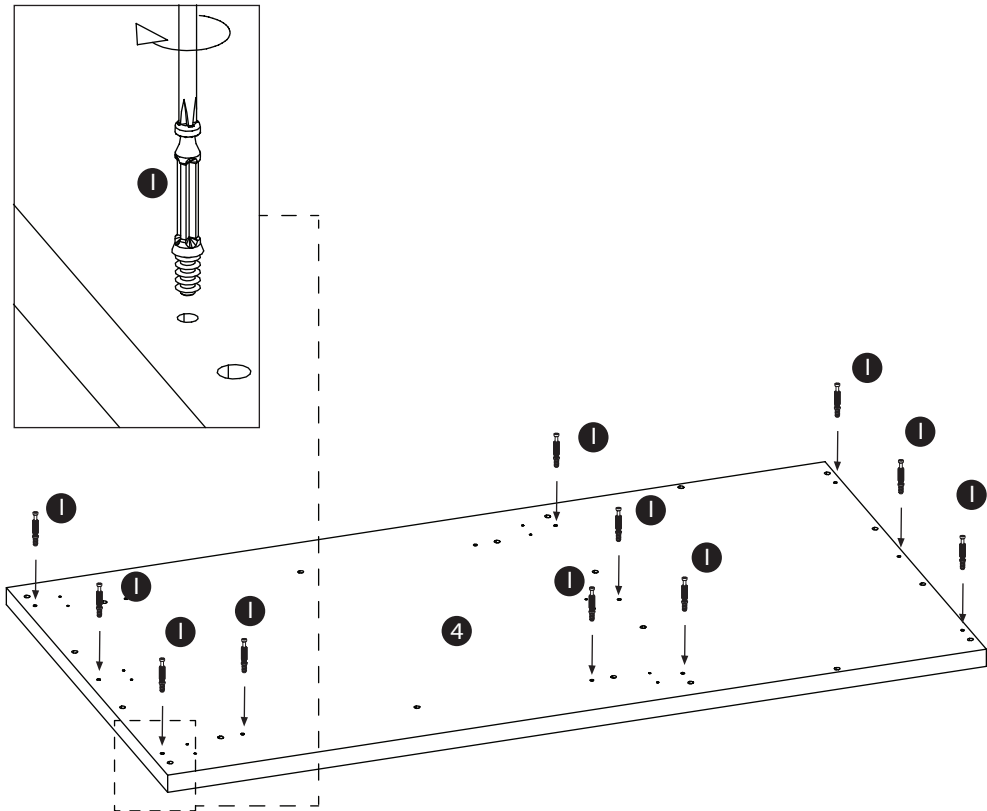
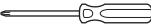

# Step 17

Parts, fittings and tools

4 H

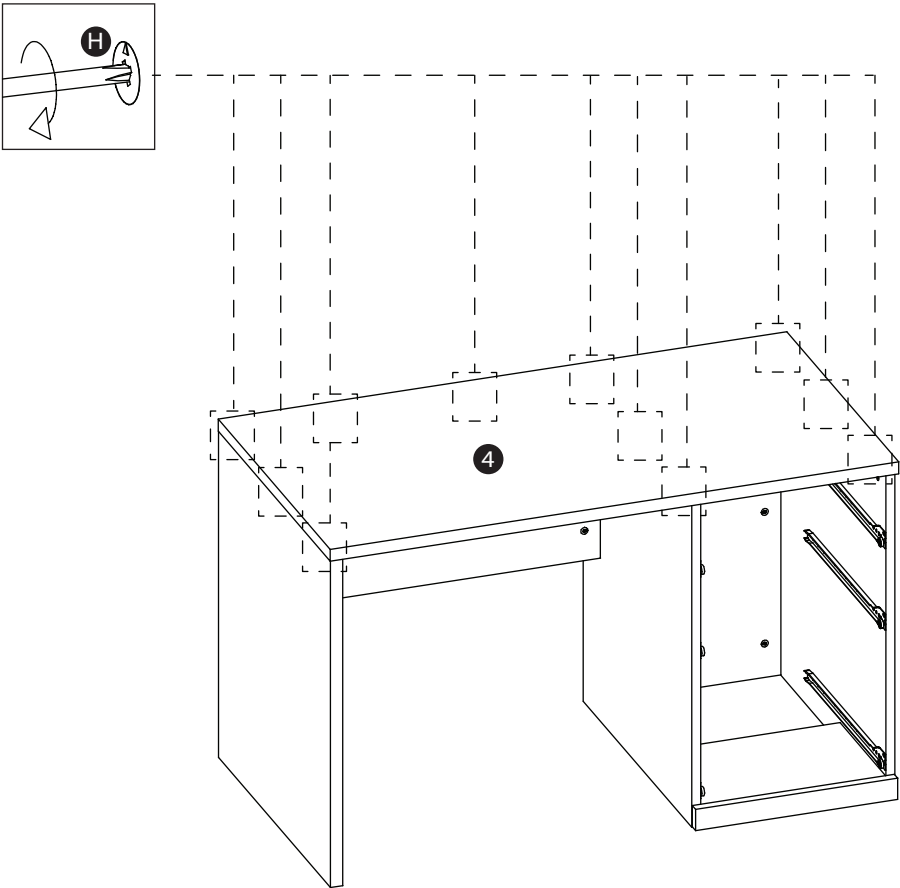
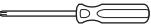

## Step 18

Parts, fittings and tools

1 4 5 H B

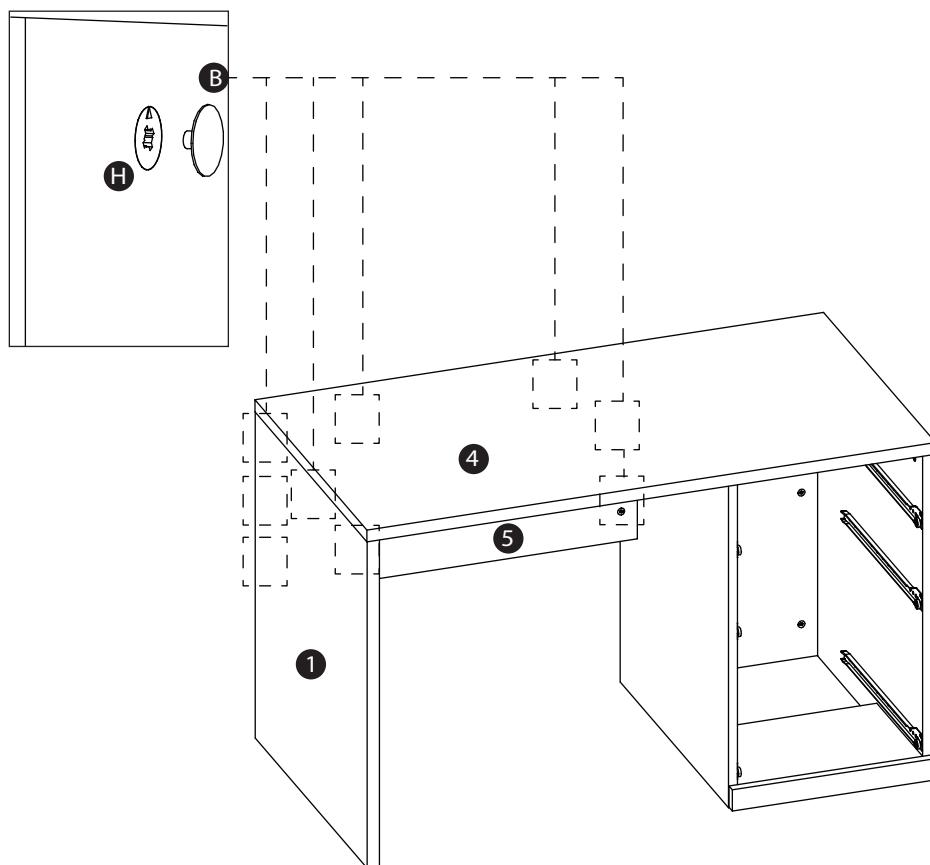
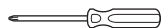

VERSION B => drawers on the left side of table

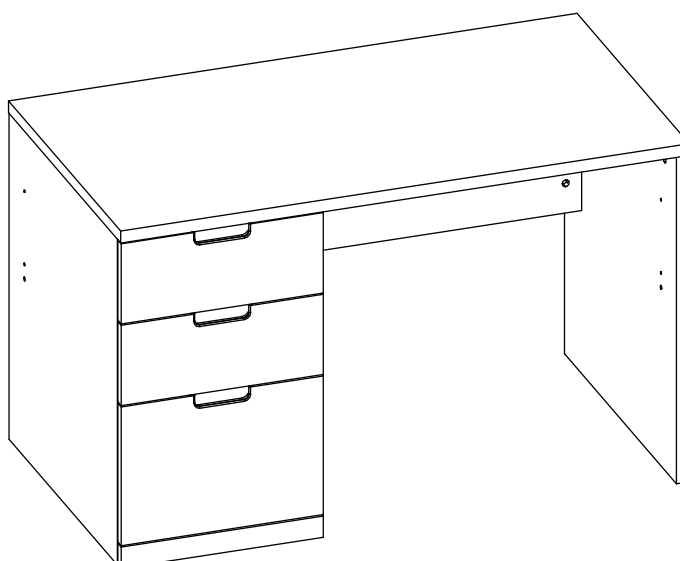

# Step 19

Parts, fittings and tools

1 H G

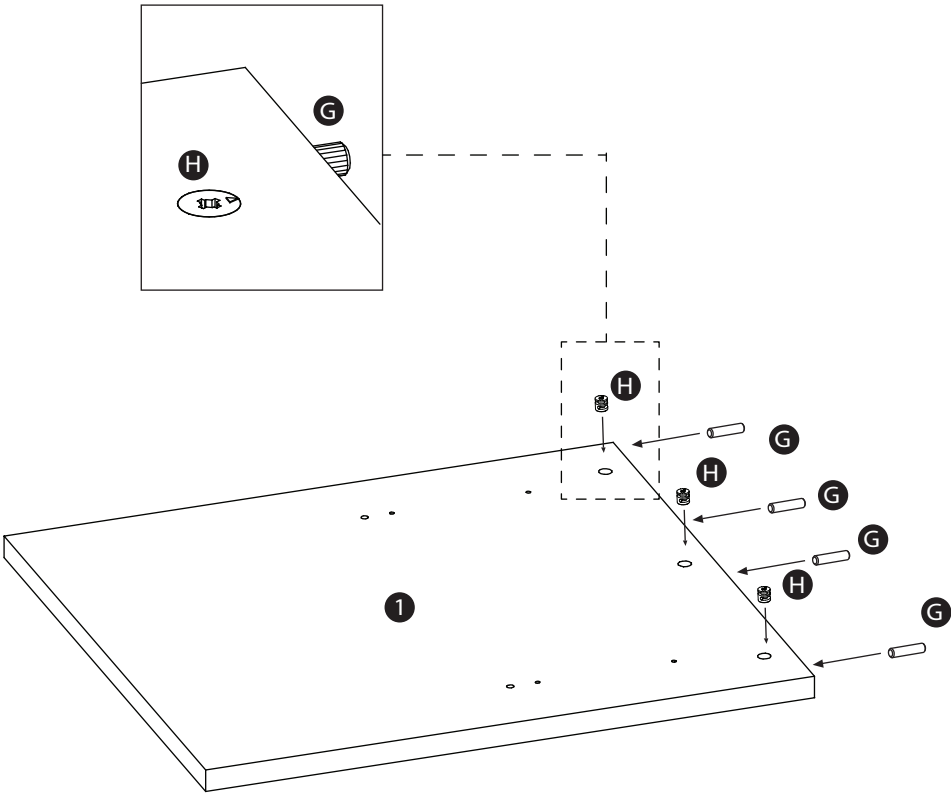
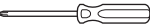

# Step 20

Parts, fittings and tools

1 I

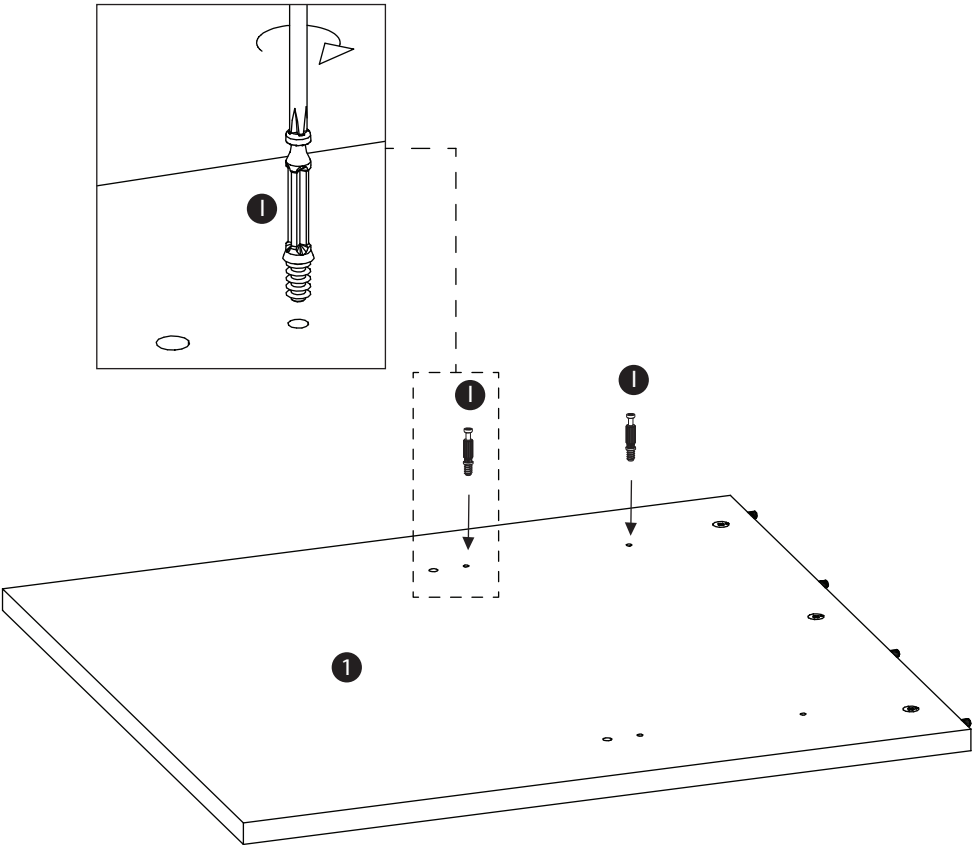
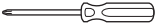



# Step 21

Parts, fittings and tools

- 5
- G
- H

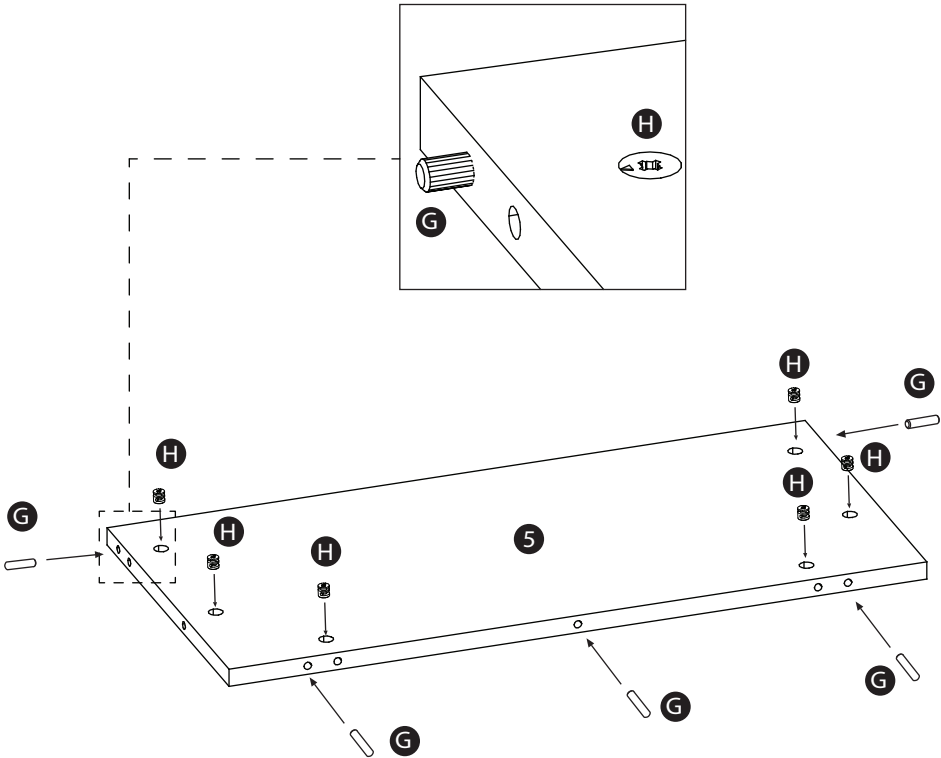
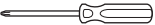

# Step 22

Parts, fittings and tools

- 1
- 5
- H

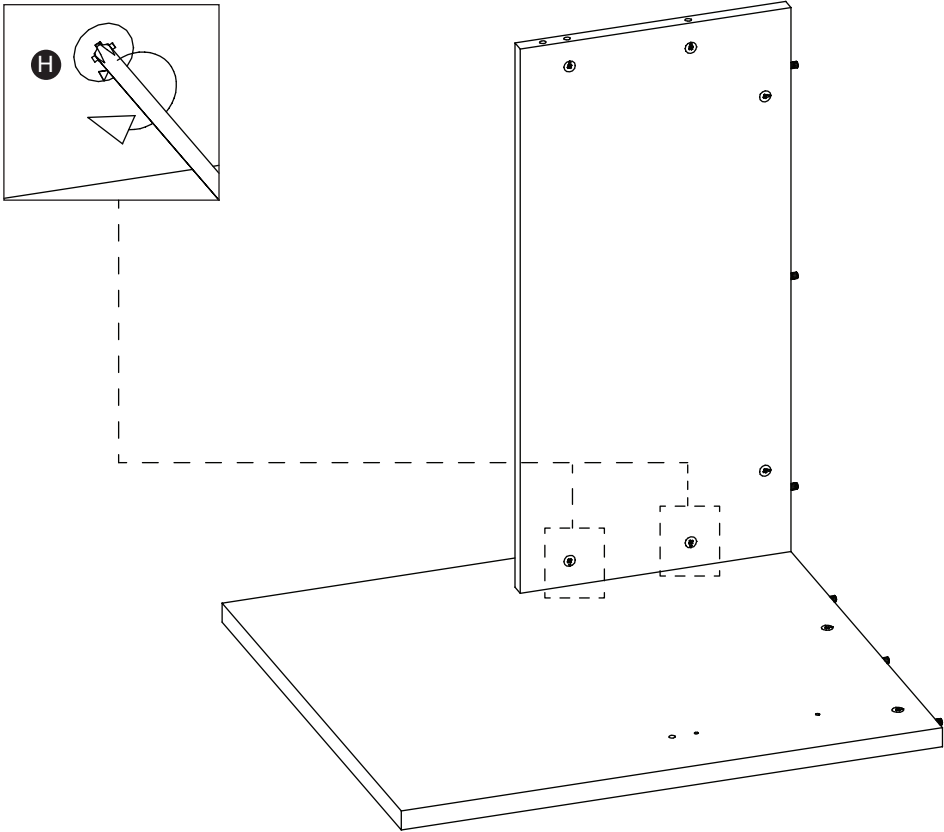
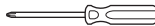

# Step 23

Parts, fittings and tools

- 2
- 3
- 6
- 7
- 8
- I

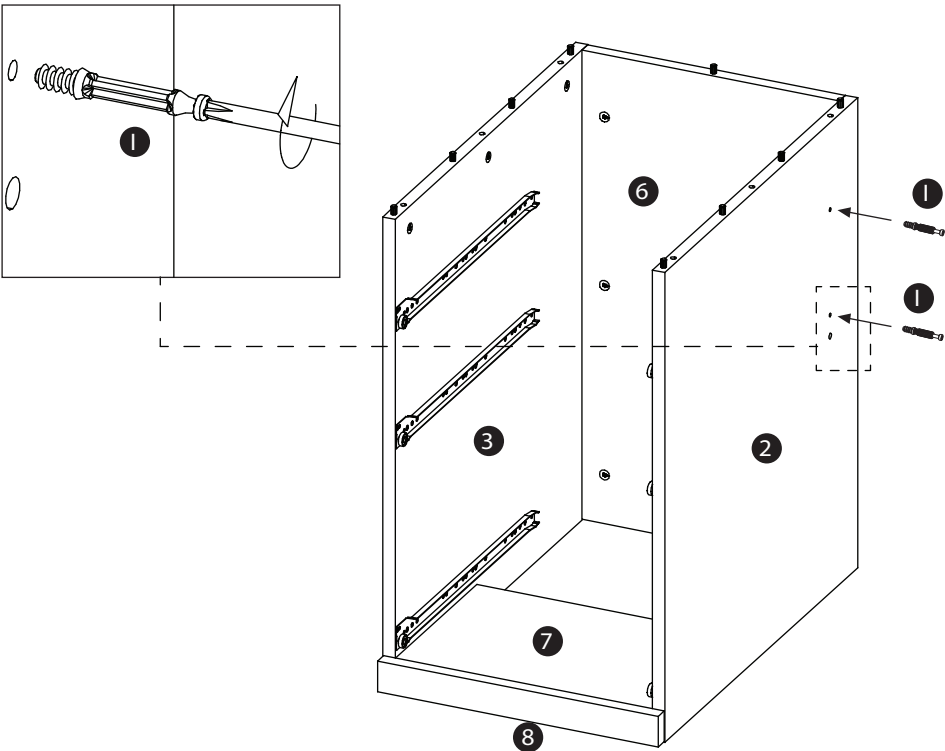
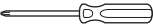

# Step 24

Parts, fittings and tools

- 1
- 5
- H

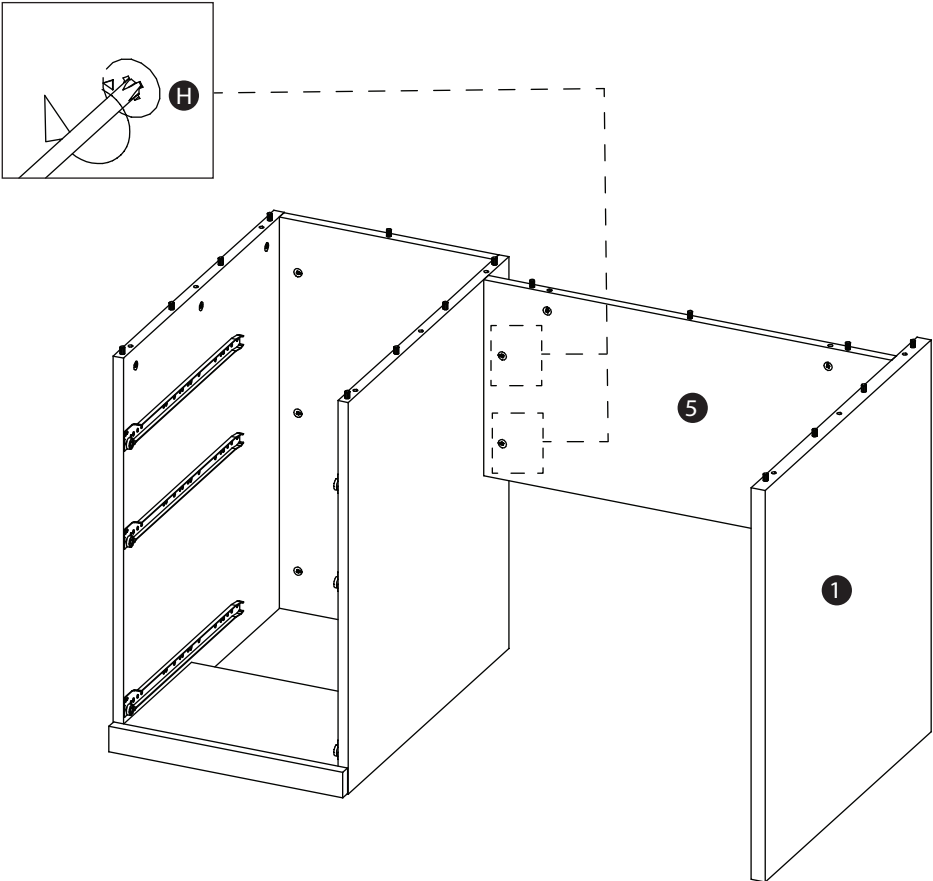
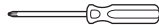

# Step 25

Parts, fittings and tools

- 4
- I

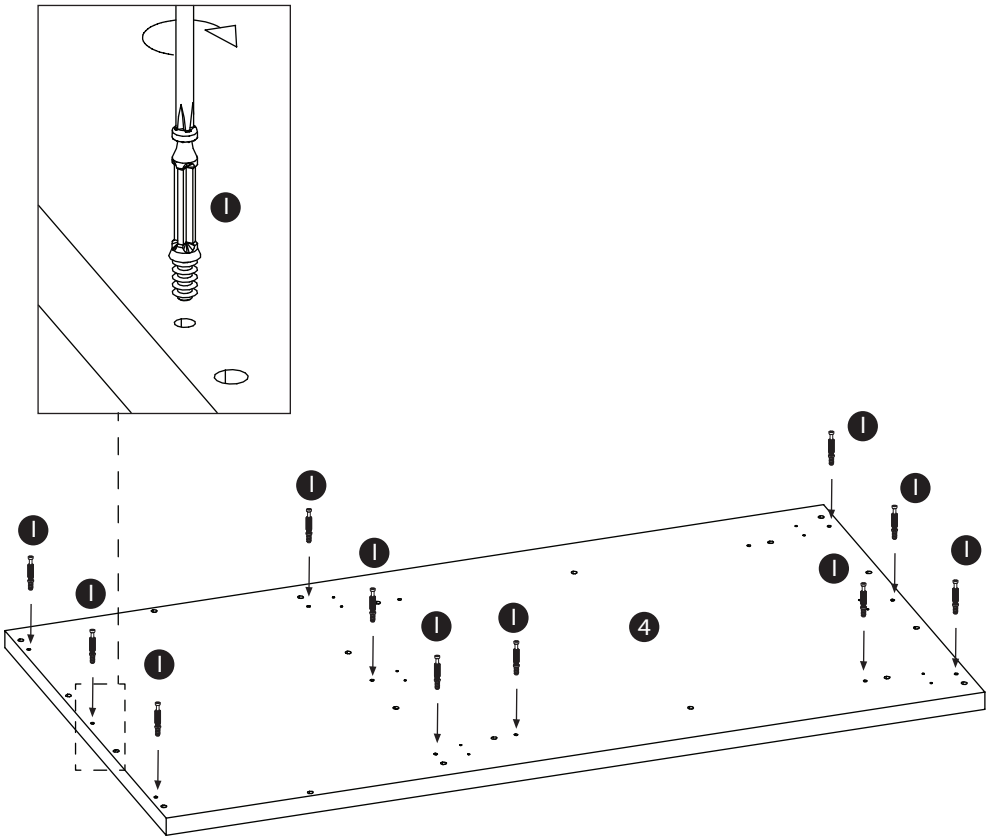
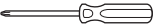

# Step 26

Parts, fittings and tools

- 4
- H

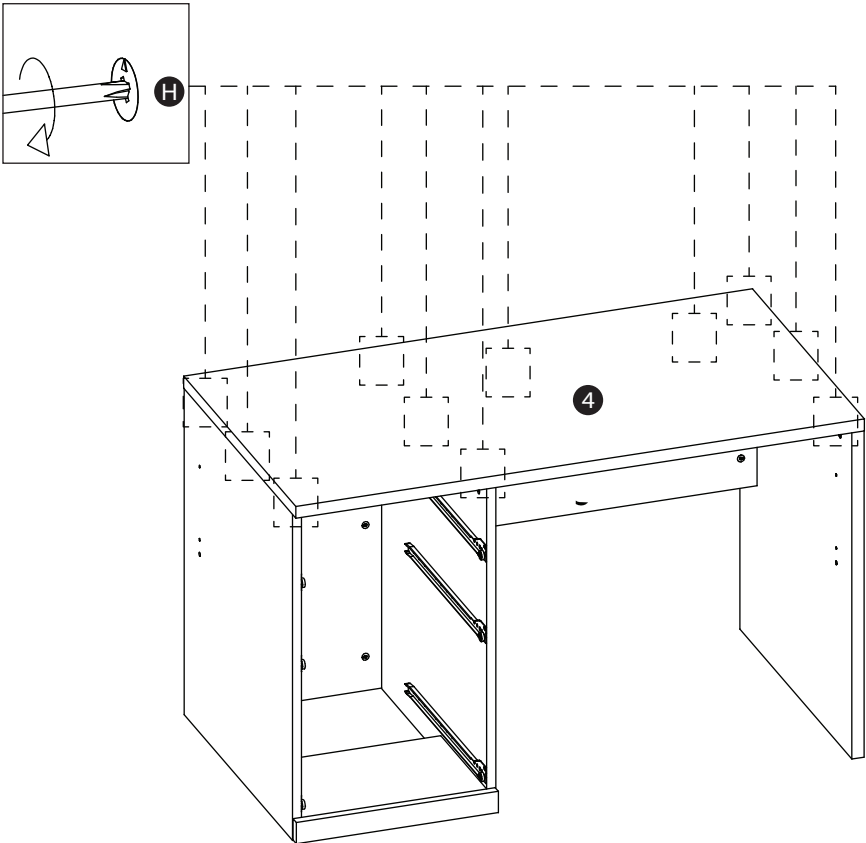
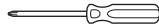

# Step 27

Parts, fittings and tools

- 1
- 2
- 4
- 5
- B
- H

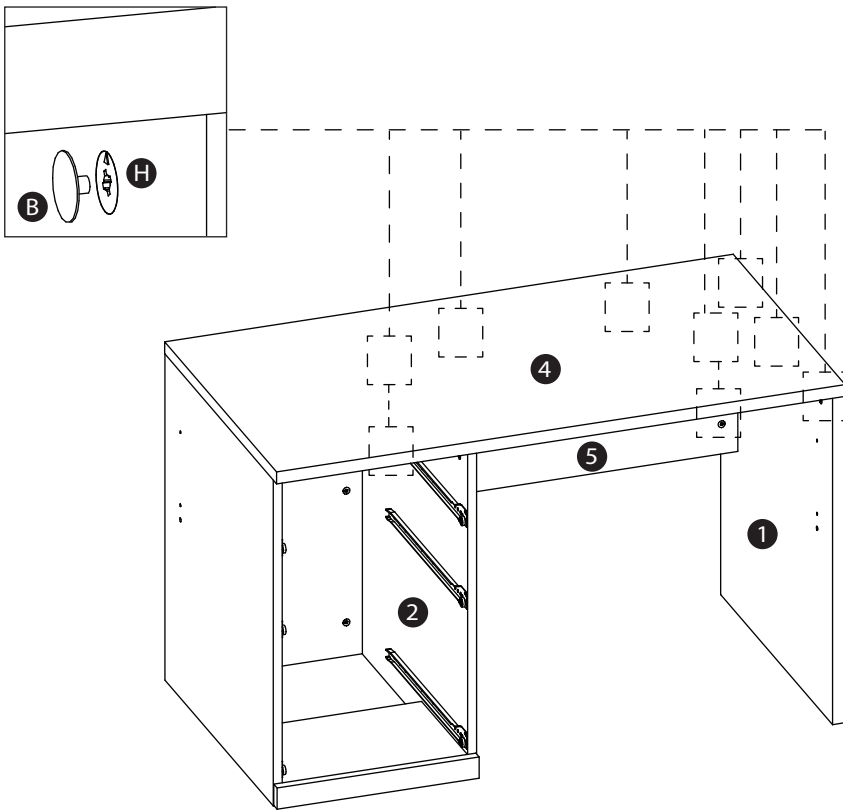

# Step 28

Parts, fittings and tools

- K
- L

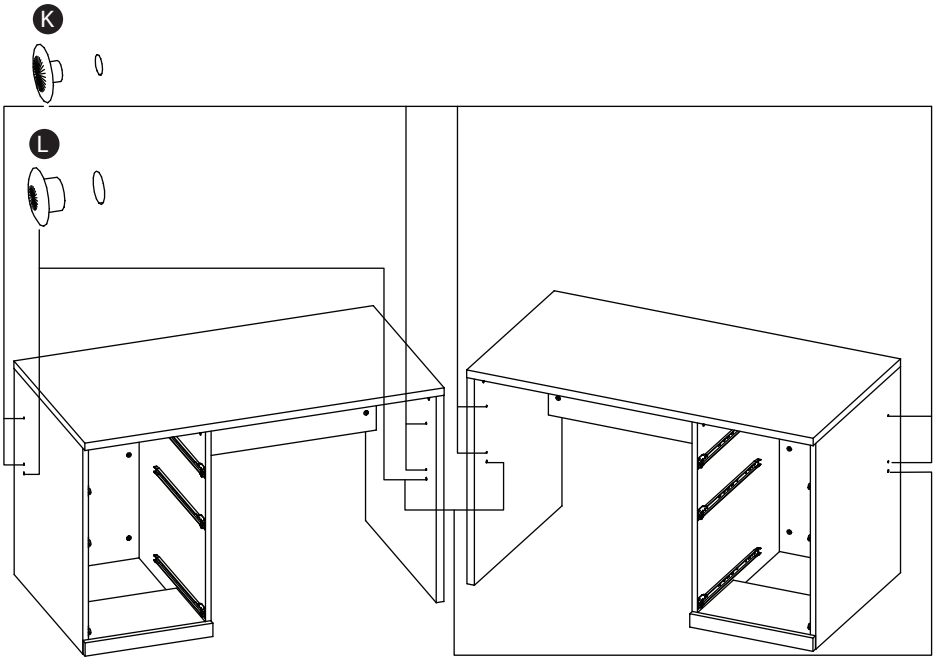

# Step 29

Parts, fittings and tools

- 9
- 14
- I

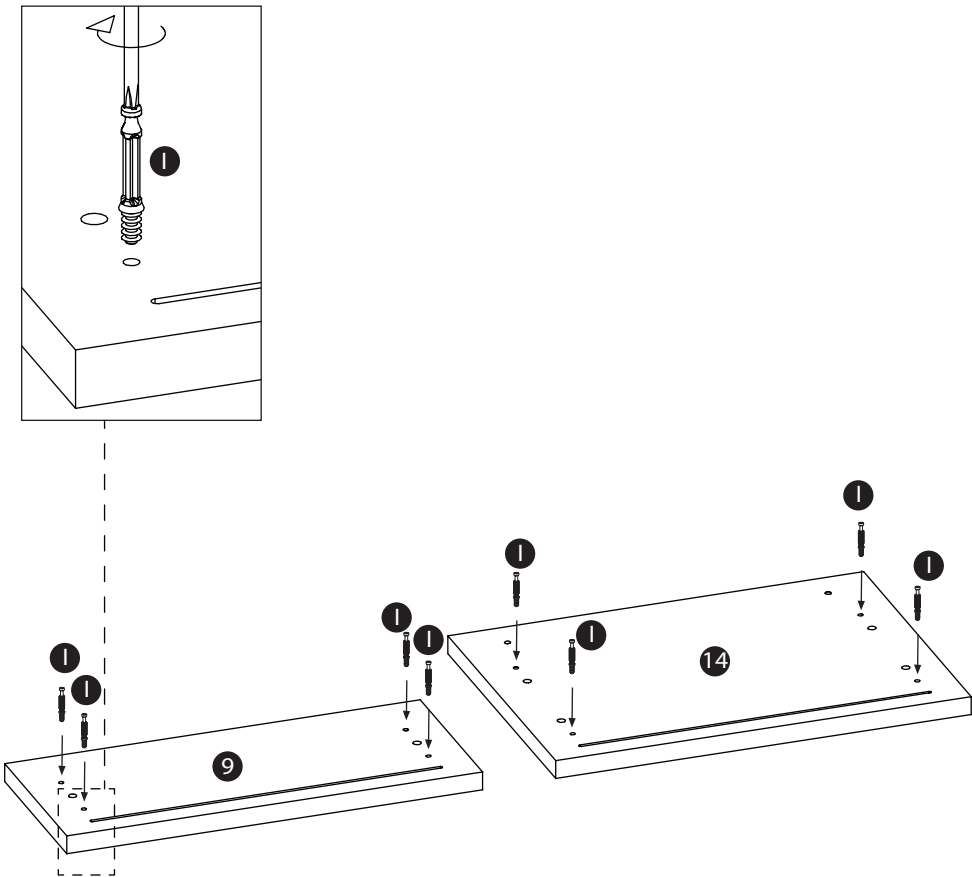
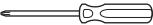

# Step 30

Parts, fittings and tools

- 10
- 11
- 12
- C

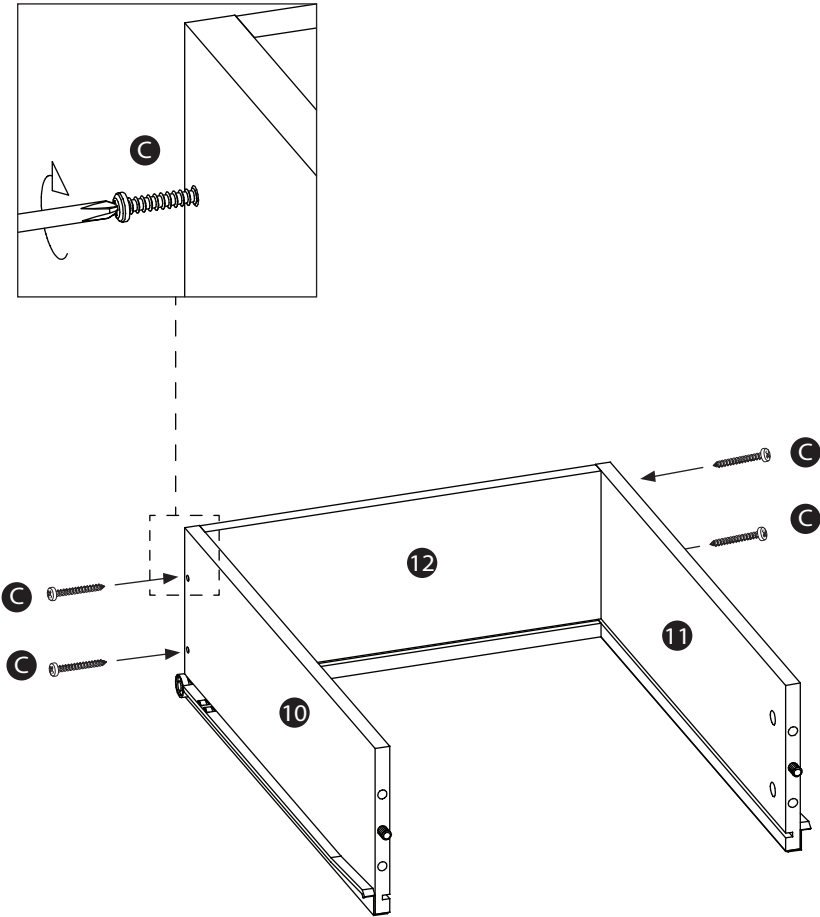
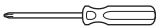

# Step 31

Parts, fittings and tools

- 10
- 11
- 12
- 13

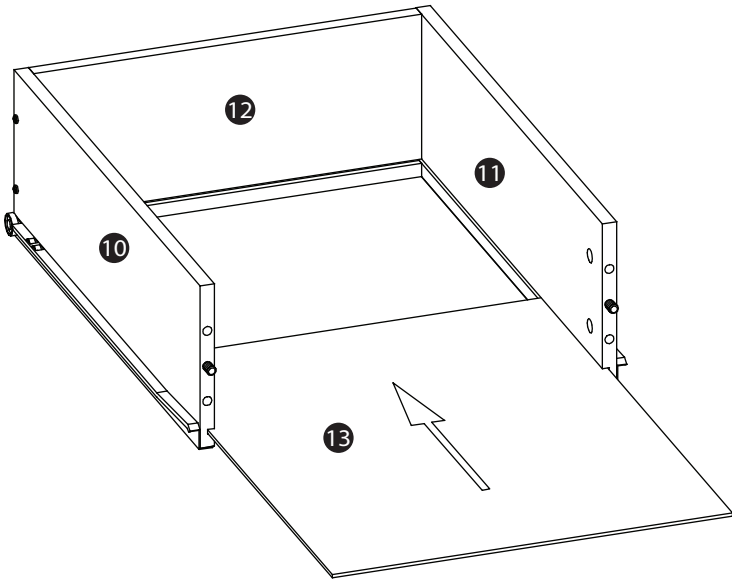

# Step 32

Parts, fittings and tools

- 9
- 10
- 11
- 12
- 13
- D

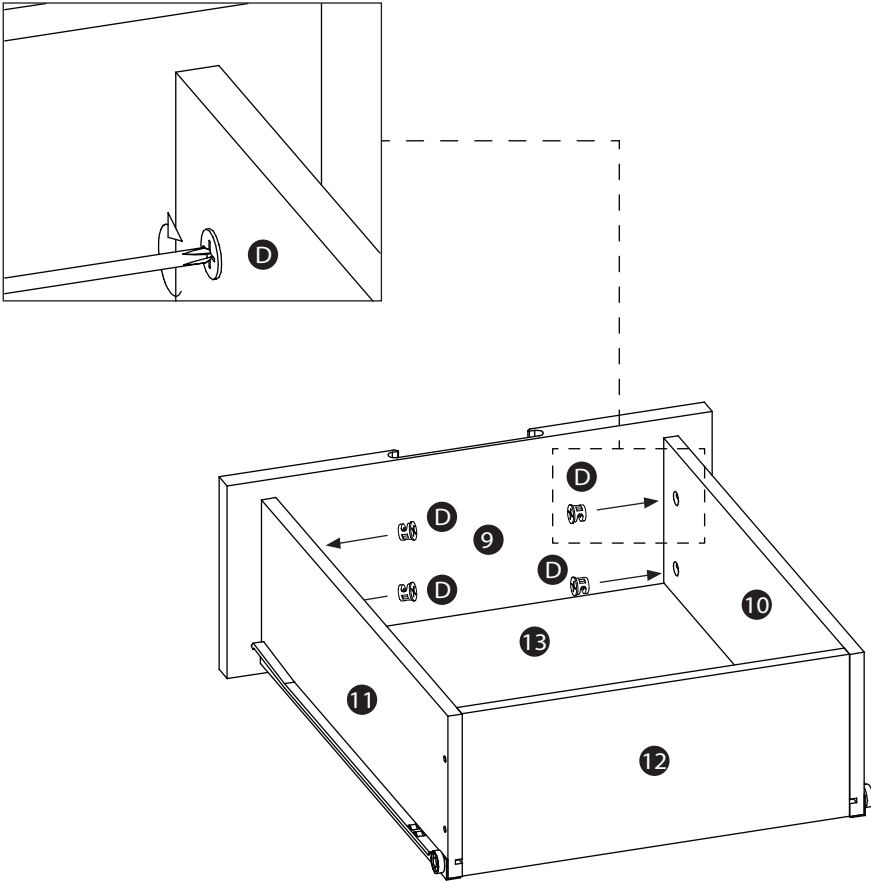
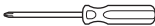

Step 33

Parts, fittings and tools

- 14
- 15
- 16
- D

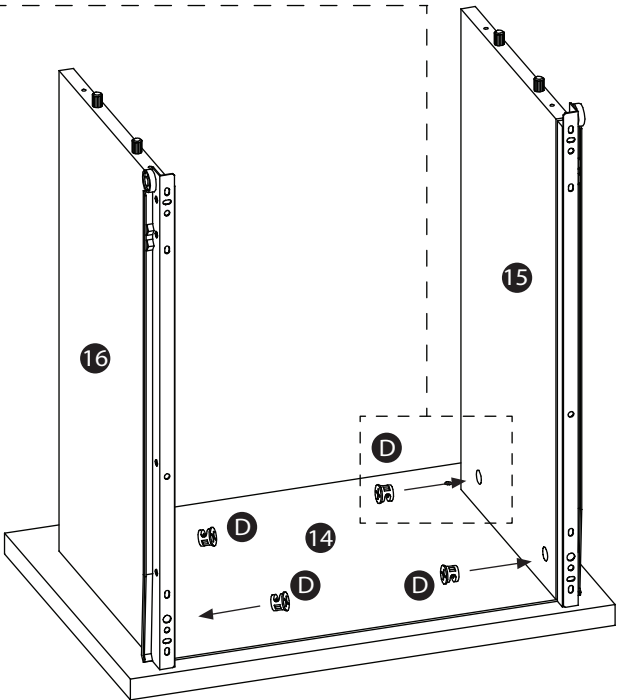
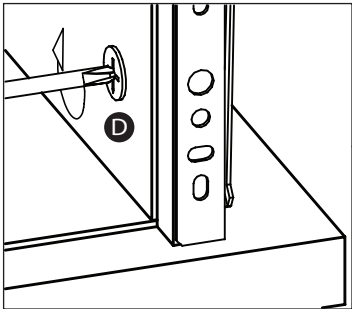
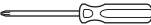

Step 34

Parts, fittings and tools

- 13
- 14
- 15
- 16
- A

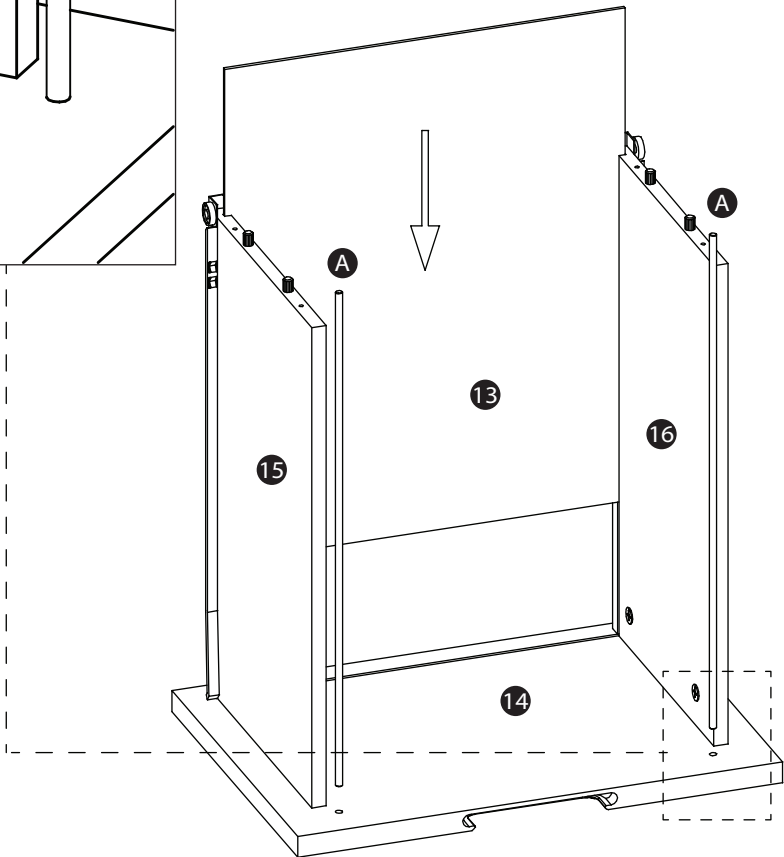
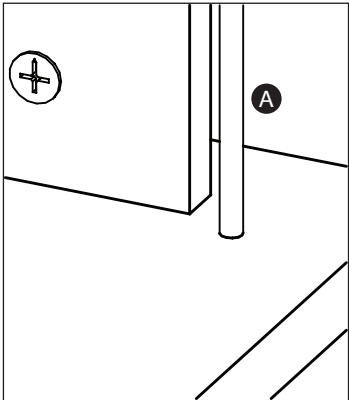

Step 35

Parts, fittings and tools

- 13 14 15 16 17 C

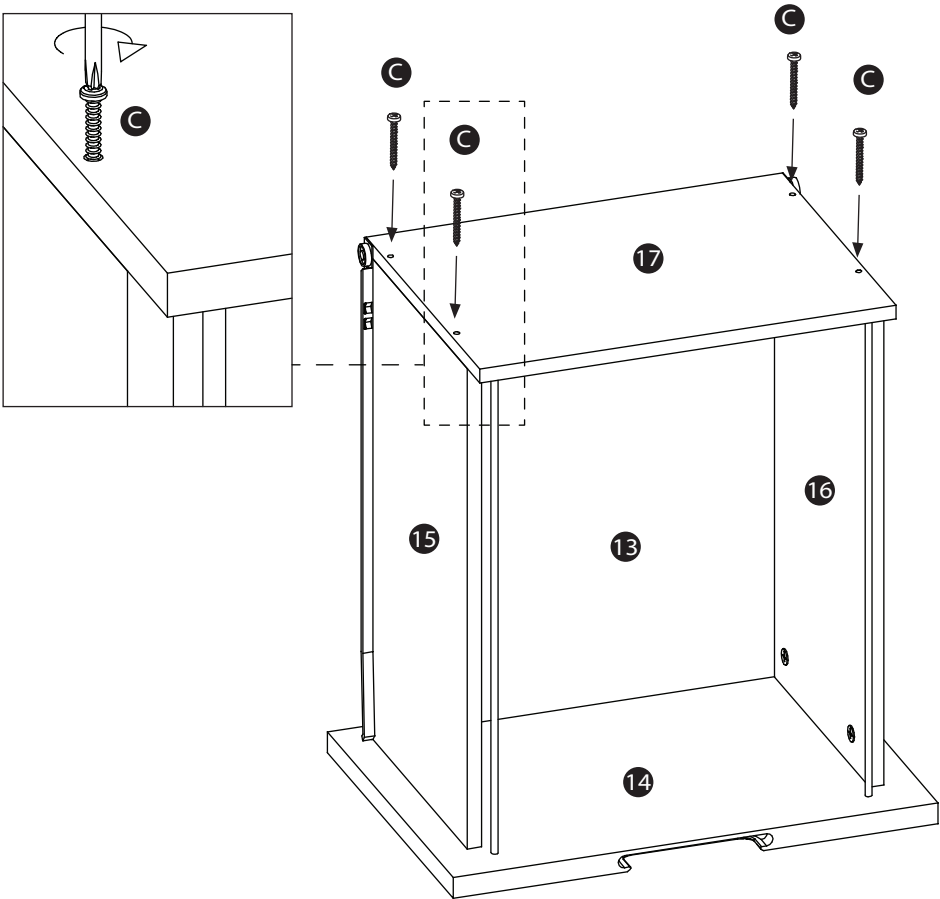
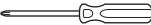

Step 36

Parts, fittings and tools

- 9 10 11 12 13 14  
15 16 17 E

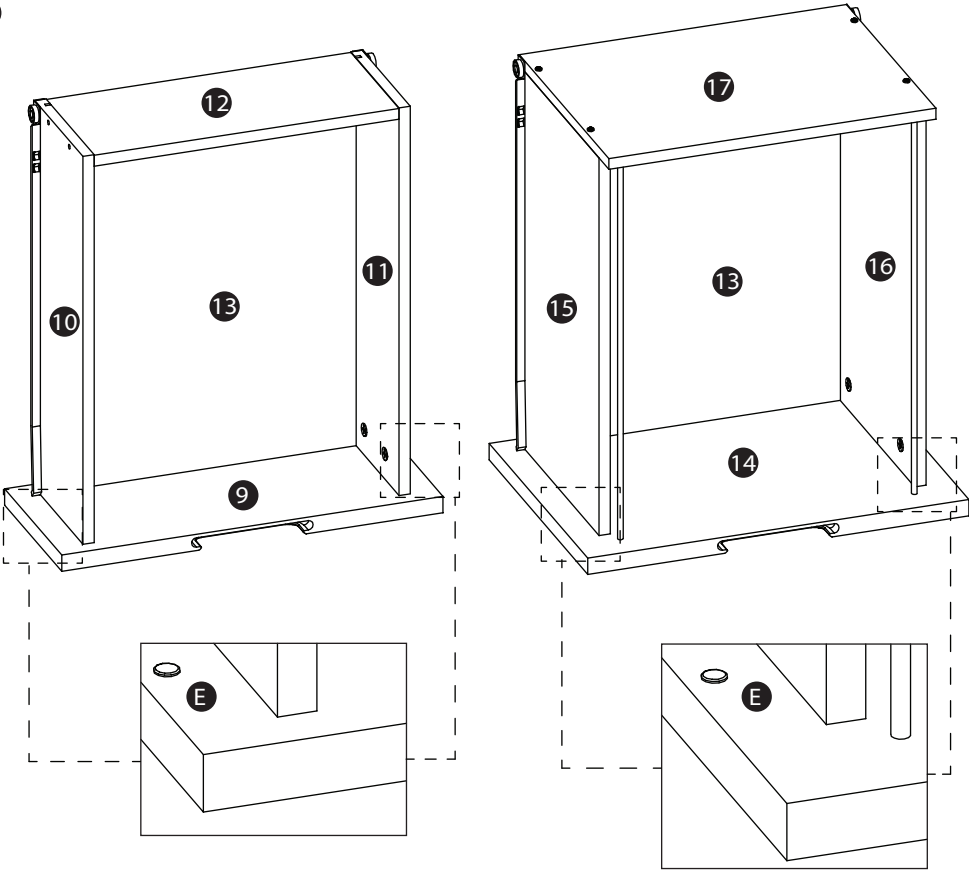



## Step 37

Parts, fittings and tools

VERSION A => drawers on the right side of table

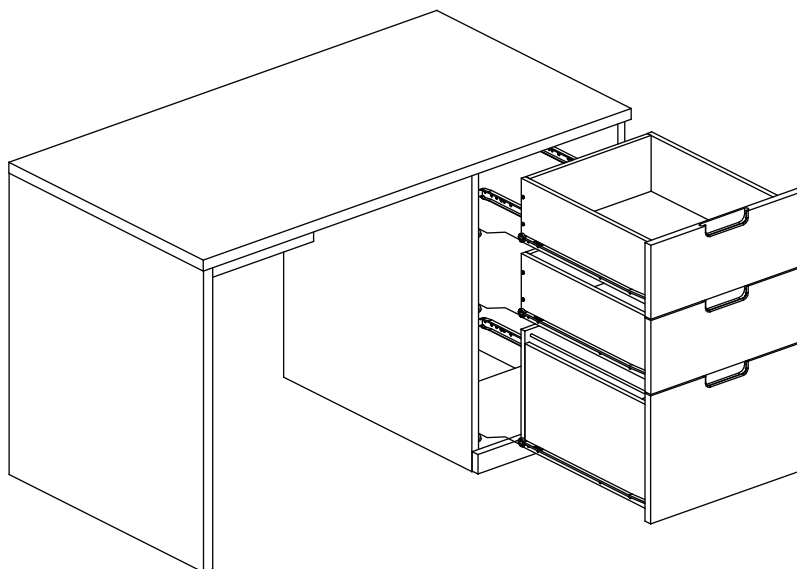

---

## Step 38

Parts, fittings and tools

VERSION B => drawers on the left side of table

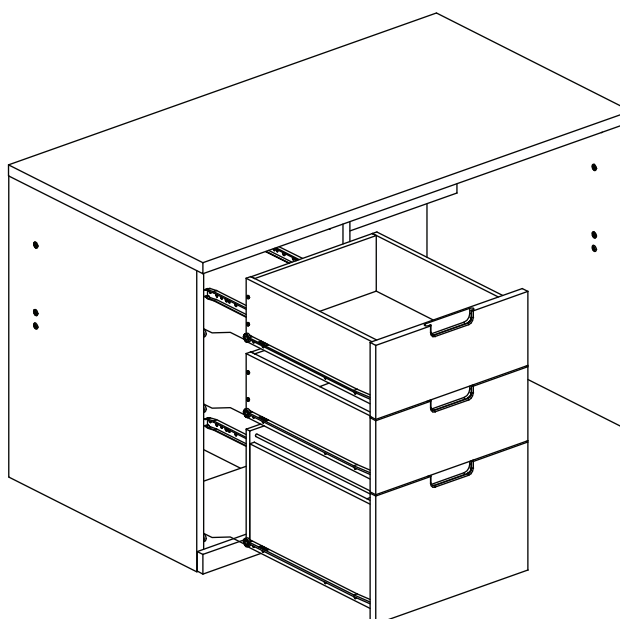

## Care guide

### Care and maintenance

#### Wood furniture

Wood displays different grain patterns depending on which way they are cut - for example, the 'medullary ray' which can appear on oak furniture is a mark of good quality timber - these are just characteristics of the natural beauty of the wood. Some furniture is also deliberately aged and rustic.

Wood veneers also allow a distinctive pattern to be created on some surfaces, such as tabletops and drawer fronts by the way slivers are arranged.

All timber and veneer surfaces will change colour and mellow over time. New furniture will initially vary in shade from items that have been previously purchased.

#### How to care for your wood furniture

Furniture with a hard lacquer, wax polish or painted surface should be dusted with a dry cloth.

Waxed furniture will need to be given a coat of beeswax a couple of times a year to help maintain its lustre. Spray polishes are best avoided as they contain silicones which may spoil the furniture's surface when building up over time.

Make sure all surfaces are protected from heat and liquids by mats and coasters. Wipe up spills immediately and ensure that a mat or pad is placed under paper if you are writing.

Our furniture will endure most temperatures in the home, but it is best to avoid placing furniture next to heat sources such as radiators or fires. Be particularly careful with solid wood as the lack of humidity caused by home heating can cause damage such as warping.

#### Safety instructions

Never drag furniture when moving it, always lift it.

Periodically check all fixings to ensure none have come loose and retighten when necessary.

Please take care when handling or moving the furniture as careless handling may cause damage or injury.

Furniture can be dangerous if incorrectly installed. Assembly should be carried out by a competent person. No liability will be accepted for damage or injury caused by incorrectly installed or assembled furniture.

Retain these instructions for future reference.