

Cleaning and care

- Unplug the appliance before cleaning.
- Slightly moisten a cloth and then wipe off the surfaces of the fan.
- In order to remove the dust from the protective grille use a vacuum cleaner or reverse grille assembly instructions.
- Never immerse the fan or fan motor in water or other liquid.

Compliance

This appliance complies with both the low voltage and electromagnetic compatibility directives. Its construction complies with current safety standards. We reserve the right to make technical changes without prior notice.

Disposal

The packaging of your new fan has a recycle mark on it. Please dispose of it as recycled paper or by using the "Dual System". This product should not be treated as normal household waste. It should be recycled, so please take it to an approved collection facility.



The symbol  on the product or on its packaging indicates that this product may not be treated as household waste. Instead it should be handed over to the applicable collection point for the recycling of electrical and electronic equipment. By ensuring this product is disposed of correctly, you will help prevent potential negative consequences for the environment and human health, which could otherwise be caused by inappropriate waste handling of this product. For more detailed information about the recycling of this product, please contact your local council office, your household waste disposal service or the store where you purchased the product.



Please recycle

Warning

1. Do not operate the fan with a damaged power cord or plug, after it malfunctions, has been dropped or damaged. If the power cord is damaged it must be returned to your nearest store to avoid a hazard.
2. Close supervision is necessary when this fan is used near children, the elderly and pets.
3. This appliance is not intended for use by persons (including children) with reduced physical, sensory or mental capabilities, or lack of experience and knowledge, unless they have been given supervision or instruction concerning use of the appliance by a person responsible for their safety. Children should be supervised to ensure that they do not play with the appliance.
4. Always turn the fan off after use, before cleaning, or moving location.
5. Do not touch the fan with hand or hard object before the fan stops moving.
6. Do not use outdoors.

UK guarantee

12 months warranty in respect of defects found to be due to faulty workmanship or material. Proof of purchase is required to validate the guarantee. This guarantee is no longer valid if the damage has been caused by fall, alteration or repair by any unauthorised persons or if the product has been resold. This guarantee in no way affects your statutory rights.

Technical data

Model No: DF-3032
Ref: IM/DF3032/1602/GU86AA
Power: 45 W
Voltage: 220-240V ~ 50Hz
Prod. Dims: 410 x 295 x 220 mm (H*L*D)
N.W: 2.79 kgs
G.W: 3.46 kgs



© 2016 Newton Stovold Associates Ltd
www.nsauk.com / GU8 6AA

NSA^{UK}
newton stovold associates

Desk Fan
12in / 30 cm
Model DF-3032



Instruction manual

(Rev Feb 2016)

- ❖ 3 speeds
- ❖ 5 Blades
- ❖ Rotary Controls
- ❖ Oscillation
- ❖ Tilt
- ❖ Carry Handle

Please keep safe for future reference

Desk Fan

Thank you for purchasing this desk fan. Please read the instructions and warnings carefully before use to ensure safe and satisfactory operation of this product. Please retain for future reference.

Appliance components

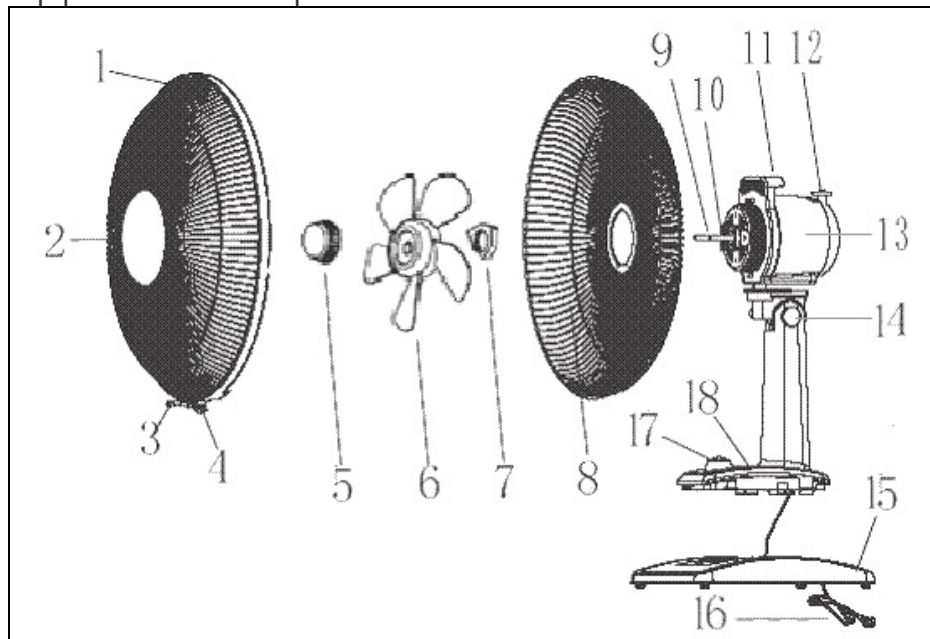

- | | | |
|------------------|-----------------------|---------------------|
| 1. Guard Ring | 7. Clamping Nut | 13. Motor Housing |
| 2. Front Grille | 8. Rear Grille | 14. Tilt Hinge |
| 3. Safety Screw | 9. Motor Shaft & Pin | 15. Base Plate |
| 4. Securing Clip | 10. Front Motor Cover | 16. Power Cord |
| 5. Blade Cap | 11. Carry Handle | 17. Rotary Controls |
| 6. Fan Blade | 12. Oscillation Knob | 18. Pillar Base |

Operation

- Control the angle of the airflow by firmly holding the pillar in one hand and pushing the fan grille back to tilt up or by pushing it forward to tilt down. Do not adjust the angle of the fan head when the fan is in motion.
- Plug into an electrical power socket and switch on.
- Choose the desired speed on the rotary control switch 1 = LOW, 2 = MED or 3 = HIGH. 0 = Off.
- To make the fan oscillate, push down on the oscillating knob (12) located on the top of the motor housing. To stop the fan from oscillating, pull up on the oscillating knob.

Assembly

- When all components are unwrapped, feed the power cord (16) through the base plate (15).
- Insert the pillar base (18) into the base plate (15) and click into place. Secure with the clips.
- Remove the blade cap (5) from the motor housing by turning clockwise and the clamping nut (7) by turning anti-clockwise.
- Install the rear grille (8) by positioning onto the three pins on the front motor cover (10).
- Secure in place with the clamping nut (7) by turning clockwise.
- Insert the blade (6) onto the motor shaft (9), matching the slot on the back of the blade with the shaft pin.
- Secure blade with blade cap (5), turning anti-clockwise to tighten.
- Test blade operation by rotating it with your hand. There should be no friction with the clamping nut or the rear grille. If blade does not rotate freely, repeat steps 4 to 8.
- Open the safety screw (3) and securing clip (4) on the guard ring (1). Keep screw safe.
- Hook front grille (2) onto back grille (8) from the top and click guard ring into place.
- Close securing clip, replace and tighten safety screw with screwdriver.

BS plug wiring

Wiring instructions: Should it be necessary to change the plug please note the wires in the mains lead are coloured in accordance with the following code:

BLUE – NEUTRAL :: BROWN - LIVE

As the colours of the wires in the mains lead of this appliance may not correspond with the coloured markings identifying the terminals in your plug, proceed as follows:

- The BLUE wire is the NEUTRAL and must be connected to the terminal which is marked with the letter N or coloured BLACK.
- The BROWN wire is the LIVE and must be connected to the terminal which is marked with the letter L or coloured RED.
- NEITHER WIRE must be connected to the terminal which is marked with the letter E, the symbol \oplus , coloured GREEN or GREEN/YELLOW.
- Always ensure that the cord grip is positioned and fastened correctly.

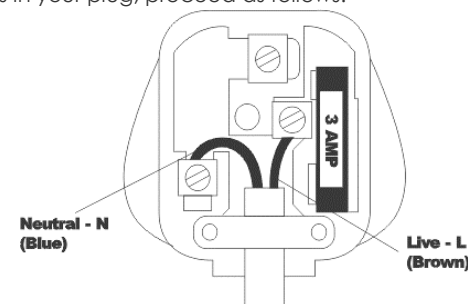

If a 13A (BS 1363) fused plug is used it must be fitted with a 3A (BS 1362) fuse. If in doubt consult a qualified electrician.