

John Lewis

Instruction Manual  
JLHDA918  
100cm Cooker hood

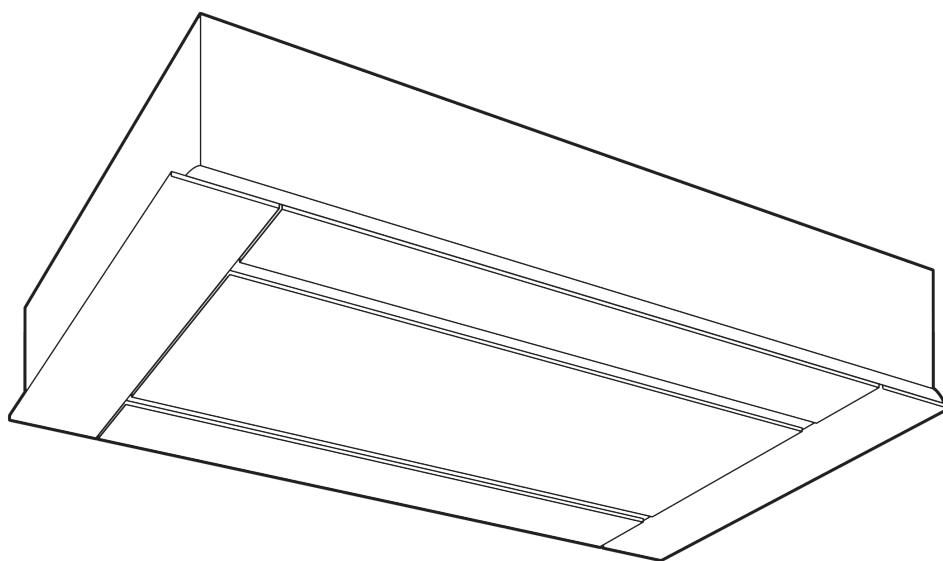

## Contents

3	<b>Introduction</b>
3	Safety is important
3	In the box
4	<b>Safety information</b>
4	Important safety information
4	Warnings
5	Cautions
5	Electrical information
6	<b>Remote control</b>
6	Programming the remote control
7	<b>LED indicators</b>
8	<b>Care and cleaning</b>
8	Cleaning and replacing aluminium filters
9	Cleaning and replacing charcoal filters
10	<b>Installation</b>
10	Installing the cooker hood
11	Fastening the motor to the ceiling (exhausting mode)
12	Fastening the motor to a false ceiling (exhausting mode)
13	Fastening the motor to the ceiling (filtering mode)
14	Fastening the motor separately from the cooker hood
15	<b>Guarantee</b>
15	Service
15	Disposal
16	<b>Troubleshooting</b>
16	<b>Replacing lights</b>
17	<b>Specifications</b>

## Introduction

Thank you for purchasing this JLHDA918 cooker hood.

Please read the instructions and warnings carefully before use to ensure safe and satisfactory operation of this appliance.

## Safety is important

To ensure your safety and the safety of others, please read the Safety information before you operate this product.

Keep this information in a safe place for future reference.

## In the box

You will find the following:

- Cooker hood
- Remote control
- Installation kit
- User guide

It is most important that this instruction leaflet be retained with the product for future reference. These warnings have been provided in the interest of safety. You **MUST** read them carefully before using the appliance. If you are unsure of the meanings of these warnings contact the John Lewis branch from which you purchased this appliance or our Technical Support centre on 0330 123 0106.



This symbol indicates that there are important operating and maintenance instructions in the literature accompanying this cooker hood.



This symbol indicates that dangerous voltages constituting a risk of electric shock are present within this cooker hood.

---

## Safety information

Take note of the following safety information:



**Warning!** To prevent fire or shock hazard, do not expose this cooker hood to rain or moisture.



**Warning!** Always remove the mains plug from the wall socket when not in use or before any service operation.



**Warning!** There are no user serviceable parts on this cooker hood. Refer servicing to qualified service personnel.

---

## Important safety information

It is most important that this instruction leaflet be retained with the product for future reference. Should you move house and leave the appliance, always ensure that this guide is supplied with the cooker hood in order that the new owner can get to know the functionality and the relevant warnings.

To avoid accidents to property or people it is important to follow the instructions given. Failure to do so removes any liability from John Lewis.

## Warnings

- Any installation work must be undertaken by a qualified electrician or competent person.
- This is a class I electrical appliance and must therefore be correctly earthed.
- If the cooker hood is installed for use above a gas appliance, the provision for ventilation must be in accordance with the Gas Safety Codes of Practice, the Gas Safety (Installation & Use) Regulations, the Building Regulations issued by the Department of the Environment and, where applicable, the Building Standards (Scotland) (Consolidated) Regulations issued by the Scottish Development Department.
- Do not install this cooker hood above a cooker with a high-level grill.
- Keep all packaging well away from children. There is risk of suffocation.
- If the room where the cooker hood is to be used contains a fuel burning appliance (such as a gas or oil fired central heating boiler), the boiler's flue must be a room sealed or balanced flue type. Alternatively, you should make sure that there is adequate air inlet into the room at all times so that fumes from the boiler are not drawn back into the room by the cooker hood.
- The ducting system for this cooker hood must not be connected to an existing ventilation system which is being used for any other purpose.
- Do not allow the power cord to be crushed or bent excessively.
- Do not let the power cord touch or pass over the hob or other hot surface.
- Do not hold the power cord or plug with wet hands.
- Never use a damaged power cord or plug, or a loose mains socket.

### Cautions

- This cooker hood is designed for domestic use only.
- This cooker hood is designed to be operated by adults. Children should not be allowed to tamper with the controls or play with the cooker hood.
- Do not leave frying pans unattended during use, as overheated fats and oils may catch fire.
- Do not do flambé cooking under this cooker hood.
- Do not leave naked flames under the cooker hood.
- Make sure foreign objects do not get into the cooker hood or obstruct the motor.
- Do not use the cooker hood without filters fitted.
- Clean or replace the filters regularly to avoid oil build up.
- Do not replace the filters while the cooker hood is operating.
- Replacement filters should be bought from authorised dealers.
- Do not use abrasive cleaning materials or scouring pads when cleaning the cooker hood.

### Electrical information



**Warning!** This cooker hood MUST BE EARTHED. When connecting the cooker hood to the electricity supply make sure that the mains socket is earthed.

---

Should the power supply cable need to be replaced, this must be carried out by an approved service engineer. John Lewis declines any liability should this safety measure not be observed.

Before switching on, make sure the electricity supply voltage is the same as that indicated on the cooker hood's rating plate. The cooker hood must be installed by a qualified electrician or competent person.



**Warning!** The appliance should not be connected to the electrical supply by means of an extension cable.

---

## Remote Control

The controls are:

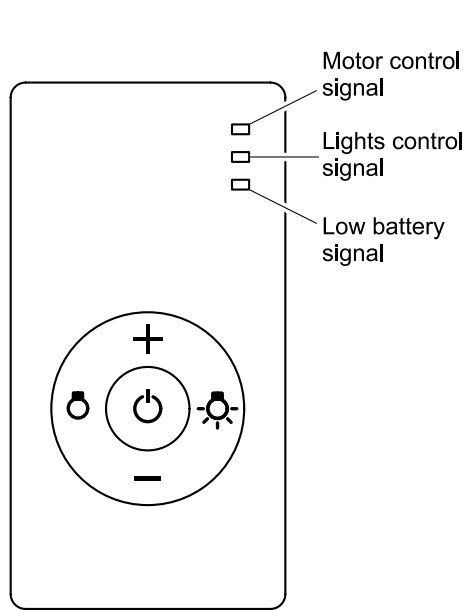

	<b>Light Off.</b> Press this button to switch off the LED lights in the cooker hood.
	<b>Light On.</b> Press this button to switch on the LED lights in the cooker hood.
	<b>Motor On/Off.</b> Press this button to switch the fan motor on or off.
	<b>Increase Fan Speed Setting.</b> Press this button to increase the fan speed.
	<b>Reduce Fan Speed Setting.</b> Press this button to reduce the fan speed.

For regular cooking we recommend using fan speed 1 or 2. If you are frying, or cooking dishes which generate a large amount of smoke or steam, we recommend using fan speed 3 or intensive speed.

## Programming the Remote Control

The remote control supplied with the cooker hood is already programmed for use with the cooker hood.

To programme another remote control:

1. Press and hold button **P** for 4 seconds until LED indicator 5 on the cooker hood lights up.
2. Press the Motor On/Off button (). LED indicator 5 will switch off.

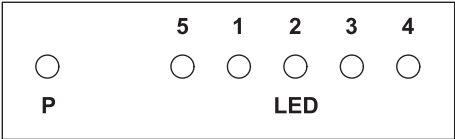

**LED Indicators**

The safety switch (**P**) is used to switch off the fan motor if the remote control is not available or has no power.

The LED indicators are:

5	See <b>Programming the Remote Control</b> .
1	<b>Speed Setting 1.</b>
2	<b>Speed Setting 2.</b> When the fan motor is switched on, it starts at speed setting 2.
3	<b>Speed Setting 3.</b>
4	<b>Intensive Speed.</b> This LED flashes when this speed setting is selected. The fan will operate at this speed for 5 minutes (or until you manually reduce the speed setting) and then return to speed setting 3.

If the LED indicators flash for 30 seconds when the cooker hood is switched off, the anti-grease filters need to be washed. To reset the counter after cleaning the filters, press and hold the **+** button on the remote control until the LED indicators stop flashing.

**Note:** See page 8 for more information on cleaning filters.

## Care and cleaning

**Note:** Switch off and unplug the cooker hood before carrying out any cleaning or maintenance work.

Clean the interior and exterior casing using a cloth with water and mild (neutral) detergent.

Do not use abrasive cleaning materials or scouring pads when cleaning the cooker hood as this may damage the stainless steel finish.

**A**

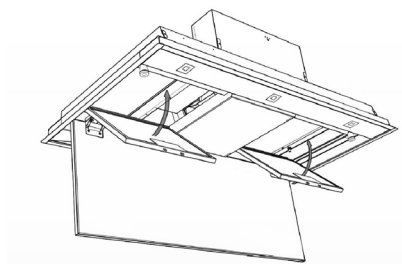

## Cleaning and replacing aluminium filters

This cooker hood is supplied with aluminium filters.

Aluminium filters are designed to absorb grease and dust during cooking. They should be removed and cleaned once a month, or more often if you regularly fry food. The grease collected by the filters can catch fire and it is extremely important to clean the filters regularly.

If all the fan speed indicator lights (see page 6) light up for 30 seconds when the cooker hood is switched off, this indicates that the aluminium filters require cleaning.

To clean the aluminium filter:

1. Open the bottom panel
2. Remove the anti-grease filters (A), holding them by the handles.
3. Wash the filter in warm soapy water or in a dishwasher and dry them.
4. Replace the filters in the cooker hood and make sure that they are locked in position.
5. Close the bottom panel.

The filters may discolour after a few washes. This is normal and does not mean that they have to be replaced.

Once the filters have been cleaned, with the cooker hood switched off hold down the **+** button until the ventilation indicator lights go out.



**A**

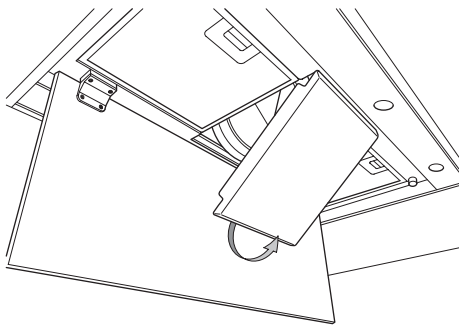

**B**

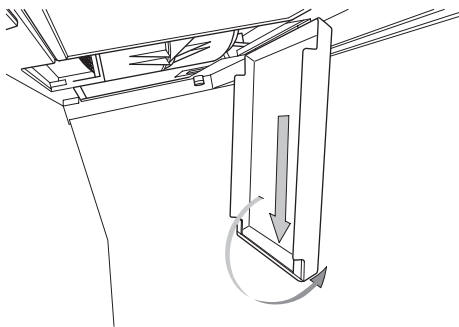

**C**

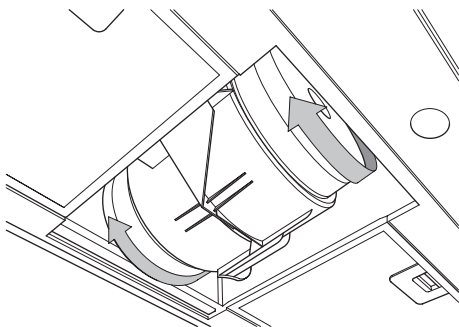

**D**

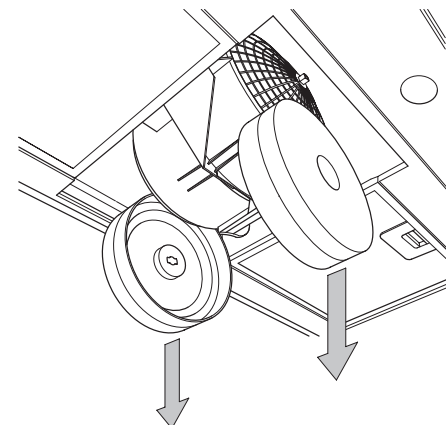

## Cleaning and replacing charcoal filters

**Note:** This cooker hood is not supplied with charcoal filters. Charcoal filters can be obtained from [www.johnlewis.com](http://www.johnlewis.com).

Charcoal filters are designed to absorb grease, dust and unwanted odours during cooking. They are only required when the cooker hood is used for recirculating (i.e. when it is not ducted out).

Non-regenerable charcoal filters must be replaced at least every four months.

To replace the charcoal filters:

1. Open the bottom panel.
2. Remove the engine protection panel (A and B).
3. Rotate the filters through 90° to unlock them (C).
4. Unhook the filters and remove them (D).
5. Insert the filters and turn them 90° until they are locked in position.
6. Slot the engine protection panel into position.
7. Close the bottom panel.

## Installation

### Notes:

- Before installing the cooker hood, make sure that the surface it is to be fixed to is strong enough to hold it.
- The cooker hood must not be mounted above a cooker fitted with a top radiant plate.
- If installing this cooker hood between adjoining wall cabinets, the wall cabinets must not overhang the hob.
- The ducting system for this cooker hood must not be connected to an existing ventilation system which is being used for any other purpose.
- The cooker hood must be installed by a qualified electrician or competent person according to all relevant regulations.

The cooker hood must be mounted so that the minimum distance between the filters and the gas hob is 65cm.

**Note:** If the mounting instructions for the gas hob give a minimum distance which is higher than 65cm, use the higher value as the minimum distance between the filters and the gas hob.

We recommend an air exhaust tube which is the same diameter as the air exhaust outlet hole. If a two-part air exhaust tube is used, the upper part must be placed outside the lower part.

Before beginning installation, remove the filters (see page 8). This will make the unit easier to handle during installation.

### Installing the cooker hood

The cooker hood is provided with all the necessary fastenings, suitable for most surfaces.

The cooker hood can be installed in either of the following modes:

- exhausting - fumes are extracted from the kitchen via a flue (not provided) joined to the exhaust flue connector,
- filtering - fumes are passed through charcoal filters to be purified and recycled in the kitchen.

The cooker hood can be installed with the motor fastened directly to either the:

- ceiling (if the distance between the ceiling and false ceiling is between 200mm and 270mm)
- false ceiling.

The motor can also be fastened up to 7m away from the cooker hood. If this is done, the cooker hood can only be used in exhausting mode and the air outlet must not be mounted on the side of the exhaust fitting when it is mounted vertically.

## Fastening the motor to the ceiling (exhausting mode)

1. Measure and mark the holes for the cooker hood (A).
  2. Measure the distance between the hood and the ceiling (B).
  3. Adjust the separators to the required height (B).
- Note:** Minimum height = 165mm; maximum height = 235mm.
4. Attach the separators to the ceiling (C).
  5. Lift the cooker hood into position (D).
  6. Insert the exhaust hose through the separator (E).
  7. Securely fasten the cooker hood to the separators (F).
  8. Connect the other end of the exhaust hose to the flue or outflow.
  9. Connect your cooker hood to the electrical supply.
  10. Insert the filters as described on page 8.

Your cooker hood is now ready for use.

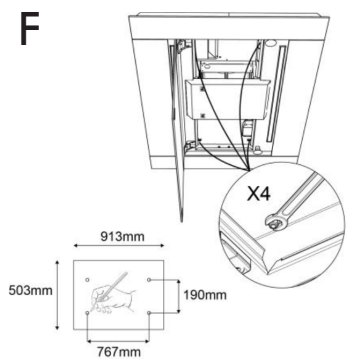
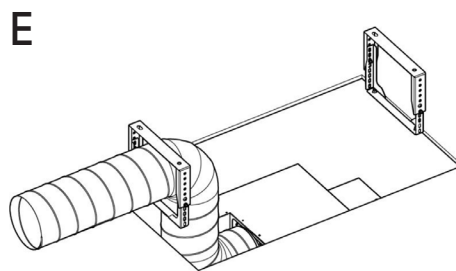
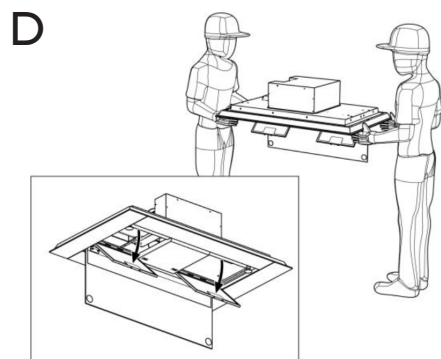
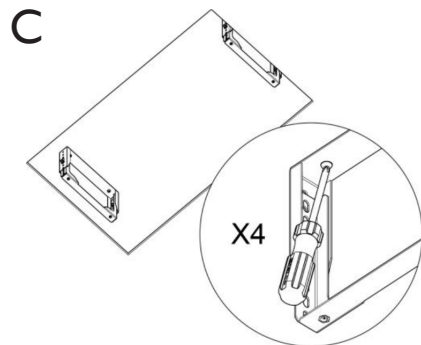
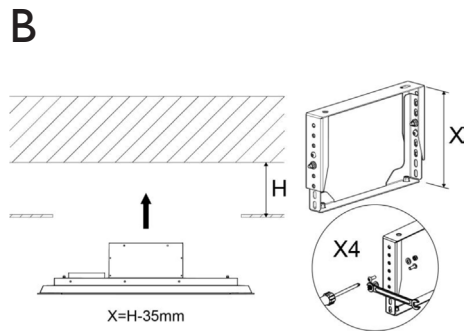
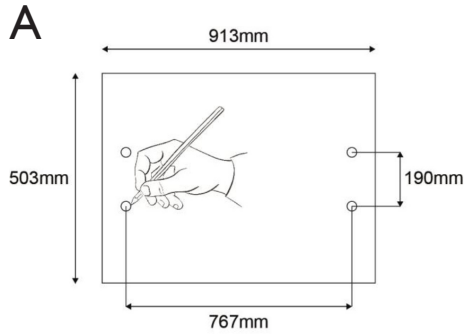

**A**

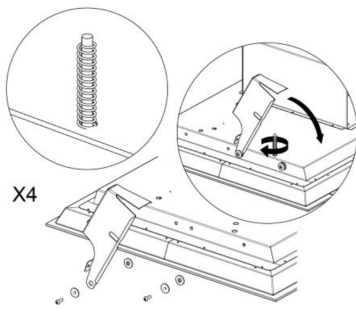

**B**

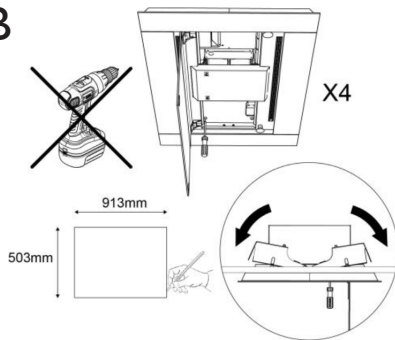

### Fastening the motor to a false ceiling (exhausting mode)

1. Insert the four screw/springs in the false ceiling (A).
2. Fit the clips to the cooker hood (A).
3. Lift the cooker hood into the hole in the false ceiling and snap the clips on the cooker hood closed (A).
4. Insert the four internal screws in the cooker hood (B) and screw them hand tight.

**Note:** Do not use a drill or overtighten the screws.

5. Close the clips (B).
6. Connect the other end of the exhaust hose to the flue or outflow.
7. Connect your cooker hood to the electrical supply.
8. Insert the filters as described on page 8.

Your cooker hood is now ready for use.

### Fastening the motor to the ceiling (filtering mode)

1. Assemble the box containing the four inox walls and fixing them manually by folding the inox tabs (A).
2. Attach the box to the cooker hood using the screws provided (B).
3. Adjust the height of the mounting brackets to 162mm (C).
4. Measure and mark the holes for the cooker hood (D).
5. Attach the separators to the ceiling (E).
6. Lift the cooker hood into position (F).
7. Securely fasten the cooker hood to the separators (G).
8. Connect your cooker hood to the electrical supply.
9. Insert the filters as described on page 9.

Your cooker hood is now ready for use.

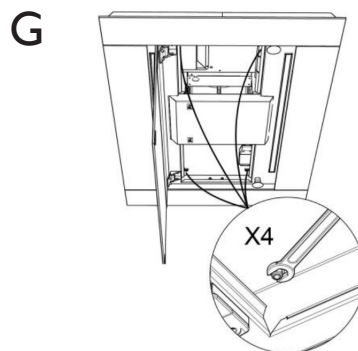
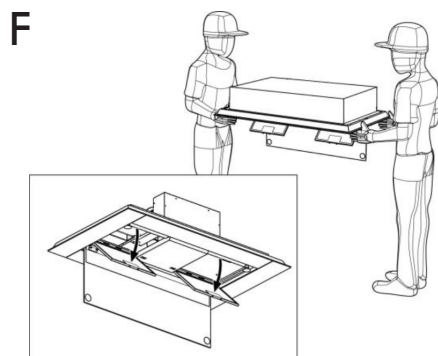
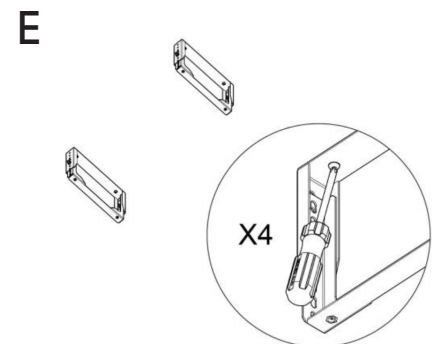
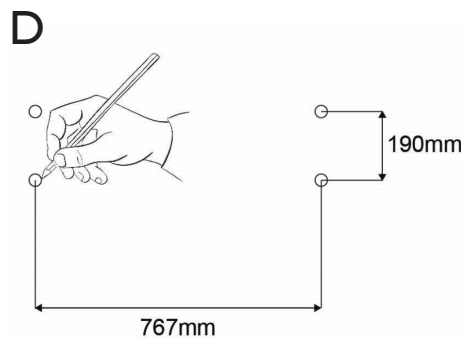
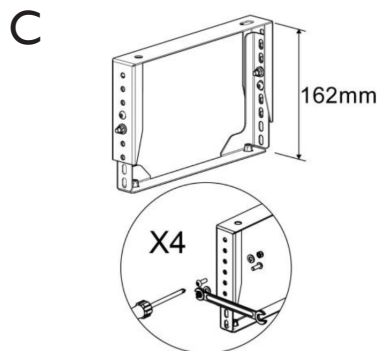
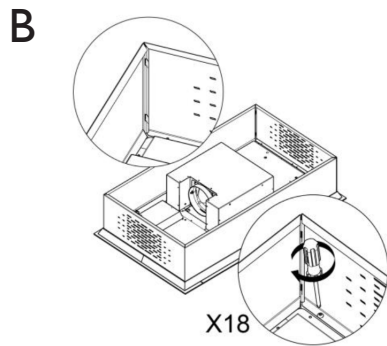
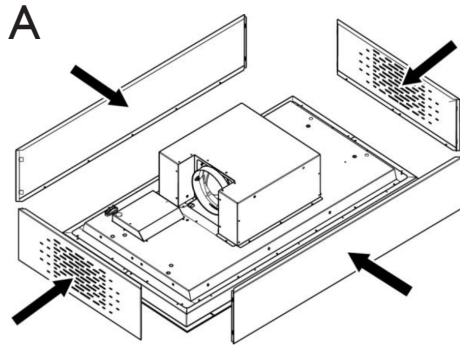

### Fastening the motor separately from the cooker hood

**Note:** The motor must be fastened no more than 7m away from the cooker hood. If this is done, the cooker hood can only be used in exhausting mode and the air outlet must not be mounted on the side of the exhaust fitting when it is mounted vertically.

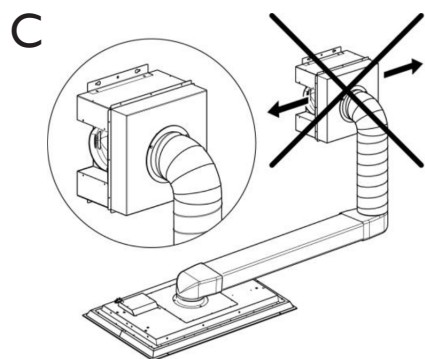
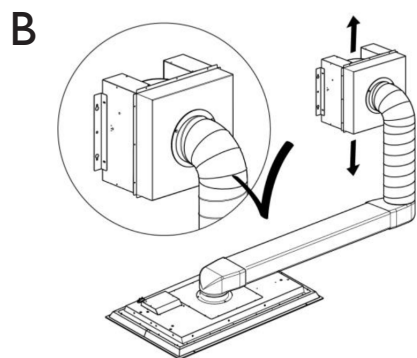
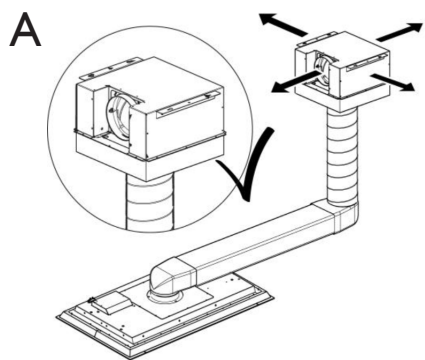

## Guarantee

Your cooker hood comes with a two year guarantee against mechanical breakdown through normal use. The guarantee does not cover you against faults caused by accidental damage or misuse. Your original receipt acts as your guarantee so please make sure you retain it throughout the guarantee period. For further details visit [johnlewis.com/customerservices](http://johnlewis.com/customerservices).

## Service

This product should only be repaired or serviced by an authorised service engineer and only genuine approved spare parts should be used.

Under no circumstances should you attempt to repair the cooker hood yourself. Repairs carried out by inexperienced persons may cause injury or serious malfunction.

If a fault occurs which you cannot resolve through following the advice and information contained within this User Guide, the next step is to contact us on 0330 100 3637. You will be given details for your local service engineer.

When you contact your local service engineer you will need to give the following details:

- Your name, address and post code
- Your telephone number
- Clear and concise details of the fault
- The purchase date as found on your receipt
- The model and serial number of the cooker hood. So that you always have these numbers at hand, we recommend you make a note of them here:

Model: .....

Serial No.: .....

**Note:** If you call out an engineer to a fault or to repair a fault caused by incorrect use or installation, a charge will be made even if the cooker hood is under guarantee.

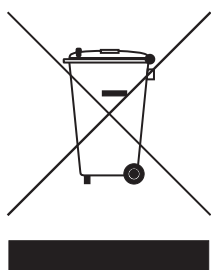

## Disposal

This symbol indicates that this product should not be treated as normal household waste and it should be recycled. John Lewis do not operate instore take back, but as members of the Distributor Take Back scheme have funded the development and upgrade of recycling facilities across the UK. Please take it to your nearest collection facility or for further details contact your local council or visit [www.recycle-more.co.uk](http://www.recycle-more.co.uk).

## Troubleshooting

To assist in locating possible faults use the help guide below:

Problem	Cause	Correction
<b>Cooker hood not operating effectively</b>		
The cooker hood is not working effectively	The fan speed is too low.	Select a higher fan speed.
	The filter needs cleaning or replacing.	Clean or replace the filter.
	The air discharge outlet may be blocked.	Check the air discharge outlet and clear any blockages.
Oil or fat collects on the filter.	The filter needs cleaning or replacing.	Clean or replace the filter.
<b>Cooker hood will not operate</b>		
The cooker hood has switched off unexpectedly during operation.	The cooker hood has overheated.	Switch off the cooker hood and wait until it has cooled down.
	The cooker hood is too close to the hob.	Re-site the cooker hood at the correct height.
	No electric current is reaching the cooker hood.	Check that the power is still on.  Replace the fuse. If you are unsure how to replace a fuse consult a qualified electrician.
The cooker hood will not start.	The cooker hood is not plugged in or the power is off.	Check that the plug is firmly pushed in and the power is on.
	No electric current is reaching the cooker hood.	Check that the power is still on.  Replace the fuse. If you are unsure how to replace a fuse consult a qualified electrician.

If none of the above suggestions resolve the problem please contact your nearest John Lewis branch. Never attempt to repair the cooker hood yourself.

### Replacing light bulbs

Your cooker hood is fitted with LED light bulbs. They should only be replaced by an authorised service engineer.



## Specifications

Specifications of the cooker hood that you have just purchased may vary from the information in this table due to technical innovations.

Type	Cooker Hood
Dimensions	1000mm wide x 600mm high
Extraction Rate (per hour)	258 - 866 m <sup>3</sup> /h
Number of Speeds	3 + Intensive
Maximum Noise Level	72 db
Motor Power	350W
Washable Metal Filters	Yes
Additional Features	Remote control LED strip lights

John Lewis Partnership  
171 Victoria Street  
London  
SW1E 5NN

[johnlewis.com](http://johnlewis.com)



Please retain these instructions for future reference