

Product Information:

Length: 160mm, Width: 160mm, Height: 45mm.

Battery Information:

Product includes 1 x 3.7V - 280mAh battery, installed inside of product, it is replaceable.

Controller:

3 x AAA battery required. 1.5V, it is replaceable. Not included.

Parameter Information:

Charging time: About 30 minutes.

Flight Time: About 5-8 minutes.

Control Distance: 20m.

Product List:

Quadcopter 1pcs, Controller 1 pcs, Manual 1pcs.

USB cable 1 pcs, Propellers 4 pcs.

Finger Holder 2 pcs.

Important:

Please keep the quadcopter far away from direct sunlight or heat. The quadcopter and controller contain electrical parts. Please keep it far away from water or wet environment. Please use a dry, clean cloth to clean the product if it gets dirty. Do not wash any parts with detergent.

Hereby, Gift Universe Management Ltd, declares this product is in compliance with the essential requirements and other relevant provisions of Directive 2014/53/EU. A copy of the original Declaration of Conformity can be obtained at the following address: Gift Universe, The Atrium, Curtis Road, Dorking Surrey RH4 1XA. This product bears the selective sorting symbol for waste electrical and electronic equipment (WEEE). This means that this product must be handled pursuant to European Directive 2012/19/EU in order to be recycled or dismantled to minimize its impact on the environment. For further information, please contact your local or regional authorities. Electronic products not included in the selective sorting process are potentially dangerous for the environment and human health due to the presence of hazardous substances.

RED5

WWW.RED5.CO.UK

Manufactured by RED5 RH4 1XA

Please retain the important information on this packaging for future reference.

55647

MADE IN CHINA

Supplier item reference: TB-802

11/17



WARNING:
CHOKING HAZARD-Small parts.
Not for children under 3 years.

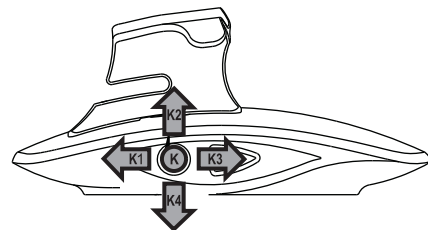

K - Auto take off/landing (Please refer to operation details)
K1 - Speed adjustment (Please refer to operation details)
K2 - Stunt (Please refer to operation details)
K3 - Turning (Please refer to operation details)
K4 - Height adjustment (Please refer to operation details)

3*AAA/1.5V

Battery not included

Battery Charging

Connect the charging cable to the quadcopter battery. Then connect the charging cables USB plug into a computers or adaptors USB port. When charging, the USB's RED indicator light will be ON. When the battery has fully charged, the RED indicator light will switch off.

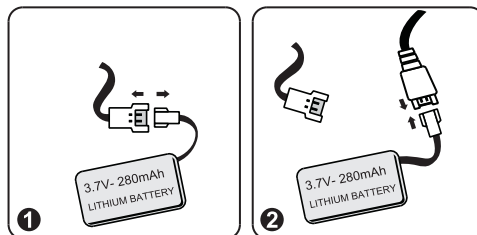

Caution:

When using the computer for charging, please remember to pull out the charging cable before shutting down the computer. Please remove the battery from the quadcopter before charging.

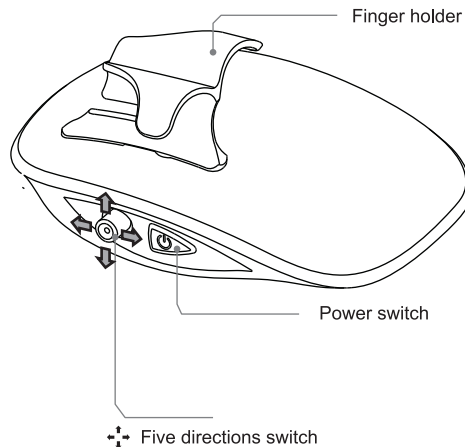

Controller Battery Installation:

1. Press down the back of the battery cover and slide off to remove the cover. (Refer to picture 3)
2. Install 3 x AAA batteries according to the correct polarity. (Refer to picture 4)
3. Replace the battery cover by sliding back on.

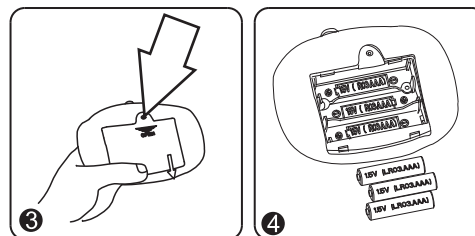

motion

◀ CONTROL DRONE ▶

RED5

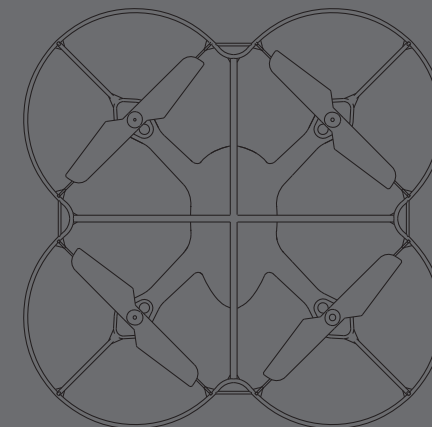

INSTRUCTION MANUAL

Ages 8+

Trouble Shooting:

1. Problem: LED indicator flashes but, no response.

Reason A: Pairing was not successful.
Trouble Shooting: Re-pair the quadcopter and the controller.

Reason B: Controller or quadcopter has insufficient power.
Trouble Shooting: Replace the controller's batteries and/ or recharge the quadcopter's battery.

2. Problem: The blades spin but the quadcopter won't fly.

Reason A: The blade has been damaged.
Trouble Shooting: Replace the damaged blade, with the spares included.

Reason B: Quadcopter battery is not fully charged .
Trouble Shooting: Charge the quadcopter until the battery is fully charged.

3. Problem: The quadcopter shakes.

Reason A: The blade has been damaged.
Trouble Shooting: Replace the damaged blade with the spares included.

4. Problem: The quadcopter flies out of control after crashing.

Reason A: The trim adjustment may have been affected after the crash, causing the quadcopter to lose balance.
Trouble Shooting: Re-start the quadcopter.



IMPORTANT SAFETY PRECAUTIONS

Note:

The quadcopter contains a Lithium Polymer Battery which is built into the quadcopter. Do not disassemble the quadcopter as this may result in permanent damage or hazardous operation.

DO NOT modify this product in any way.
DO NOT launch at people or animals.
DO NOT use near overhead cables, vents, fans or any other obstacles.

Keep propeller away from eyes, face, hands, hair and loose clothing.

Make sure people around you are aware you are using the quadcopter.

If the quadcopter gets stuck in high places, ask an adult to retrieve it for you. DO NOT attempt to retrieve it yourself.

Only use the charger provided to charge the quadcopter. The charging process should only be completed by adults.

ADULT SUPERVISION IS RECOMMENDED AT ALL TIMES!

Note:

The battery will become warm during use, before charging the battery please allow the battery to cool down completely before removing from the quadcopter and before charging.



IMPORTANT BATTERY INFORMATION

- Requires 3 x AAA 4.5V (not included).
- Batteries should only be replaced by an adult.
- Do not mix old and new batteries.
- Do not mix alkaline, standard (carbon-zinc) or rechargeable (nickel-cadmium) batteries.
- Do not re-charge non-rechargeable batteries.
- Rechargeable batteries are only to be charged under adult supervision.
- Rechargeable batteries are to be removed from the product before being charged.
- Ensure batteries are inserted with the correct polarity.
- Exhausted batteries should always be removed.
- The terminals should not be short circuited.
- Use a screwdriver to remove the screw from the battery cover. Replace battery cover and screw before use.

Flight and Preparation

1. Connect the battery to the quadcopter, the LED indicator will then start to flash. Place the quadcopter on flat ground, the LED indicator will then change to a slow flash.
2. Make sure the batteries are correctly installed into the controller.
3. Press the ON/OFF transparent button of the controller. (Refer to picture 1). The quadcopter's LED indicator will flash to indicate successful pairing. If there is no indication of pairing, re-press the ON/OFF button until successful.

1

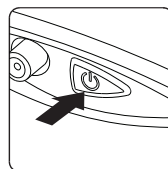

4

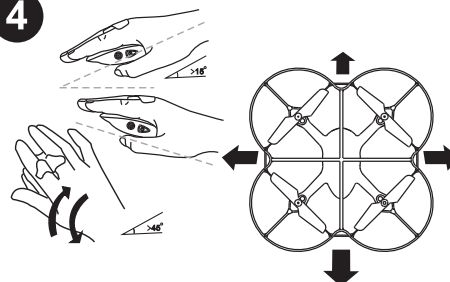

3. Push "K" to "K3" position, at the same time move your hand to the left or to the right. The quadcopter will then turn left or right. (Refer to picture 5)

5

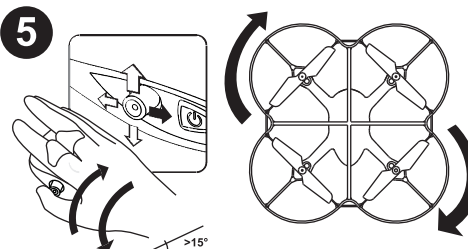

4. Push "K" to "K1" position, to adjust the speed setting. Push once to increase to a medium speed. Push again for a high speed. Push once again to return to a low speed. (Refer to picture 6).

6

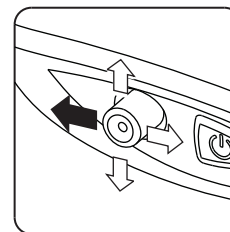

5. To fly the quadcopter lower or higher, press "K" to "K4" position. While at the same time gently and slowly moving your wrist up or down. Release from "K4" position and the quadcopter will hover at current height. (Refer to picture 7)

7

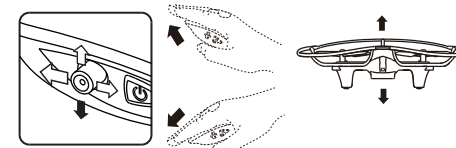

6. Landing - Press "K", the quadcopter will stop flying and begin to land slowly.

7. In case of an emergency, press the ON/OFF button to turn off the quadcopter immediately.

Operation and Control

2



Hold the controller horizontally.
(Refer to picture 2).

1. Press "K", the quadcopter will take off automatically and hover at a pre-set height. (Refer to picture 3).

3

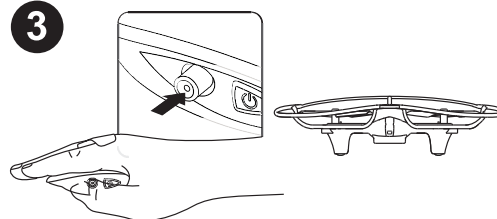

3D Eversion

1. Press "K" to "K2" position, lean the controller to the right/ left or forwards/ backwards to perform a 360° stunt. Make sure that when leaning the controller, your wrist is at an angle over 75°. Please also ensure the quadcopter is fully charged. (Refer to picture 8).

8

