

STACKERS

WATCH WINDER
INSTRUCTION MANUAL

Watch Winder Instructions

Your Watch Winder comes with a mains powered international adapter, the socket is located at the back of the unit. Some models of watch winder can also operate on battery power.

If you choose to operate your watch winder by batteries, insert standard AA batteries (not included), into the battery housing found underneath the winder. Make sure to insert the batteries matching the "+" and "-" signs. We recommend Alkaline batteries are used for improved battery life.

Preparing Your Watch Winder

Remove the watch cuff by pulling firmly on the tabs of the cuff.

Place your watch over the centre of the cuff

(1) With the face of the watch outward. To facilitate ease of closing your watch strap over the cuff, first compress the cuff & close the watch strap. Tighten the straps or bracelet of the watch snugly so that it is held in place on the cuff.

Slide cuff back inside the case with the watch facing outward until it clicks into place.

(2) You are now ready to turn on your watch winder.

Caution! The Watch Winder should never be turned manually as this may cause damage to your internal drive mechanism.

Never remove your watch from the winder while in operation.

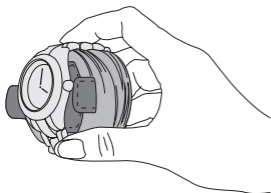

(1)

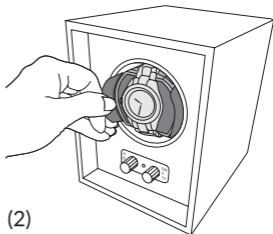

(2)

Control Panel:

There are two rotary switches located on the control panel next to each winder cuff.

Setting ON – Winder will begin motion.

Setting 0 - No Motion.

Setting 12 - Winder will begin motion after 12 hours.

LED light - Green light will be displayed when in motion.

If a red light is displayed (when using battery only mode) please replace the batteries.

Mode Switch

Mode A – In this mode the winding drum will rotate in a clockwise direction for 154 revolutions (approx. 50 minutes) and then stop for approx. 190 minutes. This equals one 240 minute (4 hour) rotation cycle. This rotation cycle is repeated 4 times (16 hours). The winder rests for 8 hours before it starts the same 24 hour cycle again.

Mode B – The operation of this mode is similar to that of Mode A except the rotation will be in the counter-clockwise direction.

Mode C – In this mode, the winding drum will start rotation in the clockwise direction for 154 revolutions and then rotate counter – clockwise for another 154 revolutions (approx. 100 minutes in total). It will then stop for approx. 140 minutes to complete one 4 hour cycle.

This is repeated 4 times before resting for 8 hours.

Please Note; The rationale for multiple modes of rotation is to provide winding capabilities for even the most unique watches and/or those with specific requirements.

Stackers specialist programmed technology ensures watches are wound to the correct tension replicating human behavioural patterns for which the watch was originally designed.

Thank you for purchasing this Stackers Watch Winder, should you require any further assistance or advice then please do not hesitate to contact us as per the details below:

LC Designs Co. Ltd,
London House,
Sheldon Way,
Larkfield,
Aylesford,
Kent,
ME20 6SE

(0)1622 714 237

hello@stackers.com

stackers.com