

Toledo Bathroom Wall Light

Installation Instructions

Thank you for purchasing this Toledo Bathroom Wall Light. Please read the instructions carefully before use to ensure safe and satisfactory operation of this product.

This product is rated IP44 and must not be used without the shade attached

Please keep these instructions for future use.

Warnings!

This is a Class I product and must be earthed.

Please read these instructions carefully before commencing any work. It is recommended that this fitting is installed by a qualified electrician.

Install in accordance with the IEE Wiring regulations and the Building Regulations.

To prevent electrocution switch off at mains supply before installing or maintaining this fitting. Ensure other persons cannot restore the electrical supply without your knowledge. If you are in any doubt, please consult a qualified electrician.

This light fitting should be connected to a 5 amp fused circuit.

If replacing an existing fitting, make a note of the connections.

Always use the correct type and wattage bulb. Never exceed the wattage stated.

When changing a bulb, always switch off at the mains and allow the old bulb to cool down before handling.

Dispose of used bulbs carefully.

This product is suitable for indoor use only, on normal flammable surfaces.

Installation:

This product has special protection against the ingress of moisture and is IP44 rated.

This product is suitable for use in Zone 1, Zone 2, and outside Zones of a bathroom. See diagram. If installing in a bathroom a 30mA RCD must be used - in accordance with IEE Wiring Regulations and the Building Regulations.

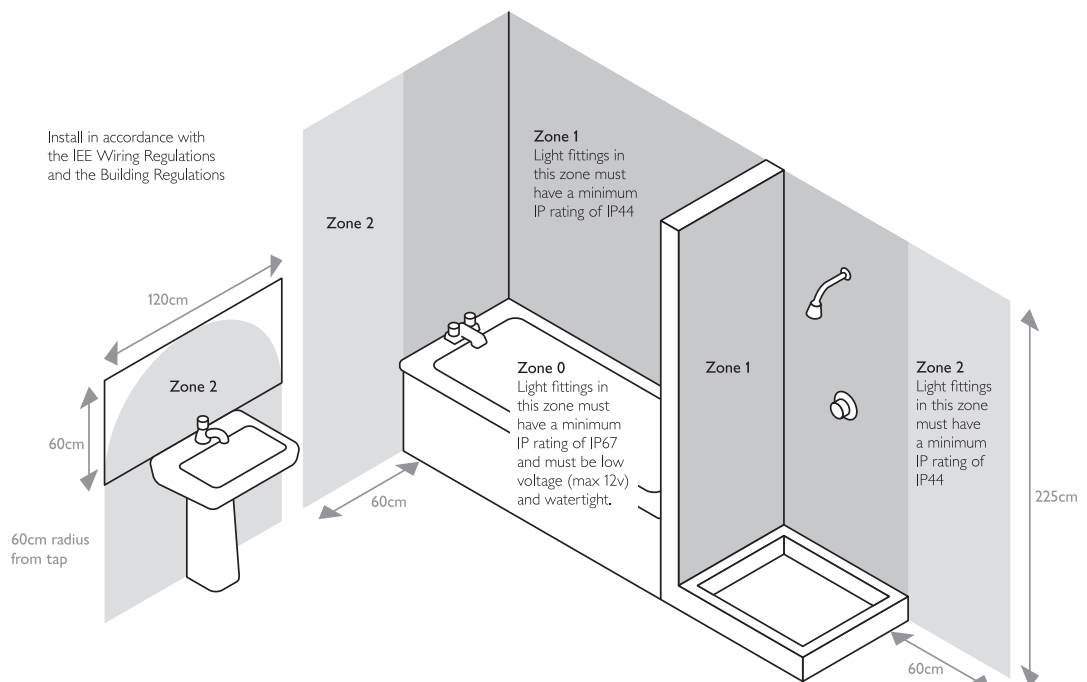

Fixing Instructions

Make sure you have the following items which are required to install this light fitting:

Small electrical screwdriver, cross head screwdriver & insulation tape.

Step 1

Existing wall fittings must be completely removed before installation of a new product. Before removing these fittings, carefully note the position of each set of wires. Where a ring/loop circuit exists there will be a fourth set of wires (usually red) that are not connected to the L, N, or E. of the fitting. This circuit must be kept together in the 4th terminal of the connection block, and insulated from the fitting and the other wires. The ring/loop will remain live unless isolated at the mains or circuit breaker regardless of the position of the wall switch.

Step 2

Remove the wall back from the product by removing side screws. Attach to the wall using the screws provided. Take care to avoid damaging any concealed wiring and pipes.

Step 3

Having identified the household wiring from your existing light fitting, connect to the connection block inside the product in the following way:

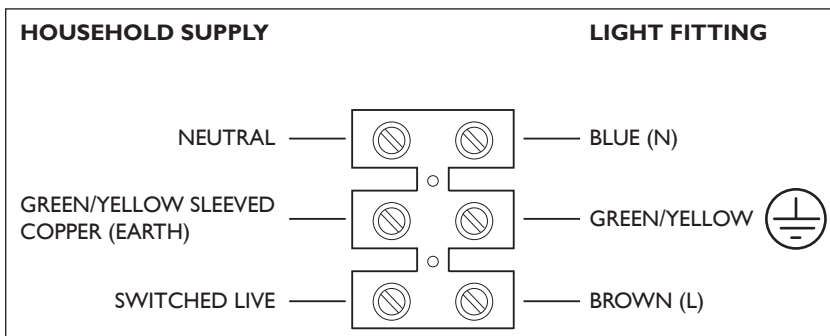

Check that.....

You have correctly identified the house wires.
The connections are tight.
No loose strands have been left out of the connection block.

Step 4

When complete, wrap the terminal block in at least two layers of good quality insulation tape such that it is covered at least 8mm on each side.

Step 5

Refit the product to the wall back. Refit and tighten the side screws to secure. Take care not to trap any wiring.
This product must only be used with the glass shades facing downwards.

Step 6

Fitting the bulb and shade

Bulb Type: Max. 18W G9 Halogen

Always switch off at the mains and allow the bulb to cool before replacing. Use a soft cloth to handle G9 bulbs, avoid directly touching the bulbs as this will shorten their life. Always use a replacement bulb of the same type and never exceed maximum wattage. Dispose of the used bulb carefully.

Once the bulb is fitted, screw the glass tube shade (A) over the bulb. Make sure the seal is tight to provide adequate ingress protection

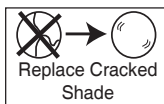

The glass shade must be replaced if it becomes cracked or damaged. Do not use the product without the glass shade attached.

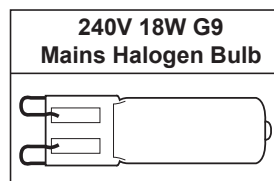

Push-in to fit,
Pull-out to remove

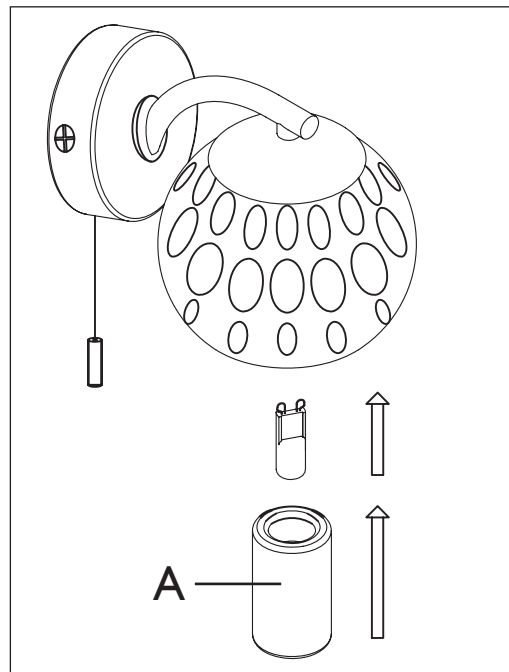

Step 7

Replace fuse or circuit breaker and switch on. Your light is now ready for use.

Care and cleaning

Finish - We recommend cleaning with a soft dry cloth. Do not use abrasive materials as these will damage the finish.

Glass parts - Clean with a damp cloth. Do not use abrasive materials as these will damage the finish.

Safety Information

For your safety, always switch off the supply before changing lightbulbs, cleaning or removing shades.

We have taken great care to ensure that this product reaches you in perfect condition. However, should any parts be damaged or missing please contact our Product Helpline on (01202) 690945. We will despatch to you, within 7 working days, your missing/damaged part. When phoning please ensure you have the following information available: Name and Address, Daytime Telephone Number, Store and Date of Purchase, Product Reference (inside ceiling cover or on box label), Description of Missing/Damaged Part. This does not affect your statutory rights.