

Essence Oak 1 drawer 1 door bedside

Stock number: 803/14007

Thank you for purchasing this Essence Oak 1 drawer 1 door bedside chest. Your bedside chest has been delivered with the doors assembled by the factory. If you wish to change the door from left hand opening to right hand opening, or vice versa, please follow the instructions below. Otherwise there is no assembly required. Please read the instructions carefully before use to ensure safe and satisfactory operation of this product

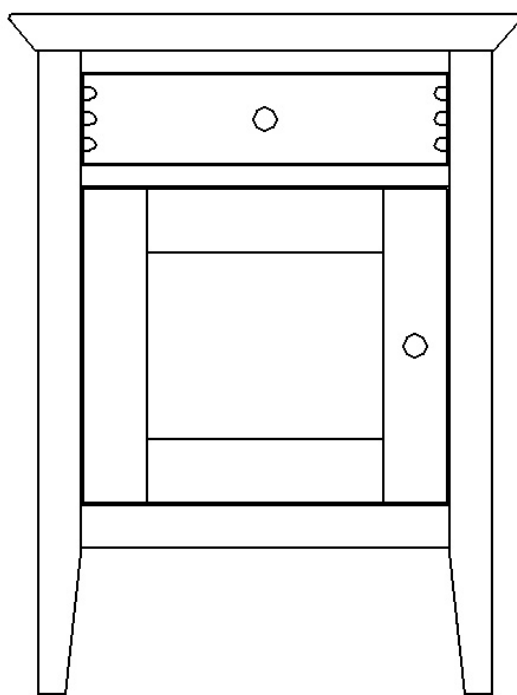

Pre-assembly preparation

Please ensure instructions are read in full before attempting to reposition the doors.

Necessary Tools



You will require a cross head screwdriver to assemble this product. An electric drill may cause damage to the product and is not recommended.

Please check the pack contents before attempting to assemble this product. A full checklist of

components is given in this leaflet. If any components are missing, please contact John Lewis Customer Services or your local branch.

This product takes approximately 15 MINUTES to assemble with 1 PERSON.

The fittings pack contains SMALL ITEMS which should be KEPT AWAY FROM YOUNG CHILDREN.

Read this leaflet in full before commencing assembly.

Fittings and parts checklist

A 8 x 8mm Screw



Step by step assembly instructions

Step One

Unscrew the 4 screws (A) that attach the metal hinges to the wooden chest frame (do not unscrew the 4 screws that attach the metal hinge to the door).

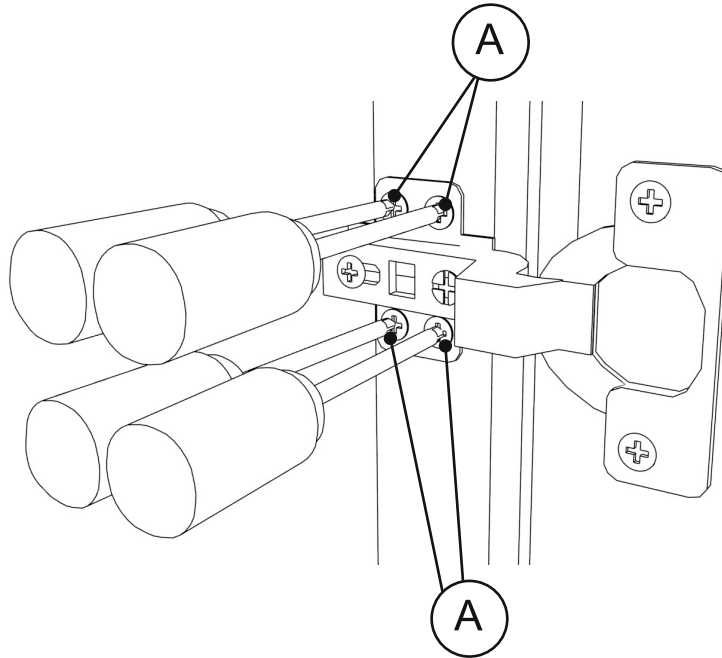

Step Two

Turn the door upside down and attach the metal hinges to the opposite side of the wooden chest frame. Use the predrilled pilot holes to correctly position the metal hinges. Unscrew the metal plate from the top of the door and reattached to the bottom of the door using the

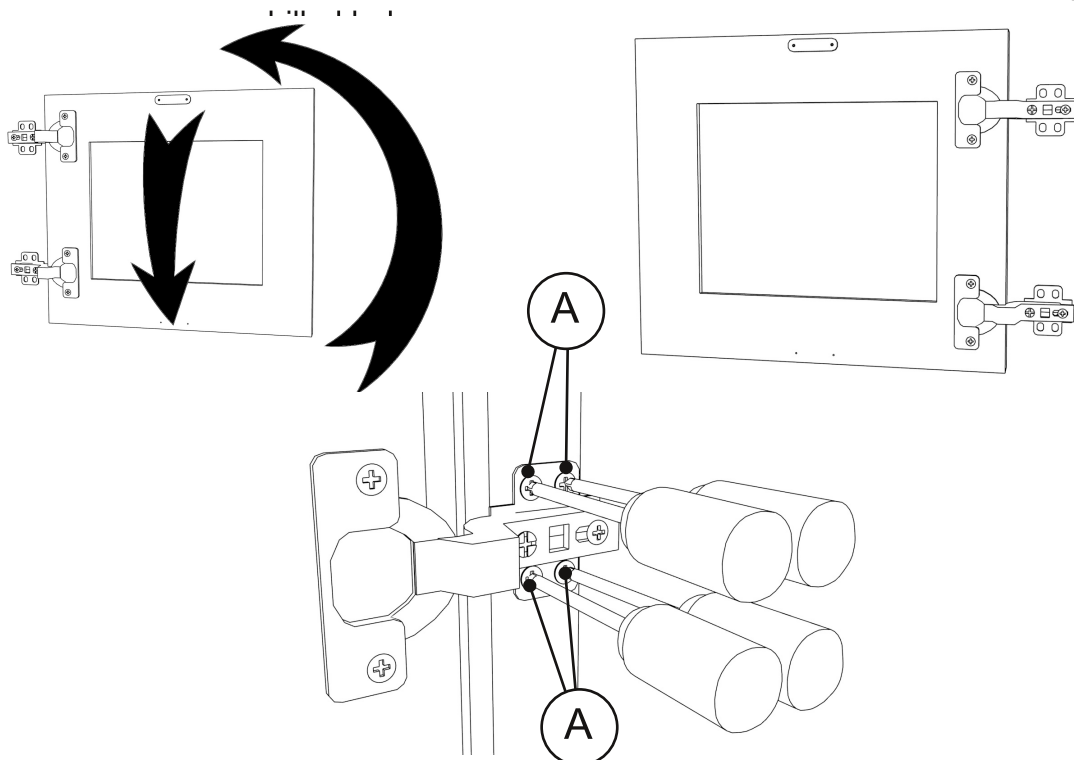

Step Three

Check that the doors are aligned correctly and if necessary adjust the door hinges as shown below. Check that the magnets hold the door closed and that the doors are aligned correctly as shown below.

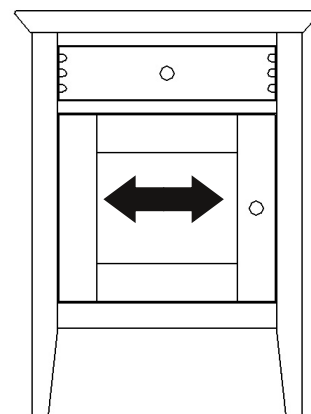
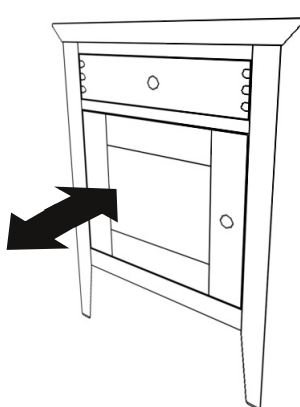
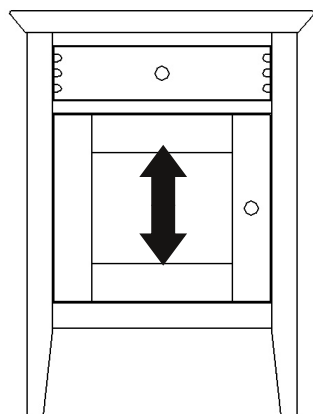
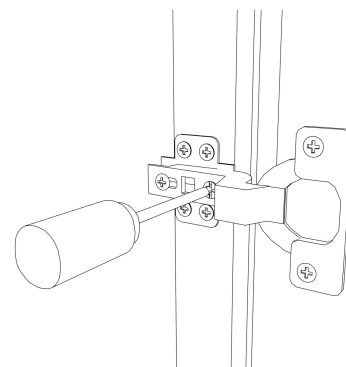
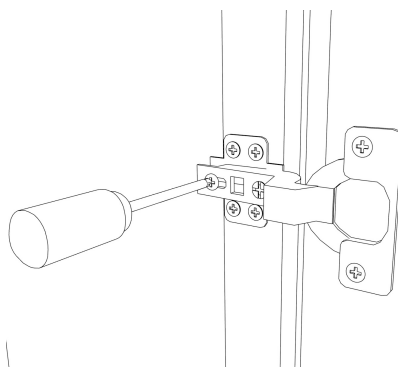
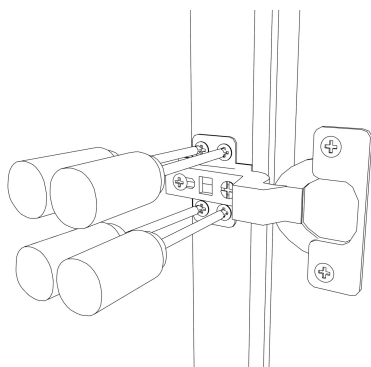

Vertical Hinge Adjustment

Horizontal Hinge Adjustment

Lateral Hinge Adjustment

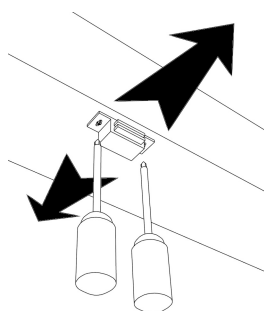

Horizontal Magnetic Catch

Care and Maintenance

Wood Furniture

The Essence range has been sourced by John Lewis from the finest American Oak and each piece has been carefully constructed to ensure it will give you years of pleasure. The natural characteristics of this oak range may include small cracks, knots, blemishes and grain pattern variations which all add to the natural charm and beauty of this furniture product. Each piece is unique, and for this reason no two pieces within the range will perfectly match, however there will be harmony between all the pieces you may have purchased.

How to care for your wood furniture

Try to avoid prolonged exposure to direct sunlight as this may alter the colour and tone of your furniture over time.

Any spillages that do happen should be wiped up immediately with a clean dry lint free cloth to avoid marking the surface of the furniture.

Safety Instructions

General warnings:

Never drag furniture when moving it, always lift it.

Periodically check all fixings to ensure none have come loose and re-tighten where necessary. Please take care when handling or moving the furniture as careless handling may cause damage or injury.

Furniture can be dangerous if incorrectly installed. Assembly should be carried out by a competent person. No liability will be accepted for damage or injury caused by incorrectly

Specific warnings for heavy items:

It is recommended that before moving heavy objects to a new location they are completely dis-assembled to avoid personal injury or damage to the furniture. Please be careful to retain all fittings when doing this.

PLEASE KEEP THESE INSTRUCTIONS FOR FUTURE REFERENCE