

# Anna glider crib

## Instruction manual



**John Lewis**

Important - Retain for future reference - please read carefully

Thank you for purchasing this Anna glider crib. Please read the instructions and warnings carefully before use to ensure safe and satisfactory operation of this product.

Your child's safety is your responsibility. If you have a query with this product or require replacement parts, please contact your nearest John Lewis department store.

Lay out the parts on a soft level surface and compare to the part/fixings checklist on page 2. Do not discard any packaging until you are sure that you have all the parts.

Ensure that your child is kept clear during assembly due to small parts.

Recommended mattress: 38 x 89cm

This product complies with BS EN 1130-1: 1997

### Fixings

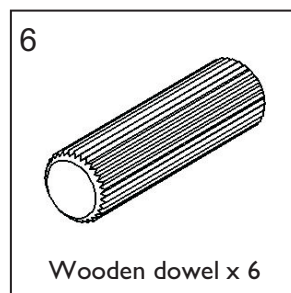
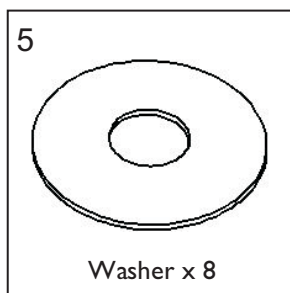
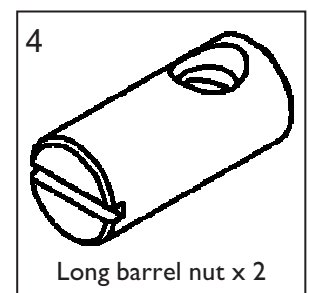
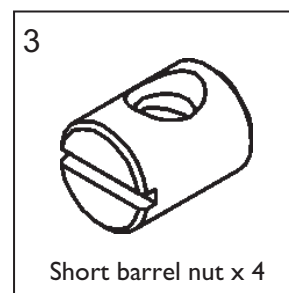
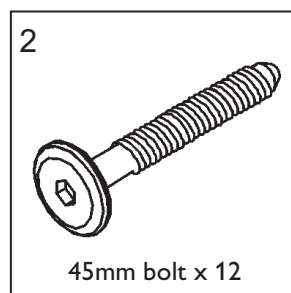
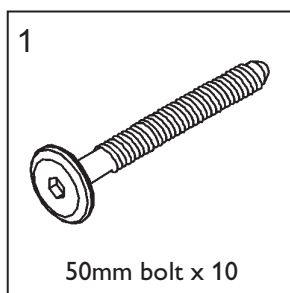

You will need:  
2 people required to put the crib together  
1x Flat-headed screwdriver  
1x Allen key (supplied)

### Parts

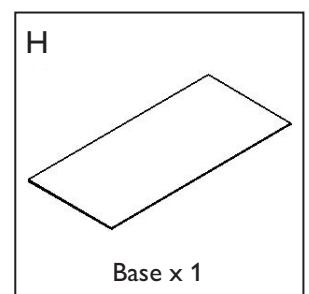
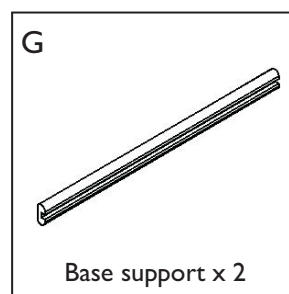
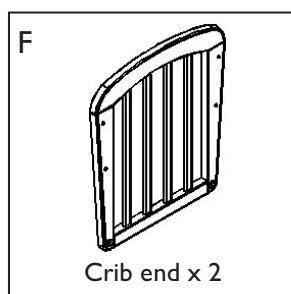
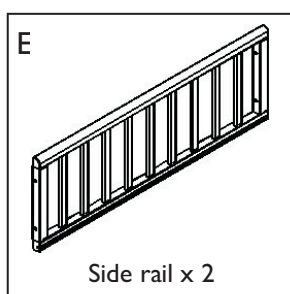
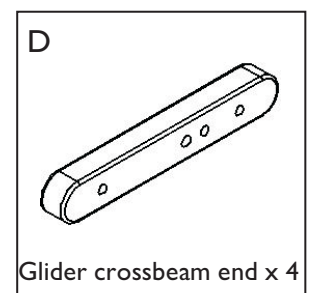
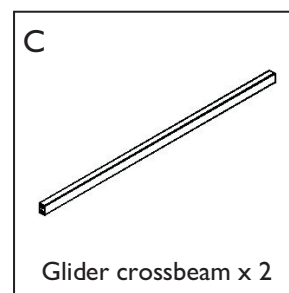
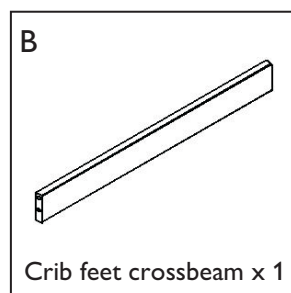
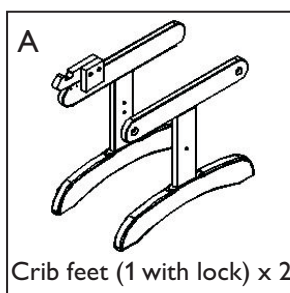

### Step 1

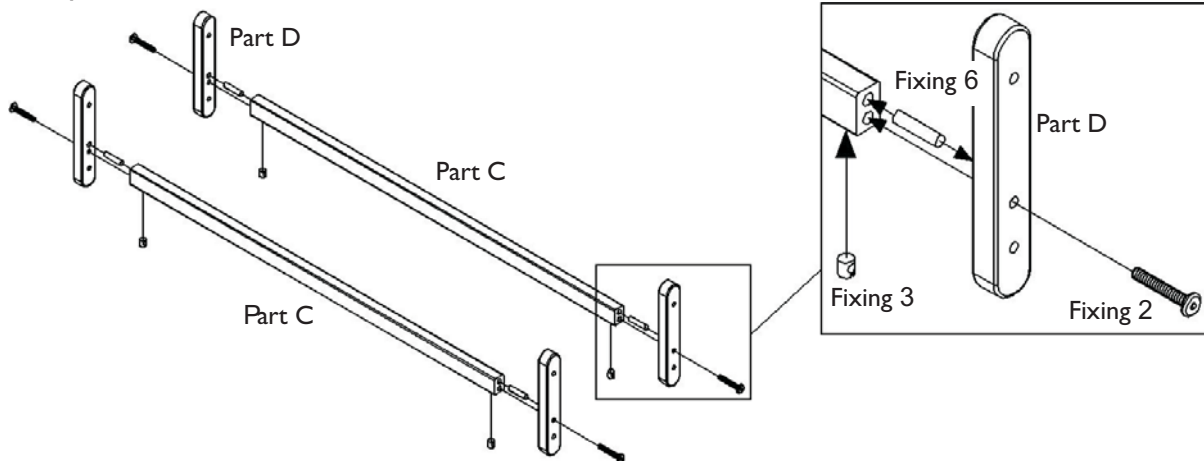

Insert one wooden dowel (fixing 6) into the top pre-drilled hole at each end of the glider crossbeams (part C). Assemble the glider crossbeam ends (part D) to the glider crossbeams (part C) using one 45mm bolt (fixing 2) and one short barrel nut (fixing 3) at each end as shown. If necessary, use a flat-headed screwdriver to ensure that the slots in the short barrel nut (fixing 3) point towards the holes in the glider crossbeam ends (part D). Use the allen key (supplied) to engage the bolts into the barrel nuts. Tighten all fixings fully.

### Step 2

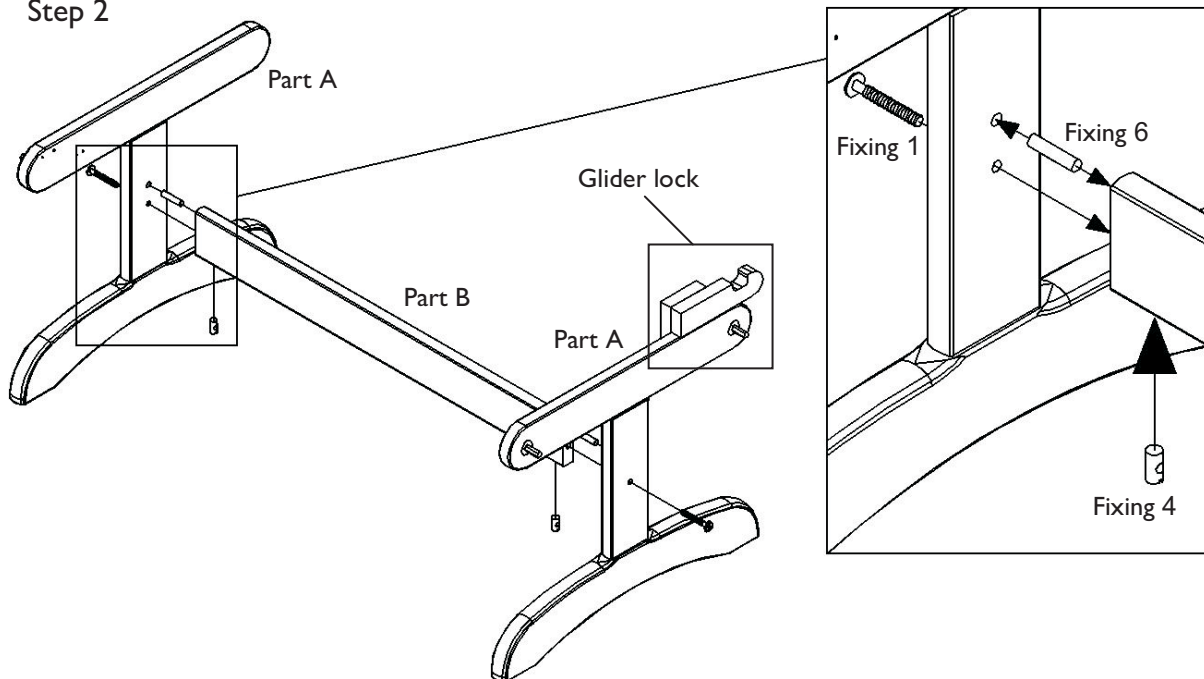

Insert one wooden dowel (fixing 6) into the upper pre-drilled hole at each end of the crib feet crossbeam (part B) and assemble with the crib feet (part A). Secure the crib feet crossbeam (part B) to the crib feet (part A) using one 50mm bolt (fixing 1) and one long barrel nut (fixing 4) at each end as shown. If necessary, use a flat-headed screwdriver to ensure that the slots in the long barrel nuts (fixing 4) point towards the holes in the crib feet (part A). Use the allen key (supplied) to engage the bolts into the barrel nuts. Tighten all fixings fully.

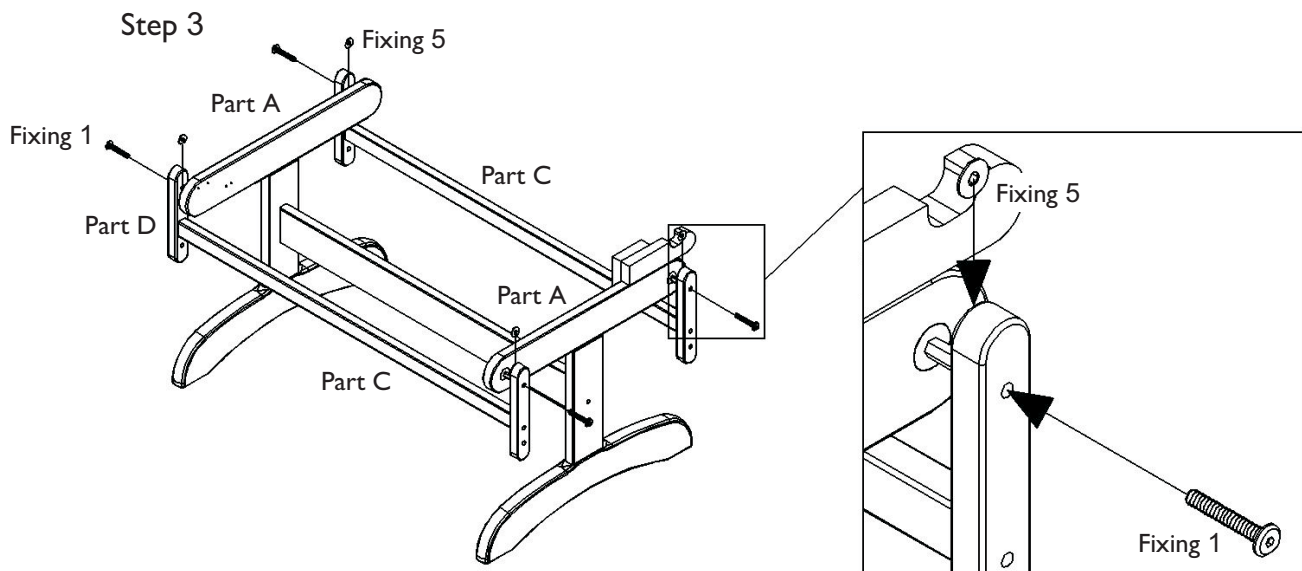

Insert one 50mm bolt (fixing 1) through the outside of the glider crossbeam ends (part D), followed by a washer (fixing 5) and into the hexagonal sleeve in the crib feet (part A). Note: as you tighten the 50mm bolt (fixing 1) with the allen key (supplied), use a spanner or pliers to hold the hexagonal sleeve. Take care not over-tighten. Repeat at each corner of the crib feet (part A).

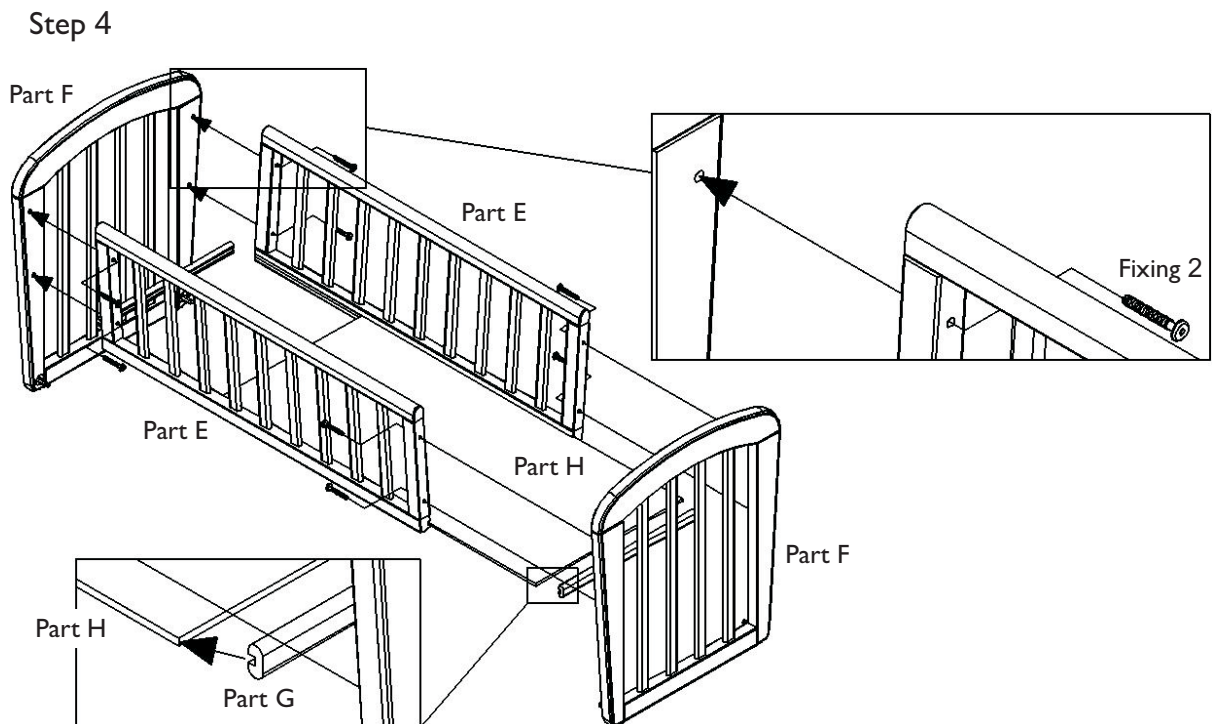

Fix the side rails (part E) to one of the crib ends (part F) using two 45mm bolts (fixing 2) at either side as shown. Note: the groove in the side rails (part E) should be on the inside. Attach one base support (part G) to the assembled crib end (part F). Note: the groove in the base support (part G) should line up with the groove in the side rails (part E). Carefully slide the base (part H) through the grooves in the side rails (part E) and into the base support (part G). Squeeze side rails (part E) together / inwards securing base (part H) in place, tighten bolts (fixing 2). Attach the other base support (part G) to the other crib end (part F) and carefully fit this onto the base (part H) as shown. Secure the crib end (part F) to the side rails (part E) using two 45mm bolts (fixing 2) at either side. Squeeze side rails (part E) together / inwards securing base (part H) in place, tighten bolts (fixing 2).

## Step 5

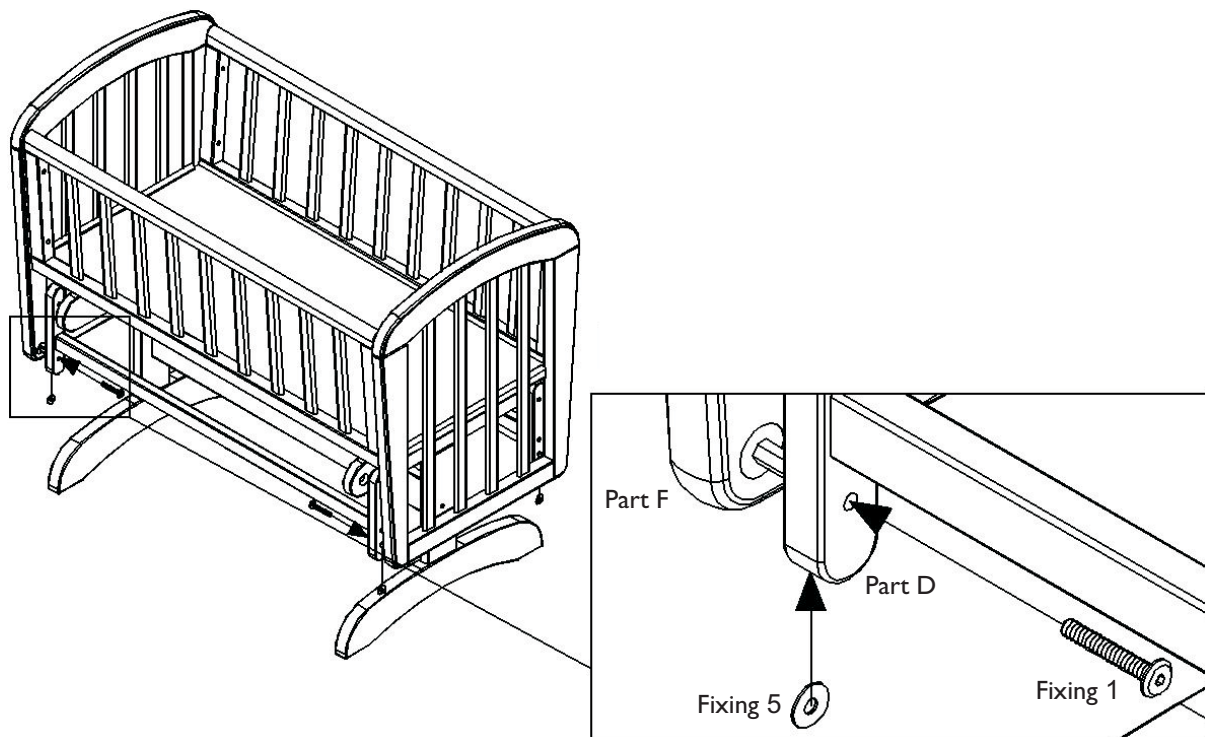

Place the crib construction onto the glider as shown. Note: the hook of the glider lock should be over the edge of the bottom of the side rail (part E). Insert one 50mm bolt (fixing 1) from the inside of the glider crossbeam end (part D), followed by a washer (fixing 5) and into the hexagonal sleeve in the crib end (part F). Note: as you tighten the 50mm bolt (fixing 1) with the allen key (supplied), use a spanner or pliers to hold the hexagonal sleeve. Take care not over tighten it. Repeat at each corner of the crib.

### **Please note:**

**To unlock the glider, press the button and carefully push the lock sideways. Note: the glider should always be locked when moving the crib and when your baby is asleep or left unsupervised.**

**Periodically check the base is secure and sides are as tightly fitted to the base board as possible, and screws are re tightened as necessary.**

### Care and maintenance

Your furniture may be cleaned by wiping with a damp cloth and drying with a soft clean cloth.

Do not use abrasives, bleach, alcohol or ammonia-based household polishes.

Take care when handling or moving the furniture. Careless handling may cause damage.

Regularly check the product screws and tighten them from time to time.

### Safety notes

When your child is able to sit, kneel or to pull itself up, the crib shall not be used anymore for this child.

Furniture can be dangerous if incorrectly installed. Assembly should be carried out by a competent person.

Keep children clear during assembly as pack contains small parts which may present a choking hazard.

The crib must always be placed on a flat, level surface.

Young children should not be allowed to play unsupervised in the vicinity of the crib.

Warning: When your child is left unsupervised in the crib, it should be locked in the fixed position.

Never use the body of the crib without its frame. Do not use the crib if any part is broken, torn or missing.

The thickness of the mattress chosen must not reduce the internal depth (from the top of the mattress surface to the top of the side) to less than 200mm.

The mattress should be no more than 30mm shorter or narrower than the internal length or width of the crib.

All assembly fixings should always be tightened properly. Care should be taken that no screws are loose because a child could trap parts of their body, or clothing (e.g. strings, necklaces, ribbons, dummies, etc) which could pose a risk of strangulation.

Be aware of the risks of open fires and other such sources of strong heat, such as electric bar fires, gas fires, etc in the vicinity of the crib.

Ensure the crib is positioned away from any cords on blinds or curtains to avoid risk of entanglement.

John Lewis Partnership  
171 Victoria Street  
London  
SW1E 5NN

[www.johnlewis.com](http://www.johnlewis.com)