

# ASSEMBLY INSTRUCTION

## ELLIS DRINKS CABINET

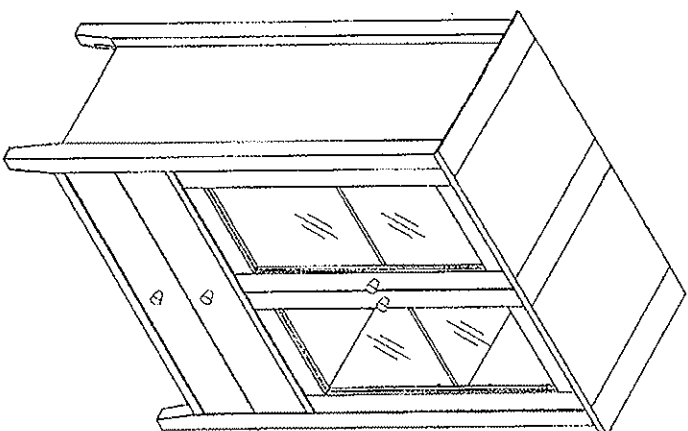

SIZE : W 834 x D 410 x H 1110

- Keep hardware and small parts out of children's reach.
- Wipe clean with a damp cloth only.
- Keep these instructions for future reference.
- Periodically check and re-tighten fixings if necessary.
- When fixing cabinet to wall with fixing kit supplied before drilling holes check for hidden electrical wires and water pipes. Fixings for solid walls only. if in doubt seek professional help.
- Take care when assembling components with glass.

### PARTS:

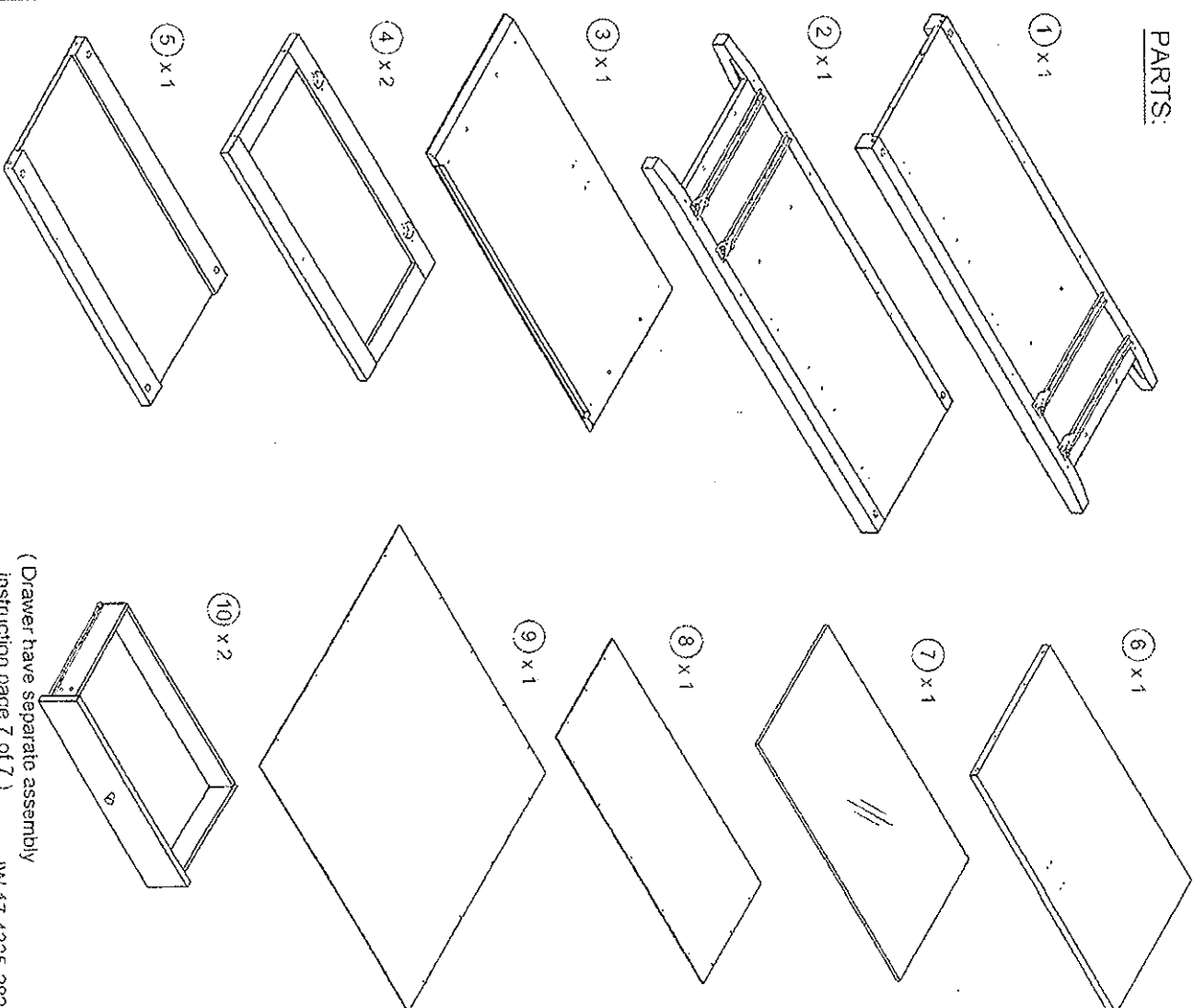

( Drawer have separate assembly  
instruction page 7 of 7 )  
iW-17-4335-282-0

# HARDWARE



(A) x 4



(B) x 4



(C) x 16  
(Ø4.2 x 10.5)

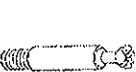

(D) x 12  
(Ø7x34)



(E) x 12  
(Ø15x12.5)

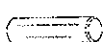

(F) x 12  
(Ø8x30)



(G) x 29  
(Ø3x15)

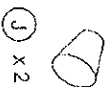

(J) x 2

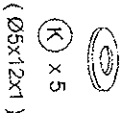

(K) x 5  
(Ø5x12x1)



(L) x 4

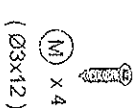

(M) x 4  
(Ø3x12)

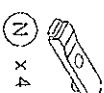

(N) x 4



(P) x 4

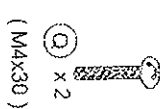

(Q) x 2  
(MAX30)

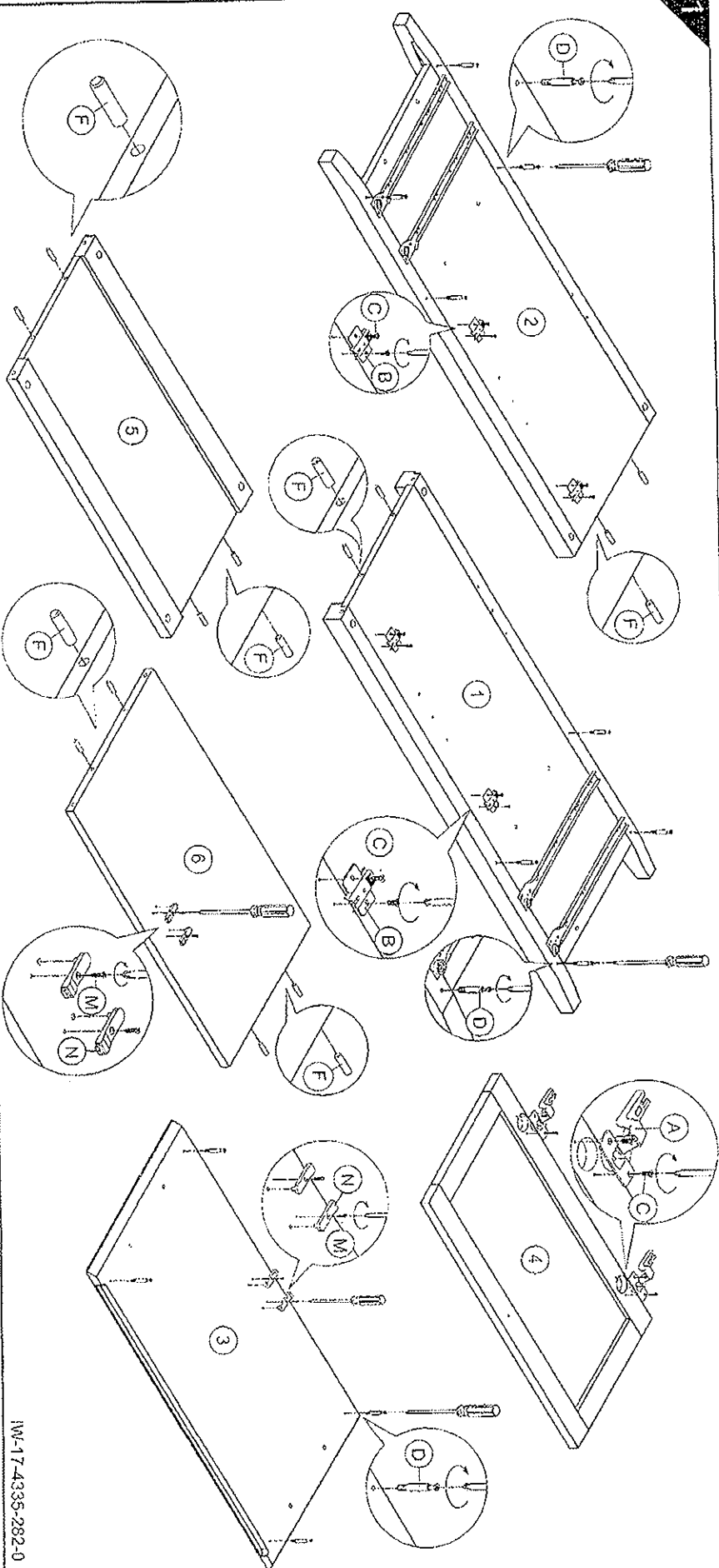

2

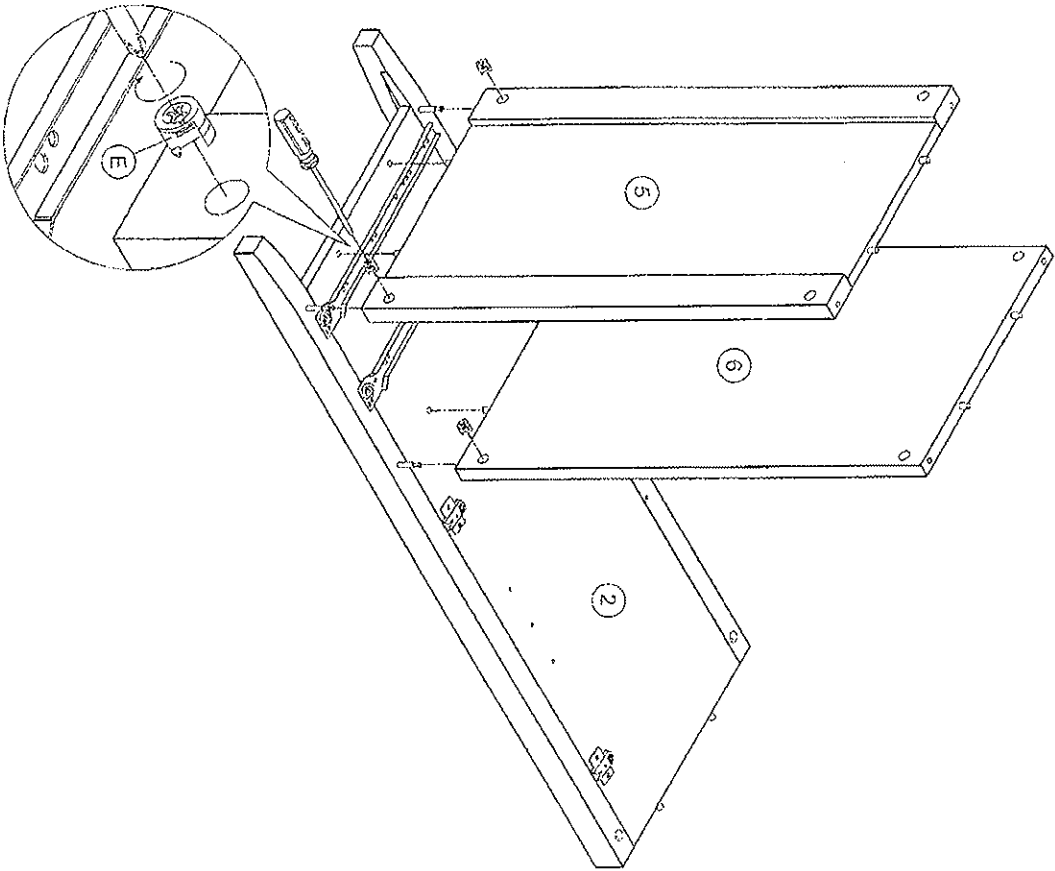

3

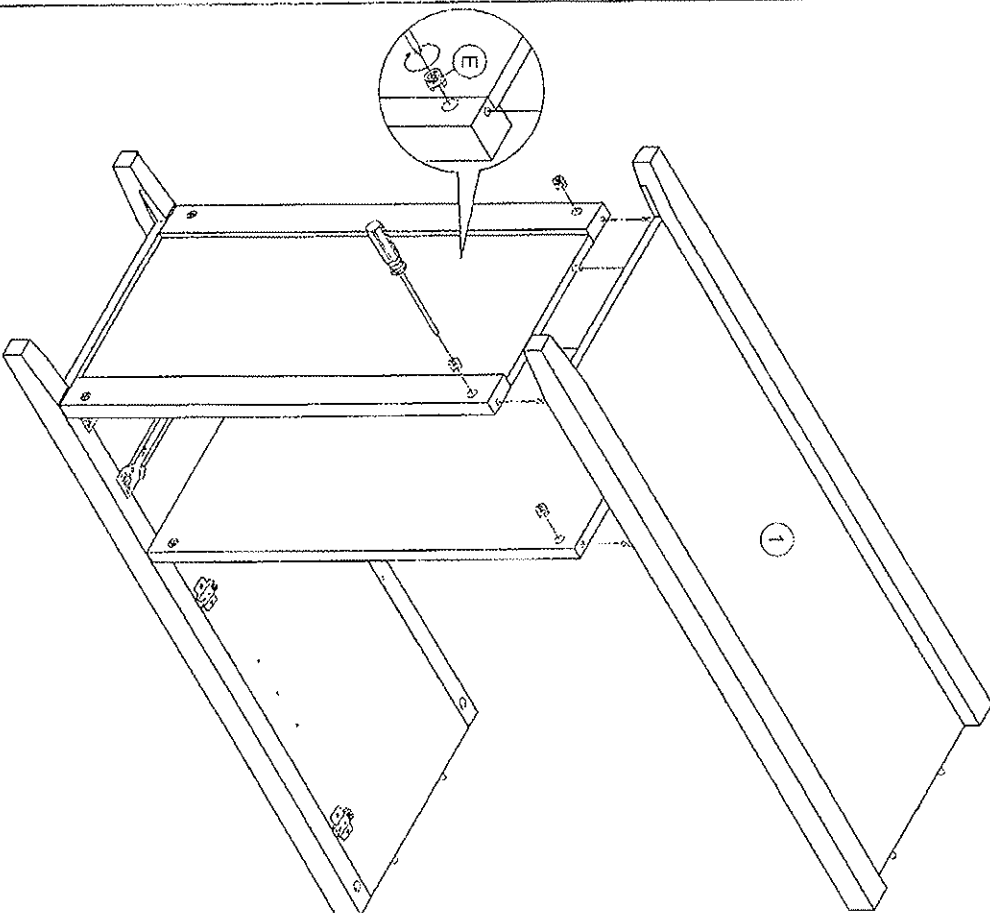

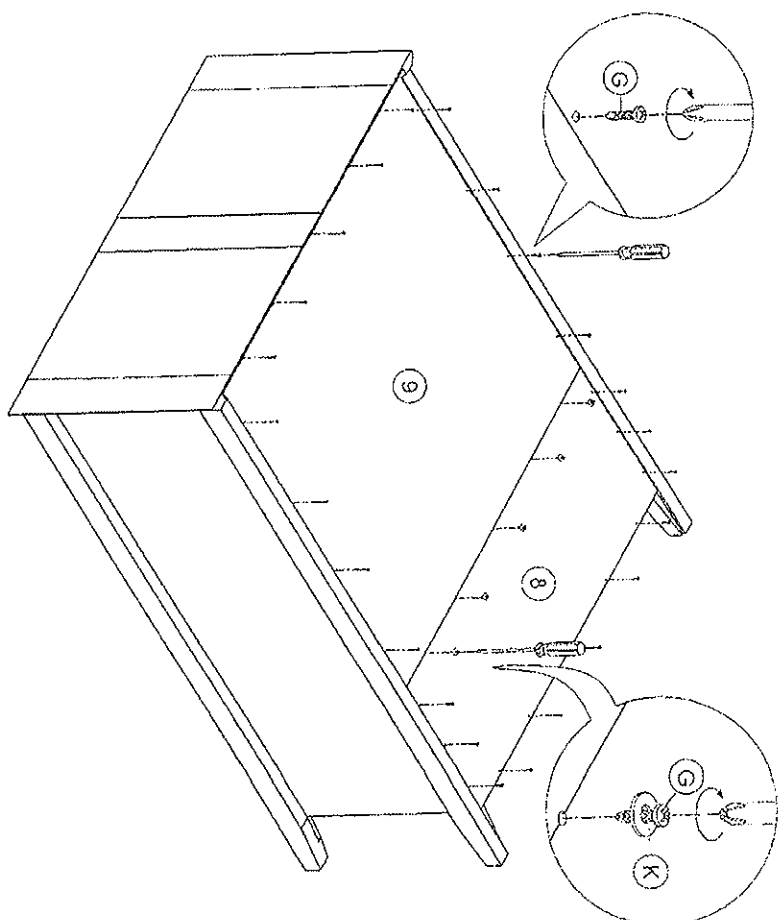
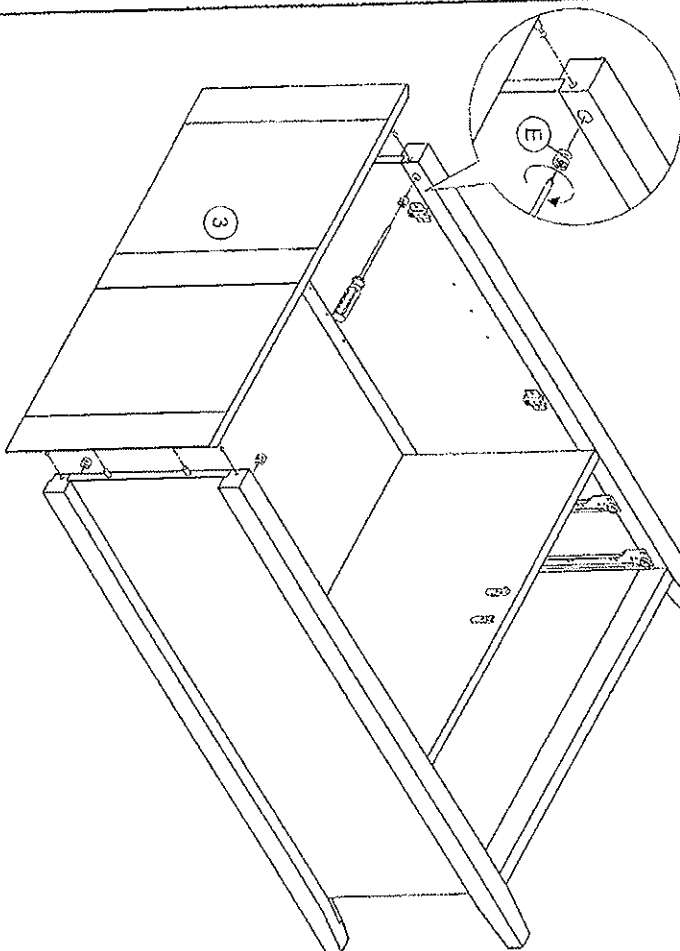

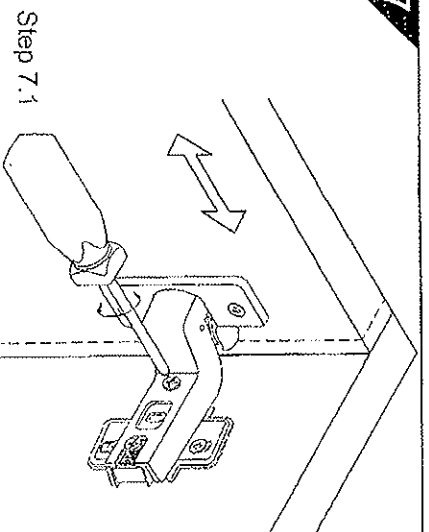
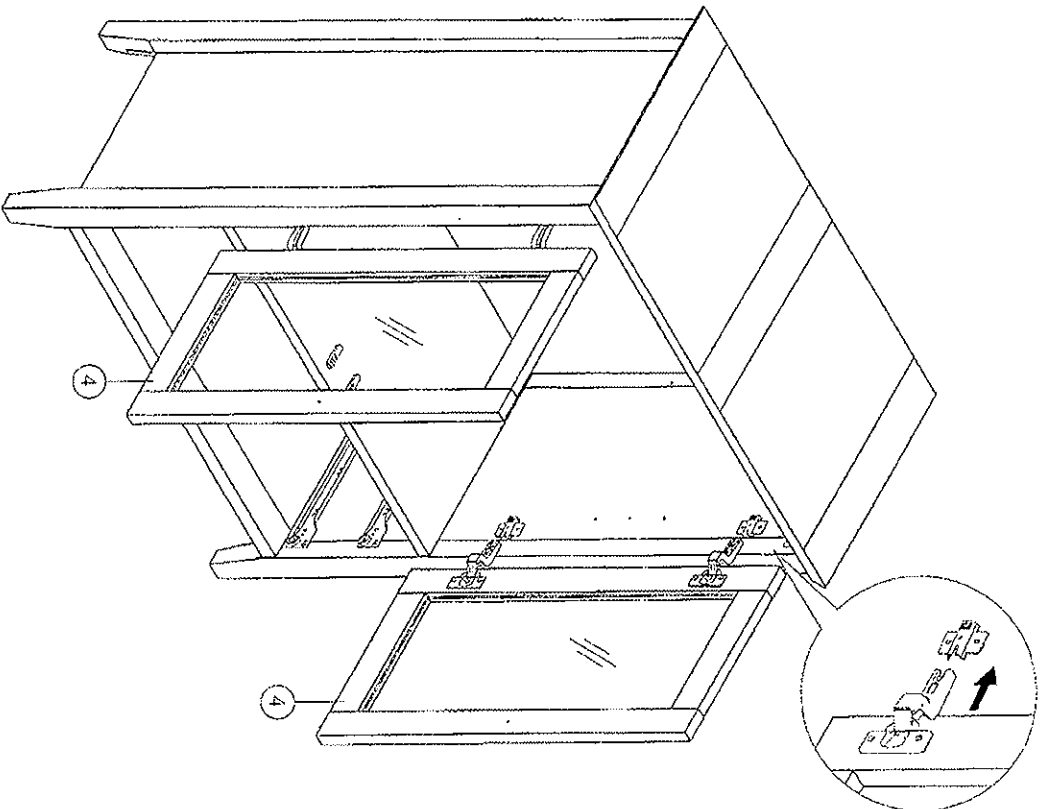

Step 7.1

**Lateral adjustment**  
by screw adjustment.

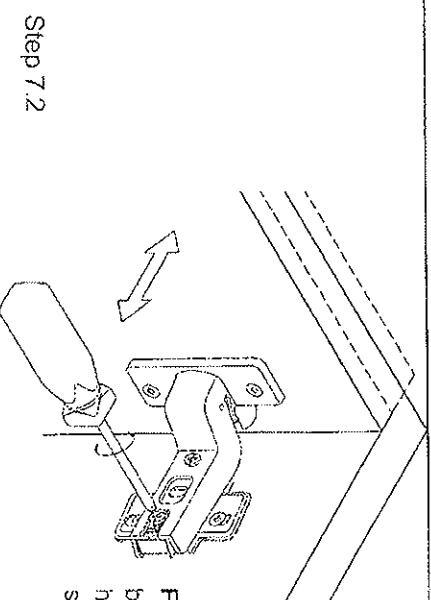

Step 7.2

**Front-to-back**  
by slackening the  
hinge-arm mounting  
screw.

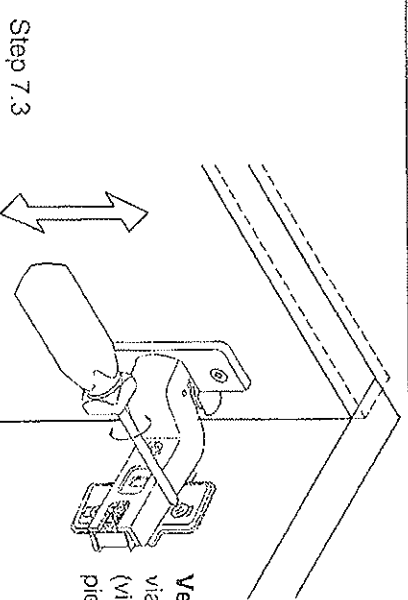

Step 7.3

**Vertical adjustment**  
via mounting plate  
(via slots or, if in two  
pieces, by screw)

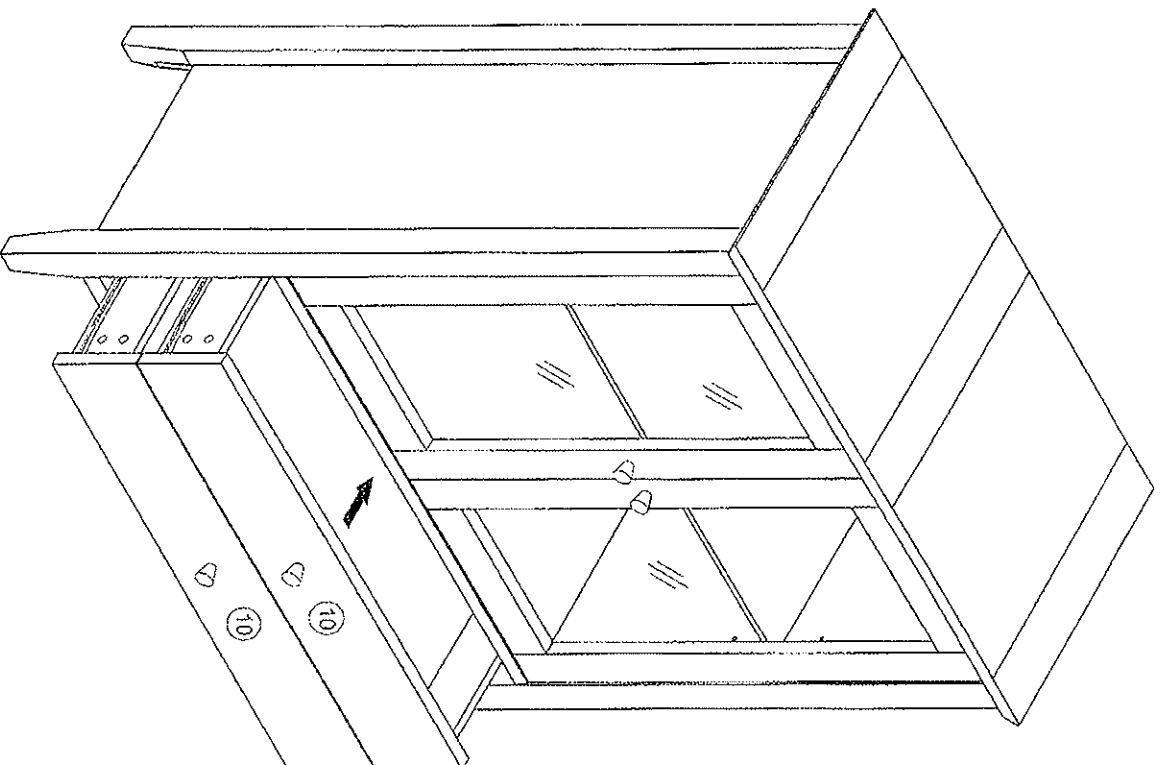
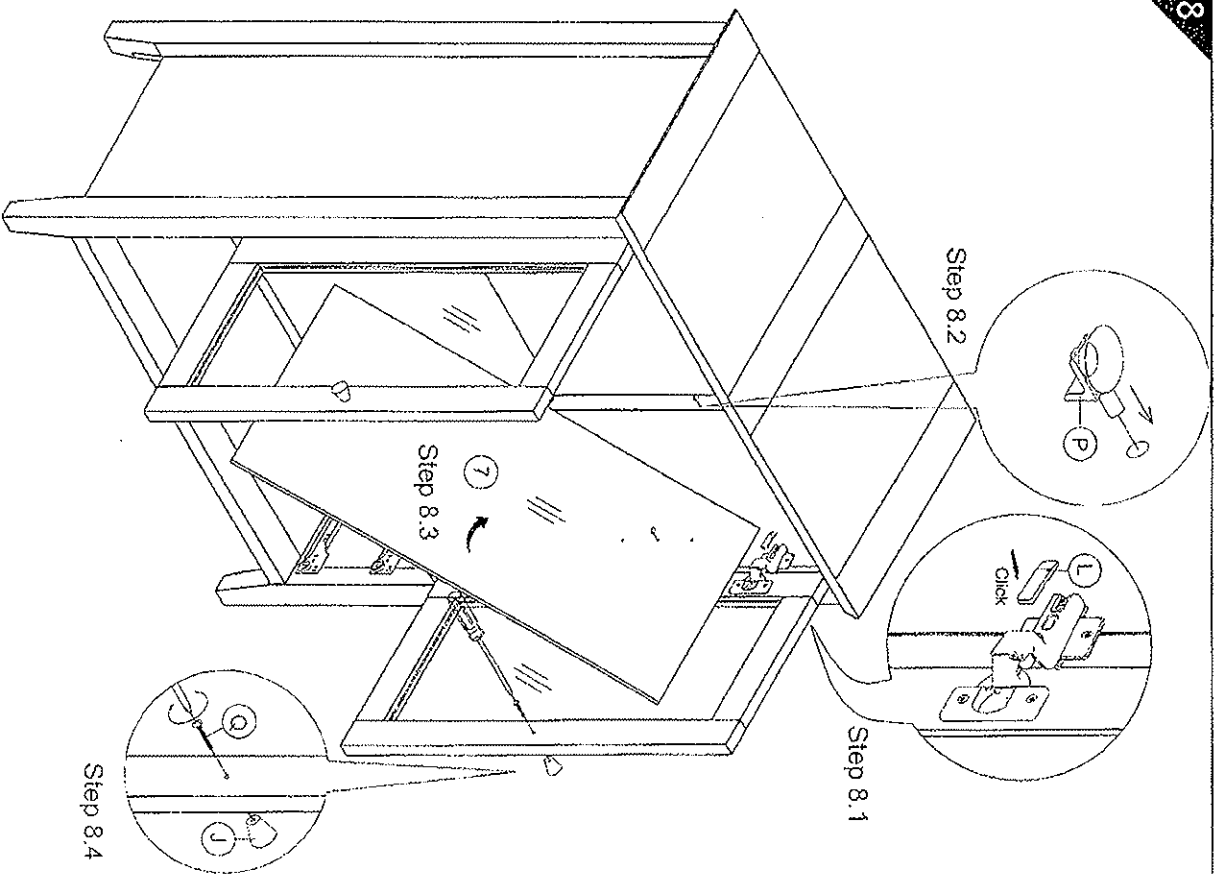

# ASSEMBLY INSTRUCTION DRAWER BOX ⑩

## PARTS:

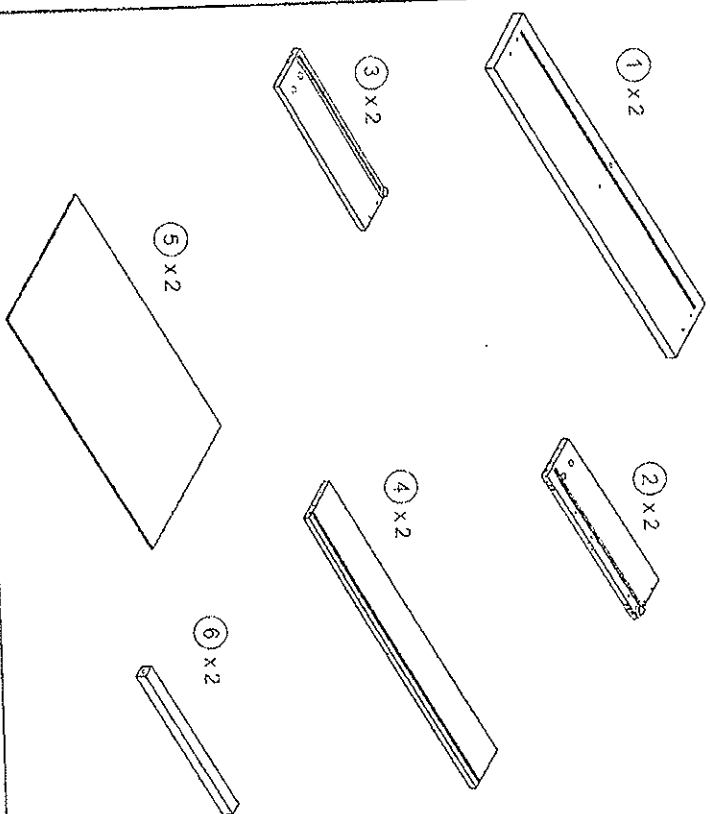

## HARDWARE

