

John Lewis

Jasper chair

Stock number: 811/12080

811/12082

811/22071

811/22072

Thank you for purchasing this chair. Please read the instructions carefully before use to ensure safe and satisfactory operation of this product

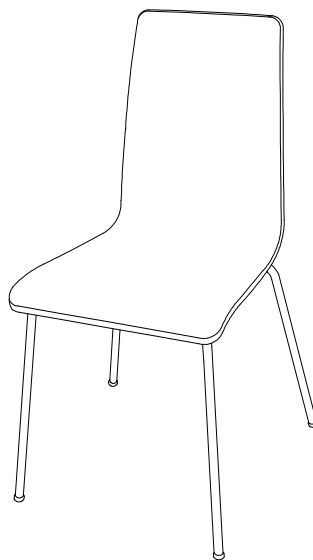

Pre-assembly preparation

Please ensure instructions are read in full before attempting to assemble this product

Necessary Tools

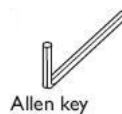

Please check the pack contents before attempting to assemble this product. A full checklist of components is given in this leaflet. If any components are missing, please contact the retailer from whom you bought this product..

This product is **HEAVY**, it should be assembled as near as possible to the point of use. **TAKE CARE WHEN LIFTING** to avoid personal injury and (or) damage to the product.

This product takes approximately **10 MINUTES** to assemble with **1 PEOPLE**.

The fittings pack contains **SMALL ITEMS** which should be **KEPT AWAY FROM YOUNG CHILDREN**.

Read this leaflet in full before commencing assembly.

Fittings and parts checklist

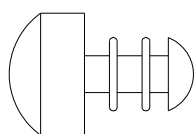

A x4pcs

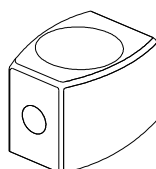

B x4pcs

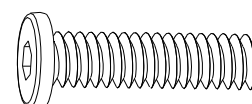

C x4pcs

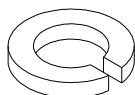

D x9pcs



E x1pcs



F x1pcs

Step by step assembly instructions

1

WARNING: Once chair is constructed ensure all screws and nuts are fully tightened before use

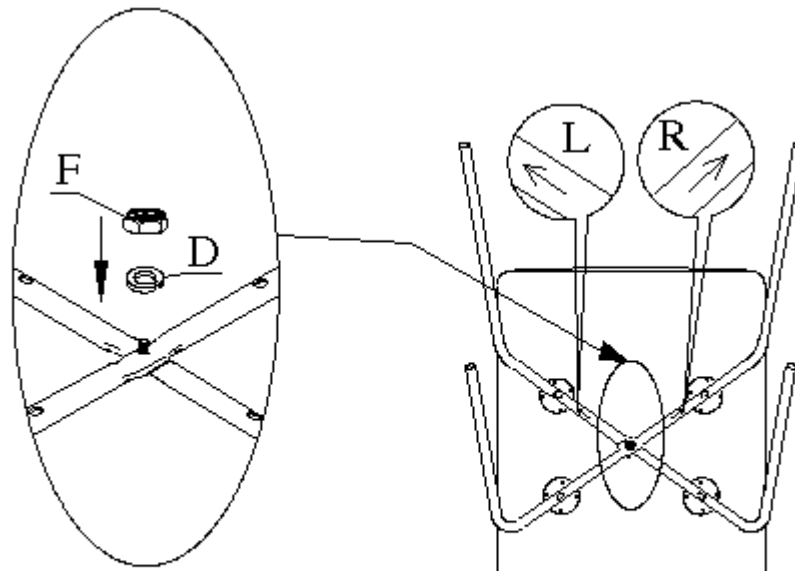

Fit item B before placing frames together

2

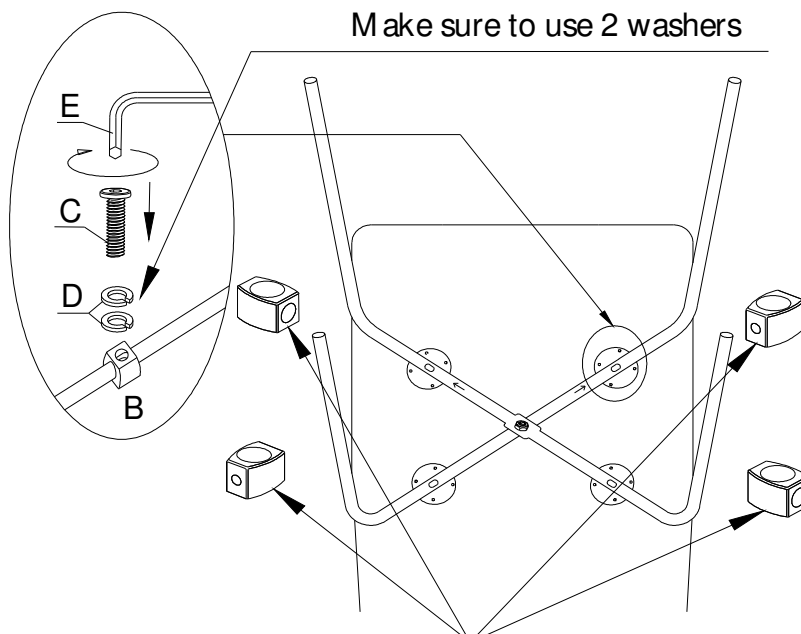

These four items (B) should be fitted during step 1

3

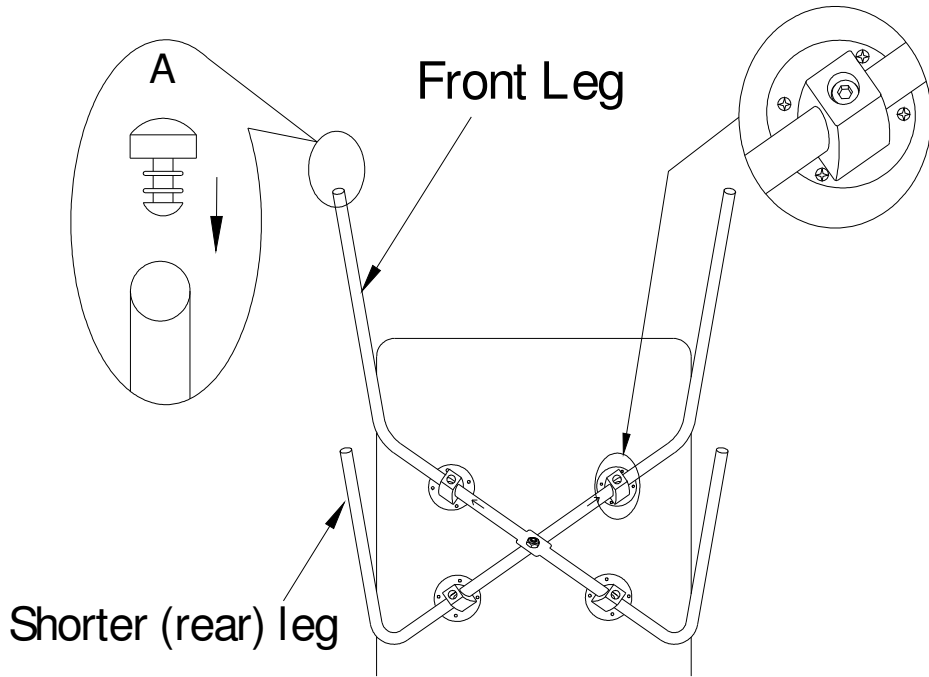

4

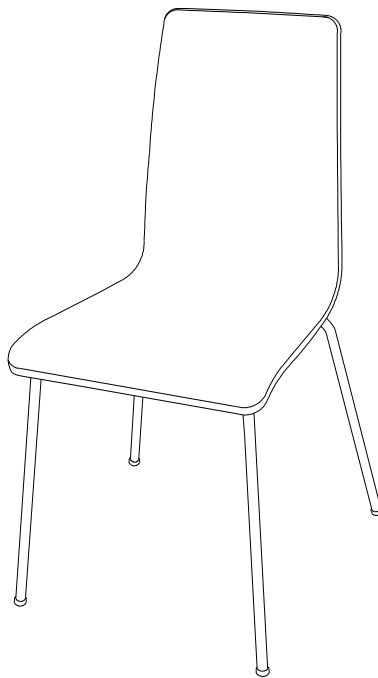

Care and Maintenance

This chair should be cleaned with a dry or damp soft cloth. Do not use abrasive cleaners, which may damage the surface of the product

Safety Instructions

Never tilt the chair. Ensure the chair is always placed firmly on the ground. Periodically check the tightness of all screws.

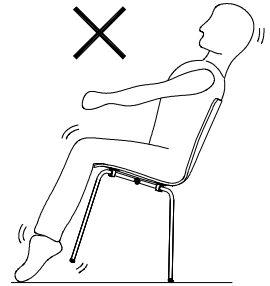

PLEASE KEEP THESE INSTRUCTIONS FOR FUTURE REFERENCE