

Car parking

The nearby Oracle, Queen's Road and Broad Street Mall car parks offer several thousand parking spaces.

Partnership card

At John Lewis we offer our own credit card, issued by John Lewis Financial Services Limited. To find out more about the benefits, please just ask a member of staff or visit our website on www.partnershipcard.co.uk/JL. Terms and Conditions apply.

John Lewis Insurance

We provide a range of insurance products that are designed to be with you when it matters most. For cover for your home, your car, your pet or even your holiday, you can be reassured we'll always be there for you. To see our full range of insurance products visit www.johnlewis.com/insurance

Toilets

Near Fashions on the First floor.

Catering

The Place to Eat on the First floor can seat 220 and serves freshly-prepared hot and cold meals, including vegetarian dishes, a children's menu, home-made cakes and pastries.

Facilities for disabled customers

Shopping in our department stores should be easy and convenient for all customers, with no exceptions. All our stores have accessible toilets and lifts, as well as a range of other services to help our disabled customers enjoy their shop. To find out what's available in John Lewis Reading please ask a member of staff or go online to, www.johnlewis.com/reading. You can also call us on 0118 957 5955, or Textphone 18001 + 0118 957 5955 (via Typetalk).

If you need this literature in an alternative format, please ask us.

You can find this information and lots more online at johnlewis.com

Shopping hours

Monday	9.30–6.00
Tuesday	9.30–6.00
Wednesday	9.30–6.00
Thursday	9.30–8.00
Friday	9.30–6.00
Saturday	9.00–7.00
Sunday	11.00–5.00
(Sunday browsing)	10.30–11.00

John Lewis
Broad Street
Reading RG1 2BB
Telephone 0118 957 5955
Fax 0118 952 5999
jl_reading@johnlewis.co.uk
johnlewis.com

John Lewis department stores SD53329 / 05.12



John Lewis
in store | online | mobile

John Lewis

Shopping at John Lewis Reading

Welcome to John Lewis Reading

We are part of the John Lewis Partnership and, like all John Lewis department stores, we have three guiding principles:

- To offer the widest possible choice under one roof
- To combine high quality with keen pricing
- To provide a high standard of service, with expert, helpful staff and a whole range of additional benefits and facilities.

About the John Lewis Partnership

There are John Lewis department stores throughout the UK from Aberdeen to Southampton – our first opened in Oxford Street in 1864. In 1929, the company became a profit-sharing democracy; every permanent member of staff is a Partner, benefiting from the success of the business. The Partnership also includes Waitrose food shops.

The widest possible choice

With around 80 types of television, hundreds of large electrical appliances and thousands of different furnishing fabrics – altogether we stock over 350,000 lines. From gloves to garden furniture, cots to computers, pots and pans to curtain poles, there's always a wide range to choose from, to suit most pockets.

Guarantees

John Lewis guarantees are among the best on the market, and are included at no extra cost. All our TVs come with a 5-year guarantee, while all computers and tablets, DVD Players, cameras and audio include a 2-year guarantee. Our John Lewis large kitchen appliances are guaranteed for 3 years, while all other large appliances are covered for 2 years.

Customer collections

Why not drop off your shopping as you go then pick it up when you're ready to leave, from Customer collections. Customer collections is located just off Menswear on the Ground floor and also in Mill Lane, just opposite the main Oracle multi-storey car park.

Standard delivery

When you spend over £50 we'll deliver for free. Spend less and standard delivery costs just £3. We'll deliver to the room of your choice, and remove any unwanted packaging for us to recycle responsibly.

Basement **B**
 Lower ground floor **LG**
 Ground floor **G**
 First floor **1**
 Second floor **2**
 Third floor **3**
 Seasonal*

Department listings

Babywear **1**
 Bathroom accessories **2**
 Beauty **G**
 Beauty retreat **LG**
 Beds and bedroom furniture **2**
 Blinds **2**
 Boyswear **1**
 Carpets, rugs and flooring **2**
 Children's shoes **1**
 Childrenswear **1**
 China and glass **B**
 Christmas shop* **B**
 Clocks **2**
 Clothingscare **B**
 Computers **G**
 Curtains **2**
 Customer collections **G**
 Cutlery **B**
 Electrical appliances (large and small) **B**
 Fashion accessories **G**
 Fashion fabrics **G**
 Fitted kitchens **B**
 Floor coverings **2**
 Frames **G**
 Furnishing fabrics **2**
 Furniture **2**
 Garden furniture* **B**
 Gift List **3**
 Gifts **G**
 Girlswear **1**
 Haberdashery and crafts **G**
 Handbags **G**
 Hosiery **G**
 Jewellery and watches **G**
 Kitchenware **B**
 Lighting **2**
 Linens **2**
 Lingerie **1**
 Menswear **G**
 Men's shoes **G**
 Mirrors **2**
 Nursery furniture and prams **1**
 Pictures **2**
 Schoolwear **1**
 Silverware **B**
 Sports clothing, shoes and equipment **G**
 Stationery **G**
 Sunglasses **G**
 Table linens **B**
 Toys and children's books **1**
 Travel goods **G**
 Women's fashions **1**
 Women's hats **G**
 Women's shoes **1**

BASEMENT

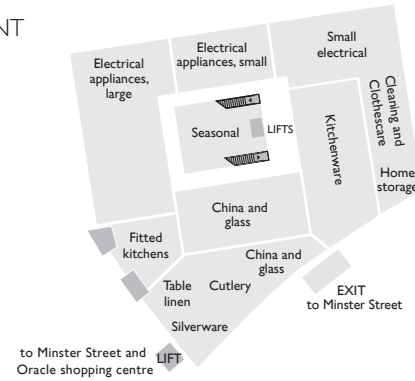

LOWER GROUND FLOOR

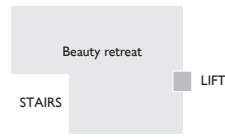

GROUND FLOOR



FIRST FLOOR



SECOND FLOOR



THIRD FLOOR

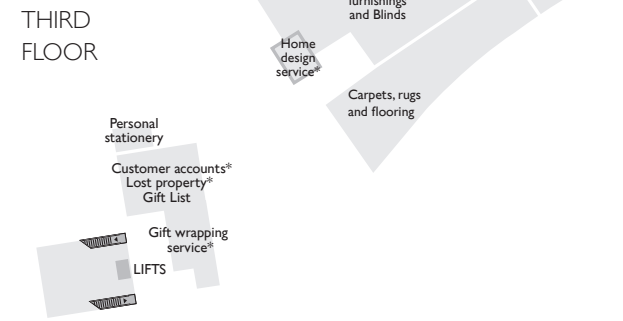

Services

Customer support
 Account enquiries **3**
 Customer collection **G**
 Customer services **3**
 Export enquiries **3**
 Lost property **3**
 Parent's room **1** ♿
 Toilets ♿♿♿
Gift services
 Gift list **3**
 Gift wrapping **3**
 Personalised stationery **3**
Restaurants
 The Place to Eat **1**

Experts on Hand

Fashion
 Beauty treatments **LG**
 Fashion advice **1**
 Lingerie fitting **1**
Home design and interiors
 Bespoke furnishings and furniture **2**
 Carpets and flooring **2**
 Fitted bedroom furniture **2**
 Home design service **2**
 Kitchen design and fit **B**
 Lighting installation **2**
Nursery
 Children shoe fitting **1**
 Nursery advice **1**
Technical support
 Appliance removal and installation **B**
 Computer support and set up **G**
 TV installation and set up **G**