

701 68007 Emilia Crystal Drum

Thank you for purchasing this pendant. Please read the instructions and warnings carefully before use to ensure safe and satisfactory operation of this product.

Warnings.

- This product is Class II.
- It is recommended that this fitting is installed by a qualified electrician.
- This fitting should be fitted in accordance with IEE Regulations and the Building Regulations.
- To prevent electrocution, switch off at the mains supply before installing or maintaining this fitting. Ensure other persons cannot restore the electricity supply without your knowledge.
- If you are in any doubt, please consult a qualified electrician.
- If replacing an existing fitting, make a note of the connections.
- Always use the correct type and wattage bulb. Never exceed the wattage stated.
- When changing a bulb, always switch off at the mains and allow the old bulb to cool down before handling. Dispose of used bulbs carefully.
- The bulb and surrounding parts can become extremely hot during use.

Instructions.

1. Ensure the house electricity supply is switched off at the fuse board.
2. If removing an existing fitting, note down all wiring connection
3. Ensure that the bracket (supplied) is fixed to a wooden joist, or use a suitable fixing to the pendant which will support the weight of the fitting.
4. Connect cables or terminals as shown below.

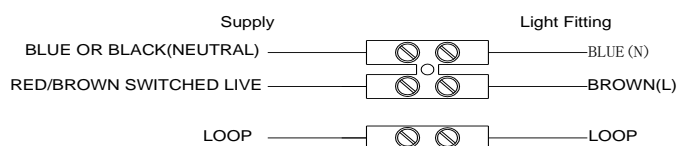

Check all wires are tight in the terminal block, and no loose strands are left out. Cover with insulating tape.

NB There may also be a loop-in/loop-out connection involved, in which case a forth connector should be used.

5. Push up pendant plate and secure.
6. Fit the bulb type / wattage as indicated on the luminaire. The wattage indicated must not be exceeded.
7. Switch on the electricity supply at the fuse board.

Please retain this information leaflet for future reference.



INSTALLATION INSTRUCTION

Item No.: CFH309116/05/R/JLP

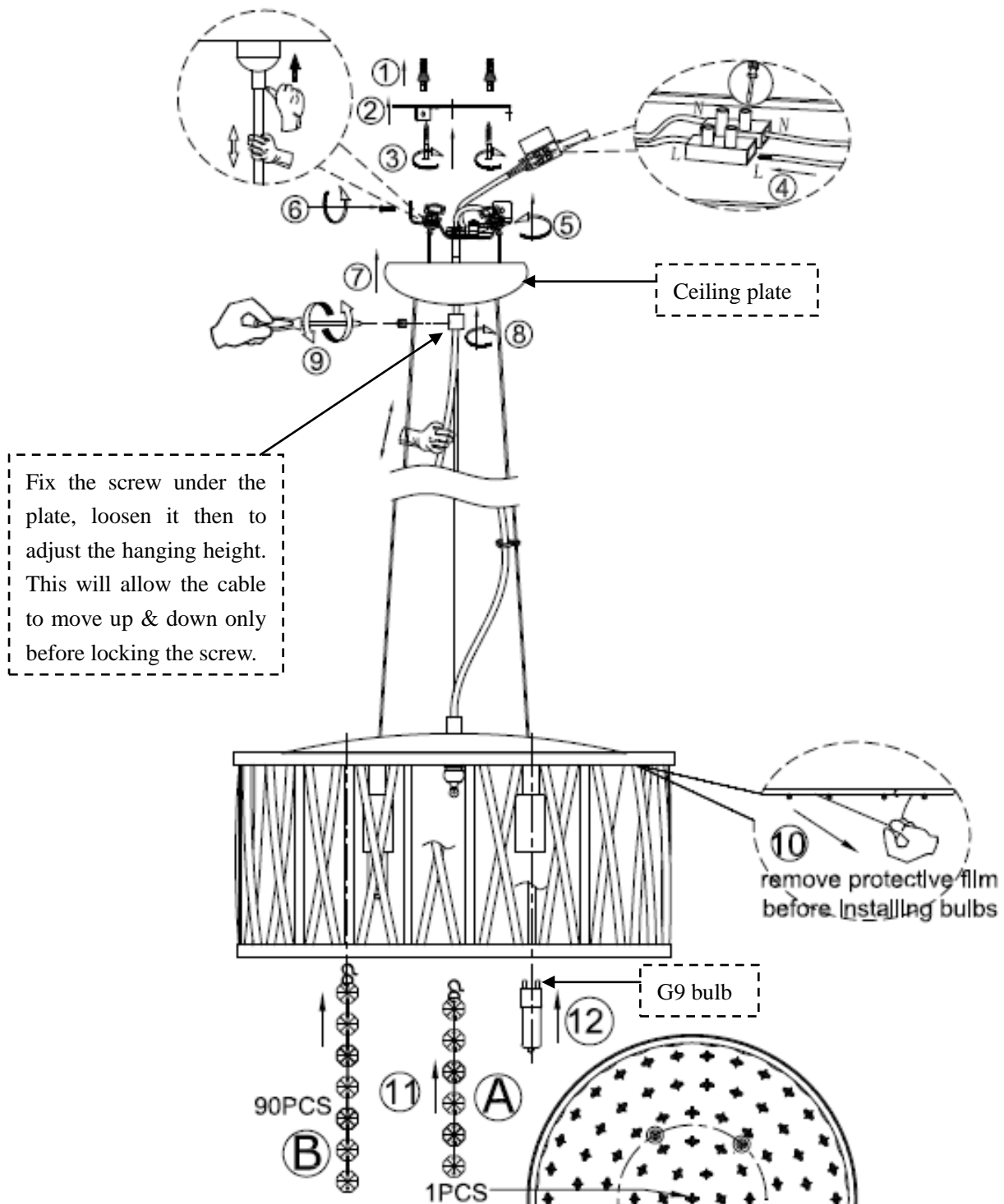

FEATURE

- 240V ~ 50Hz

- Lamp Type: G9 5×Max 33W

The lamp is for indoor use only.

If in doubt, consult a qualified electrician or contact your retail outlet.

Ensure that you always install the fitting to the relevant regulations.

Certain regulations indicate that lighting fittings should be installed by a qualified electrician.