

**Recommended bulb:**

2 x 28W G9 eco halogen capsule bulb  
Bulbs not included

**Specifications:**

Max. power: 33W  
Voltage: 220-240V~50/60Hz  
Weight: 1.6kg



Please retain these instructions for future reference.

This symbol  indicates that this product should not be treated as normal household waste and it should be recycled. John Lewis do not operate instore take back, but as members of the Distributor Take Back scheme have funded the development and upgrade of recycling facilities across the UK. Please take it to your nearest collection facility or for further details contact your local council or visit [www.recycle-more.co.uk](http://www.recycle-more.co.uk).

We have taken great care to ensure that this product reaches you in perfect condition. However, should any parts be damaged or missing please e-mail [lightingparts@JLPspares.co.uk](mailto:lightingparts@JLPspares.co.uk)

**Trouble Shooting:**

Why is the light not working when switched on?

Check your power supply is switched on

John Lewis Partnership  
171 Victoria Street  
London SW1E 5NN  
[johnlewis.com](http://johnlewis.com)

Made in China

# John Lewis User manual

## Emilia Large Table Lamp

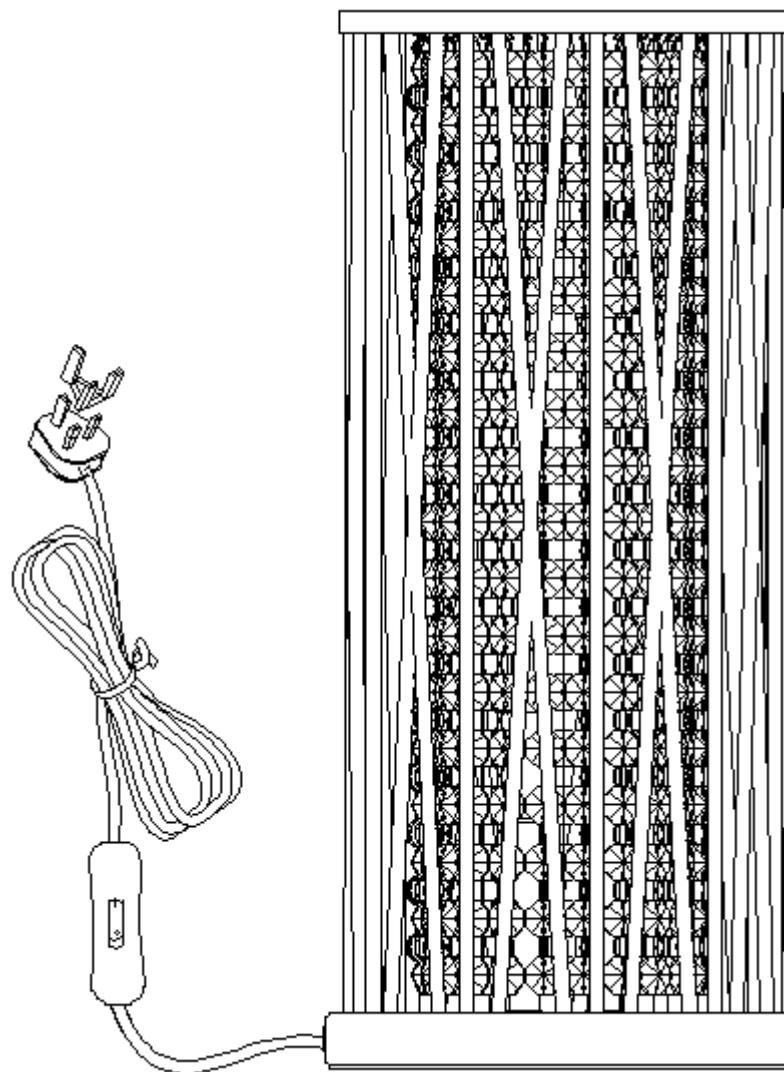

Thank you for purchasing this Emilia large table lamp. Please read the instructions carefully before use to ensure safe and satisfactory operation of this product. Please keep these instructions for future reference.

Warnings!

This fitting should be fitted in accordance with IEE Regulations and the Building Regulations.If in any doubt, or where required by law, consult a competent person who is registered with an electrical self-certification scheme. Further information is available online or from your Local Authority.

To prevent electric shock switch off at the mains supply before installing or maintaining this fitting. Ensure other persons cannot restore the electricity supply without your knowledge.

If you are in any doubt, please consult a qualified electrician.

Always use the correct type and wattage bulb. Never exceed the wattage stated.

Do not cover. Keep away from curtains, bedding etc.

Always route mains cable so it does not present a hazard (entrapment, tripping etc.) UNWIND THE CABLE FULLY; ensure that there are no twists or snags in the cable. Plug into the mains supply; switch on using the inline cord switch provided.

If moving this lamp, always carry by holding the stand part(and not the bubble glass.)

**CAUTION! The bulb and surrounding parts can become hot during use.**

Care Instructions

Indoor use only.

Replace bulbs from John Lewis or established brand of the same type and compatibility.

Recommend the fitting should be cleaned with a soft dry cloth.

Parts list

	Parts list	Qty
A		31

Assembly

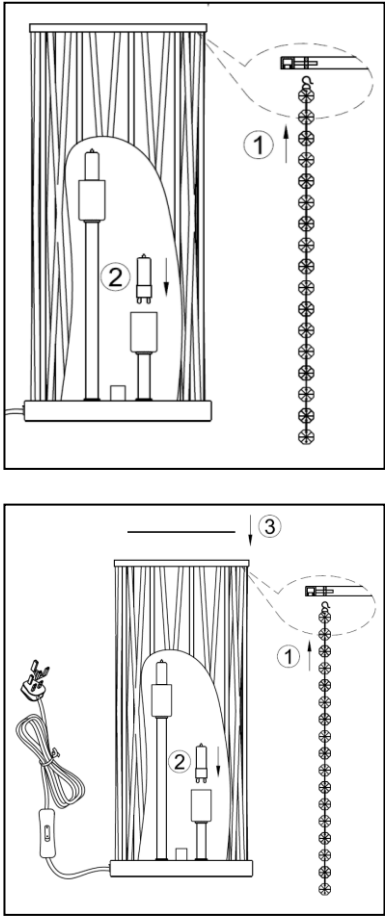

- Ensure the house electricity supply is switched off at the fuse board.
- Step 1  
Carefully unpack the carton, making sure all parts are present before assembly. Place lamp on a flat surface.
- Step 2  
Attach crystal chains to main frame, then Fit bulb to the lamp holder. **The maximum power indicated must not be exceeded.**
- Step 3  
Attach the glass cover, then switch on the electricity supply at the fuse board. Insert the plug into the power supply and turn on the switch.