

John Lewis

User manual

Lucia Chandelier

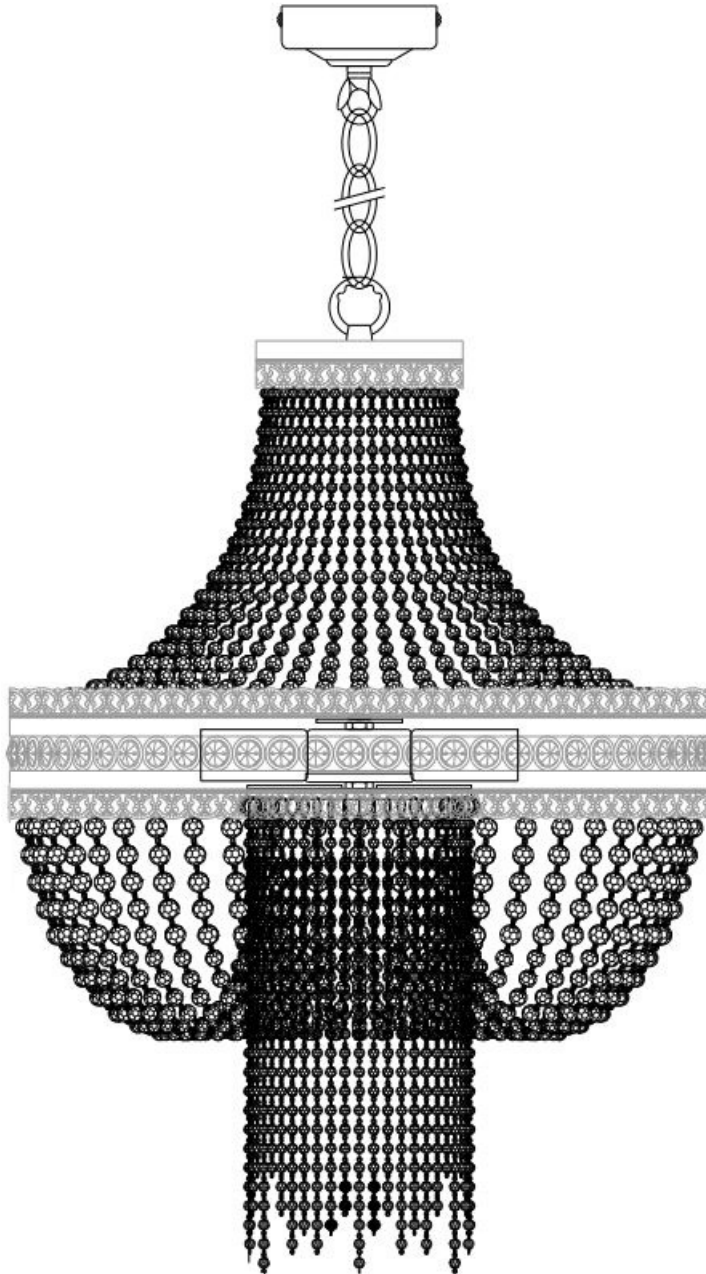

Thank you for purchasing this Lucia chandelier. Please read the instructions carefully before use to ensure safe and satisfactory operation of this product.

Warnings!

- ❖ For your safety, this product must be installed in accordance with local Building Regulations. If in any doubt, or where required by the law, consult a competent person who is registered with an electrical self-certification scheme. Further information is available online or phone your Local Authority.
- ❖ To prevent electric shock, switch off the mains supply before installing or maintaining this product. Ensure other persons cannot restore the electricity supply without your knowledge.
- ❖ Always use the correct bulb type with the correct wattage as indicated in the specification table. Never exceed the Max. power rating. When changing a bulb always switch off at the mains first and allow the bulb to cool down before handling. Dispose of used bulbs carefully. The bulb and surrounding parts can become extremely hot during use.
- ❖ This product is Class I = $\frac{1}{\text{I}}$ and should be fitted to a lighting Supply (with earth) protected by a 5 amp fuse or equivalent circuit breaker.
- ❖ For indoor use only.

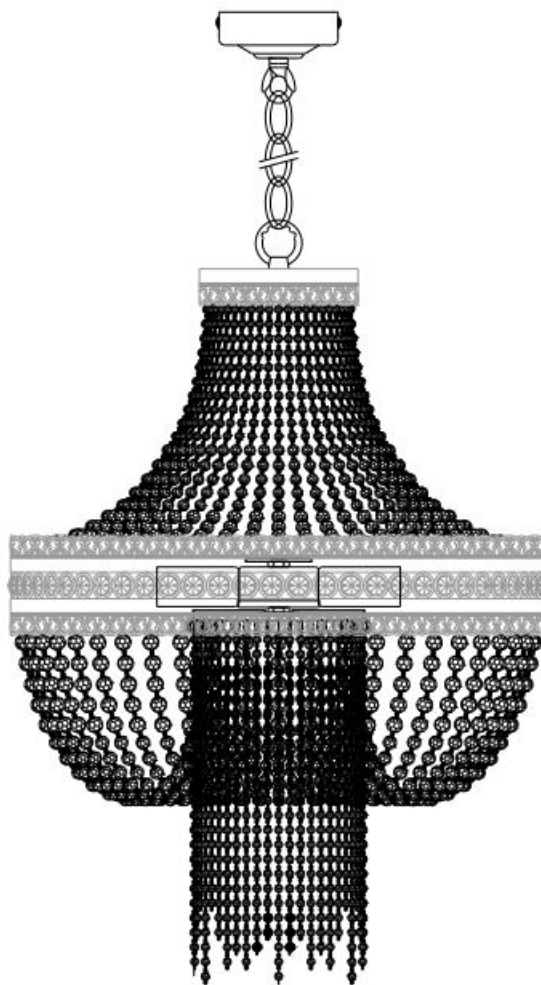
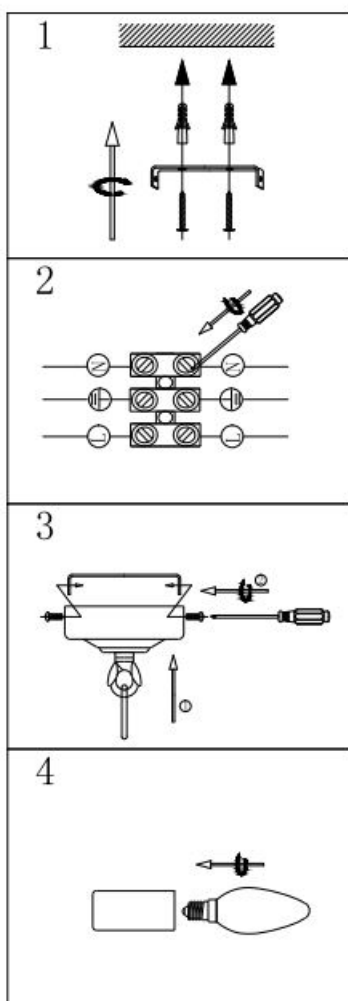

Assembly

Never install your appliance on a wet, freshly painted or plastered surface.

Ensure the house electricity supply is switched off at the fuse box.

If removing an existing fitting, note down all wiring connections.

Follow the diagram below for fixing detail.

Check the fixings will not touch any existing wiring before drilling and attaching the light to the wall.

Ensure you thread the wall wires through the black insulating tube fixed to the appliance.

1. Ensure the house electricity supply is off at the fuse board.
2. If removing an existing fitting, first note down all wiring connections.
3. Remove mounting bracket from fitting by removing the retaining screws and washers, retain for later.
4. Using the mounting bracket as a template, mark and then drill the fixing holes in the ceiling (ensure holes are drilled into a secure joist). **Take care not to damage wiring.**
5. Attach mounting bracket to the mounting surface using suitable fixings. Do not attach fitting to mounting bracket at this stage. Make sure no wires are trapped in the process.
6. **This fitting is height adjustable at point of installation only. No attempt must be made to adjust the height once it has been attached to the ceiling. If adjustment is required at a later date the fitting must be isolated from the mains and removed from the ceiling first.** Using two pairs of pliers carefully open the chain links and remove the required number of links. Close the links. Note: Cloth should be used between the jaws of the pliers to protect the decorative finish. Pull any excess cable through the ceiling cup.
7. **IMPORTANT** ensure the chain is supporting the weight of the fitting and not the electrical cable.
8. Lever open the terminal block box cover with a screwdriver then feed supply cable through rubber sleeving and make electrical connections as follows:
 - Connect supply live (normally brown or red) to fitting live (marked "L") on the terminal block.
 - Connect supply neutral (normally blue or black) to fitting neutral (marked "N") on the terminal block.
 - Connect supply earth (normally green/yellow or unsheathed) to earth (marked "⏚") on the terminal block.
9. Excess cable must be carefully located inside ceiling cup or within the ceiling void. Carefully offer fitting over mounting bracket then secure in place with the screws and washers removed earlier.
10. Fit the bulb, type and wattage as displayed on the fitting. **The stated wattage must not be exceeded.**

Once installation is complete, the house electricity may be restored at the fuse box.

Care instructions

Wipe clean with a clean dry cloth, when product is switched off and has cooled down.

Recommended bulb

3 x 28W E14 (SES) eco halogen candle bulb

Or

3 x 9W energy saving spiral bulb

Specifications

Max. Power: 40W

Voltage: 230V, 50Hz

Weight: 4.1kg

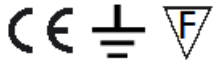

Please retain these instructions for future reference.

John Lewis Partnership
171 Victoria Street
London SW1E 5NN
johnlewis.com

Made in China

Issue 1 10/16