

Recommended bulb (not included)

1 x 6W

ES or BC LED Energy Efficient Classic GLS

or

1 x 28W

ES or BC Eco Halogen GLS

When changing a bulb, always switch off at the mains and allow the bulb to cool before handling. Dispose of used bulbs carefully. Do not exceed the rated power stated or use a different shape bulb from that indicated on the fitting.

Specification

Max. Power: 40W

Voltage: 240V, 50Hz

IP Rating: IP20

Weight: 0.5kg



Please keep these instructions for future reference.



This symbol  indicates that this product should not be treated as normal household waste and it should be recycled. John Lewis do not operate instore take back, but as members of the Distributor Trade Back scheme have funded the development and upgrade of recycling facilities across the UK. Please take it to your nearest collection facility or for further details contact your local council or visit www.recycle-more.co.uk.

We have taken great care to ensure that this product reaches you in perfect condition. However, should any parts be damaged or missing please contact the Product Helpline on (01202) 690945.

John Lewis Partnership
171 Victoria Street
London SW1E 5NN
johnlewis.com

Made in China

John Lewis

User manual

Nate

Pendant shade

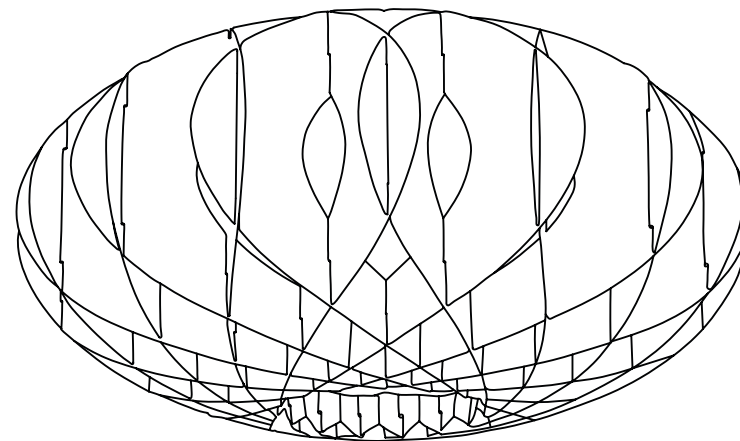

05/10/2017

Thank you for purchasing the Nate pendant shade. Please read the instructions carefully before use to ensure safe and satisfactory operation of this product.

Warnings!

Please read these instructions carefully before commencing any work.
For your safety, always switch off the supply before changing lightbulbs, cleaning or removing shades. Always take care when handling lightbulbs to avoid injury in case of breakage. Never use a higher wattage bulb than is recommended as this may over heat and damage the shade.

Parts List

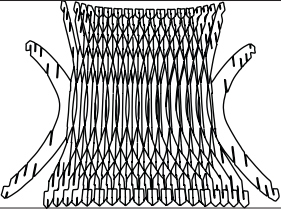
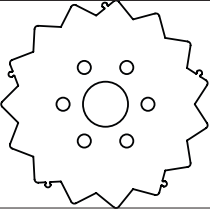
Shade		I	Gimbal		I
-------	---	---	--------	---	---

Assembly

Refer to drawing overleaf. Carefully unpack the carton, making sure all the parts are present before assembly.

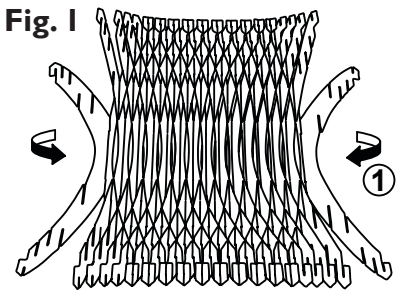

Step 1
See Fig. 1. Holding on to the ends of the shade, pull the shade into a spherical shape.

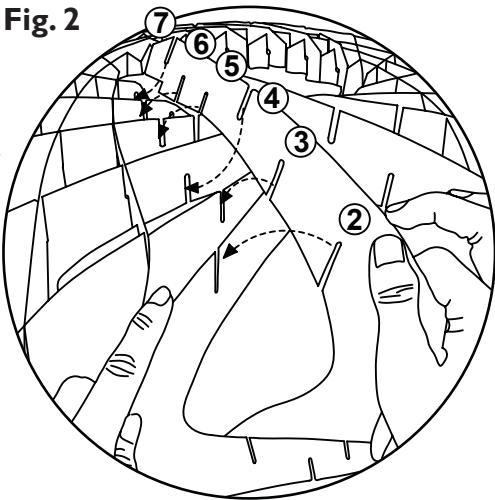

Step 2
Starting with the leading edge of the shade (point 2), using the numbering and arrow direction in Figure 2 as a reference, weave one side of the shade into the other, working your way to the inside edge of the shade. Repeat this action until all slots of the shade are located into each other.

Step 3
Flip the shade over, and repeat Step 2 until the final form is achieved.

Fig. 3

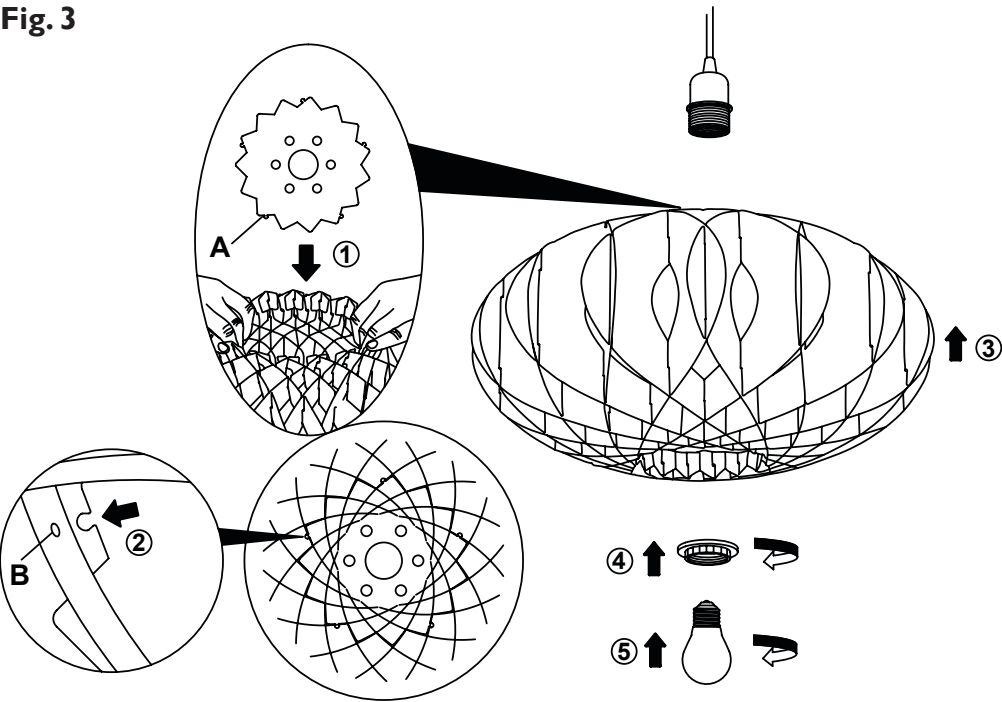

Step 4
See Fig. 3 Carefully open top of shade and place gimbal insert inside. Locate tabs 'A' of gimbal and insert into shade slots 'B', as shown at point 2.

Step 5
Locate the shade over the lampholder and secure in place with the shade ring. Fit the recommended bulb. Your pendant shade is now ready for use.

Care instructions

We recommend cleaning with a soft dry cloth. Do not use abrasive materials as these will damage the finish.