

John Lewis

Instruction manual

Aria DAB/FM radio

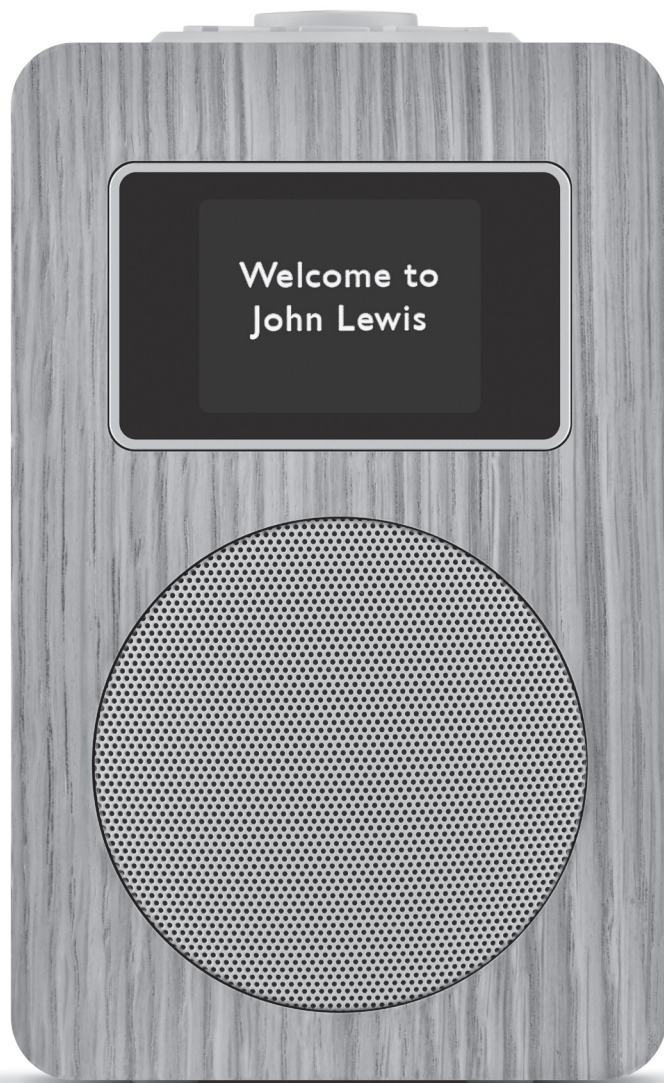

Contents

3	Important safety information
4	Packing list
4	Your Aria DAB/FM radio
5	Connectors
6	5 Steps guide to getting started
7	Audio modes
7	Presets
8	Now playing information
8	DAB menu
10	FM menu
11	Bluetooth
11	Aux-In mode
12	Alarms
13	System settings
13	Equaliser
14	Time/Date
14	Backlight
15	Language
15	Factory reset
16	Troubleshooting and error messages
17	Troubleshooting guide
17	Technical Specifications

Important safety information

Thank you for purchasing this John Lewis DAB/FM radio.

Hereby, John Lewis declares that the radio equipment type Aria radio is in compliance with Directive 2014/53/EU. The full text of the EU declaration of conformity is available at the following internet address:
<https://www.johnlewis.com/content/declaration-of-conformity>

Please read the instructions and warnings carefully before use, to ensure safe and satisfactory operation of this product.

It is most important this instruction leaflet be retained with the product for future reference. These warnings have been provided in the interest of safety. You **MUST** read them carefully before using the appliance. If you are unsure of the meanings of these warnings contact the John Lewis store from which you purchased the appliance.

- This appliance can be used by children aged from 8 years and above and persons with reduced physical sensory or mental capabilities or lack of experience and knowledge if they have been given supervision or instruction concerning use of the appliance in a safe way and understand the hazards involved. Children shall not play with the appliance.
- To protect against fire, electric shock and injury to persons DO NOT IMMERSE CORD, plug or base unit in water or other liquids.
- Unplug from the mains when not in use, before putting on or taking off parts and before cleaning.
- Do not operate any appliance with a damaged cord or plug, or after the appliance malfunctions or has been damaged in any manner. Return the appliance to the nearest John Lewis store.
- Do not let power cord hang over edge of table or counter, or touch hot surfaces.
- In the event of a fault, contact your nearest John Lewis store. No repair should be attempted by the consumer.
- Do not use the appliance for anything other than intended use.
- For household use only, do not use outdoors.
- Save these instructions for future reference.

Warning! Polythene bags over the product or packaging may be dangerous. To avoid danger of suffocation, keep away from babies and children.

Packing list

- 1 Aria radio
- 1 DC 9V 1.5A power adapter
- 1 Instruction manual

Your Aria DAB/FM radio

- Multi-function 'Navigation' dial and 'Select' button
 - Press once to turn ON
 - Long press to turn OFF
 - When audio is playing, rotate to change volume
 - When audio is playing, press once to mute audio
 - When in a menu, rotate to navigate, press once to select option
 - When alarm is sounding, press once to SNOOZE
- Source button - Press once to enter AUDIO SOURCE MENU
- Presets
- Info
- Previous track/Tune - button
- Next track/Tune + button
- Play/Pause button
- Menu/Back

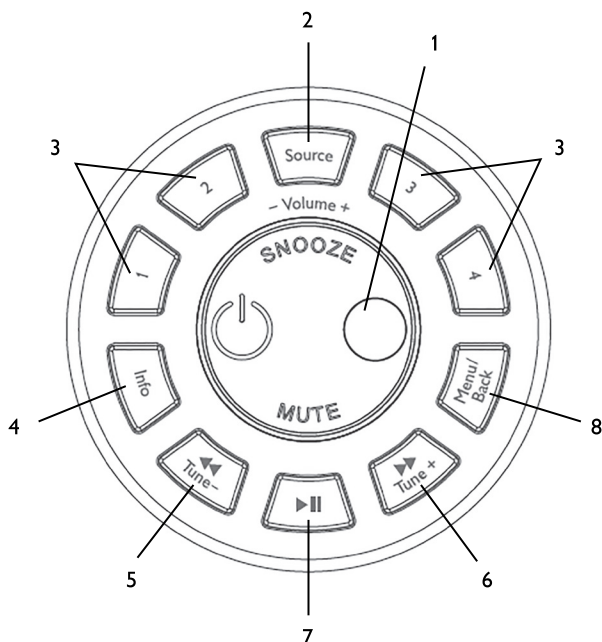

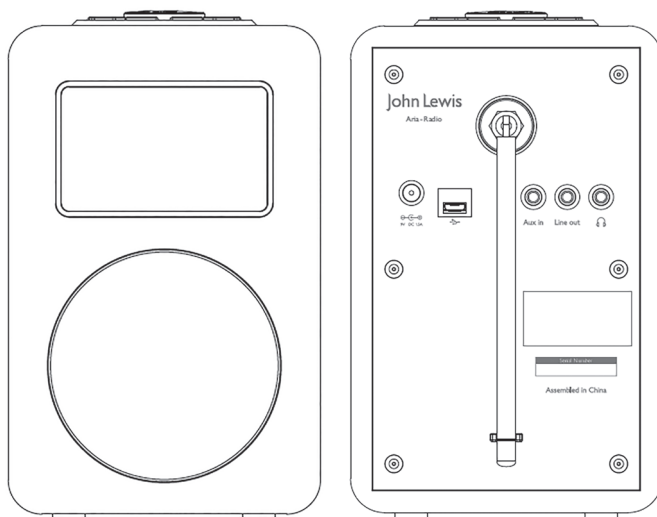

Connectors

As shown above, Aria has the following connectors (from left to right):

- DC power in (9V)
- USB for software update (service centre use only)
- Aux-In (to connect external media)
- Line out (to connect to an external amplifier)
- Headphones out

5 Steps guide to getting started

- 1 Place Aria on a suitable shelf or table.
- 2 Extend the telescopic antenna.
- 3 Connect the power adapter between Aria and the mains supply and press the '⏻ / Volume' dial to turn radio on.

For DAB

- 1 Product defaults to DAB mode.
- 2 If this is the first time you are using the radio, it will automatically start scanning. This may take a few minutes - previously-selected station or first station on the station list will automatically play.
- 3 To change station, press 'Tune +' button and use 'Navigation' dial to choose a radio station, press dial to select.
- 4 Adjust volume using '⏻ / Volume' dial, turn anticlockwise to decrease and clockwise to increase volume.

For FM

- 1 Press 'Source' button to enter Audio Source Menu and use/rotate 'Navigation' dial to select FM.
- 2 To automatically scan for station, long press 'Tune +' or 'Tune -' button.
- 3 To manual tune in 0.05MHz increments press 'Tune +' or 'Tune -' button.
- 4 Adjust volume using '⏻ / Volume' dial, turn anticlockwise to decrease and clockwise to increase volume.

Note: During the scanning, the sound will be muted automatically.

For Bluetooth

- 1 Press 'Source' button to enter Audio Source Menu and use/rotate 'Navigation' dial to select Bluetooth.
- 2 Radio TFT displays 'Bluetooth pairing' Activate your Bluetooth device and select the search mode.
- 3 'JL Aria' will appear on your Bluetooth device. Select it and enter '0000' for the password if necessary.
- 4 Your radio with display \ BLUETOOTH connected
- 5 Press '◀◀', '▶▶' or '▶▶▶' button for music playback.

Note: The unit will automatically switch to standby mode after 10 minutes if the source device is disconnected, switched off or the volume is too quiet.

Audio modes

DAB

DAB radio mode receives DAB/DAB+ digital radio and displays information about the station and programme/track as broadcast.

To enter DAB mode, press 'Source', use the 'Navigation' dial and 'Select' button to choose DAB from the icon menu.

Scanning for stations

The first time you use Aria, or if the station list is empty, the radio automatically performs a full scan to see what stations are available.

You may also need to start a scan manually to update the list of stations for one of the following reasons:

- New stations may become available from time to time.
- If reception was not good for the original scan (for example the antenna was not up), this may result in an empty or incomplete list of available stations.

To do a full scan

Select Menu > Full scan. Once a scan is complete, the radio returns to playing the previously-selected station or first station on the station list.

To remove stations that are listed but unavailable

Select Menu > Prune invalid.

Presets

Aria has 10 preset stores for DAB stations. Presets 1-3 have dedicated buttons, presets 4-10 are within the on-screen menu.

To store preset 1, 2 or 3

Press and hold the preset 1, 2 or 3 buttons until the display shows the text 'preset saved' with a green tick icon.

To store preset 4-10

Press and hold preset button 4+.

The display will show a list of the Preset stores numbered 1 to 10 these are displayed as either 'Empty' or with the currently stored station name. Use the 'Navigation' dial to choose a preset memory then press 'Select' to store the currently-playing station. After confirming the preset station is stored the display reverts to the Now playing screen.

To recall preset 1, 2 or 3

Press preset button 1, 2 or 3. This will play the radio station stored in preset 1, 2 or 3.

To recall a preset 4-10.

Press preset button 4+.

The display will show a list of the presets stored number 1-10.

Use the 'Navigation' dial to choose a preset and press 'Select' to play that station.

Now playing information

While a station is playing, the screen shows its name and DLS (Dynamic Label Segment) information broadcast by the station such as programme name, track title and contact details.

Press **Info** to cycle through

- Programme type
- Ensemble name
- Channel number/frequency
- Signal strength
- Power status (Mains)
- Date

Note: DL Plus presents additional information that can be broadcast by stations and stored temporarily on your radio.

DAB menu

- Station list
- Full scan
- Manual tune
- Prune invalid
- DRC
- System settings

Station list

All available DAB stations will be listed here. Use the 'Navigation' dial and 'Select' button to choose a radio station.

Note: If there is a question mark before the name of the radio station that means that station is not available in your current location. See Prune invalid on page 9.

Full scan

Press **Menu** > **Full scan** to scan the airwaves of your location for all available DAB radio stations.

Manual tune

As well as the normal method of scanning, you can also manually tune to a particular channel/frequency. This can be useful for adjusting your antenna to achieve the best possible reception.

To manually tune

Press **Menu** > **Manual tune**

Then use the 'Navigation' dial and 'Select' button to choose a particular channel/frequency.

The display shows a live indication of the received signal strength on the selected frequency.

Adjustments to your antenna will be manifested in the received signal strength displayed.

Note: The division in the signal strength bar indicates the audio quality threshold – if the signal strength, as indicated by the solid rectangles, falls below this threshold the audio quality will deteriorate.

When a channel/frequency is selected Aria also scans for any DAB stations on the selected frequency and updates the station list with any new stations found. To listen to any stations found, return to the Now playing screen and select the required station from the station list as normal.

Prune invalid

If a station is not available in your current location a '?' will appear before the name of the station as shown in the 'station list'.

Prune invalid will remove these stations and only leave ones that are available at your current location.

Press Menu > Prune invalid > YES

Dynamic range compression (DRC)

This function reduces the difference between the loudest and quietest audio being broadcast.

Effectively, this makes quiet sounds comparatively louder, and loud sounds comparatively quieter.

Note: DRC only works if it is enabled by the broadcaster for a specific station.

To change the DRC setting

Select Menu > DRC > The options available are: DRC high | low | off.

System settings

You can access system settings from all audio settings menus.

For more information see page 13.

FM

FM radio mode receives analogue radio from the FM band and displays RDS (Radio Data System) information about the station and show (where broadcast).

To enter FM mode, press 'Source', use the 'Navigation' dial and 'Select' button to choose FM from the icon menu.

Selecting stations

The first time you select FM radio, Aria is set to the lowest frequency in the FM band. On subsequent selections the last used frequency/station is displayed.

To scan for a station in FM mode

Press and hold 'Tune +/-' to automatically scan through the FM band frequencies, showing the current frequency on the screen display. A scan stops when a signal is found. The search will stop at each station with a strong signal.

Alternatively, you can manually tune, by a single press of 'Tune +/-'.

This will move up or down in 0.05 MHz increments.

Presets

Aria has 10 preset stores for FM stations. Presets 1-3 have dedicated buttons, presets 4-10 are within the on-screen menu.

To store preset 1, 2 or 3

Press and hold the preset 1, 2 or 3 buttons until the display shows the text 'preset saved' with a green tick icon.

To store preset 4-10

Press and hold preset button 4+.

The display will show a list of the Preset stores numbered 1 to 10 these are displayed as either 'Empty' or with the currently stored station name. Use the 'Navigation' dial to choose a preset memory then press 'Select' to store the currently-playing station. After confirming the preset station is stored the display reverts to the Now playing screen.

To recall preset 1, 2 or 3

Press preset button 1, 2 or 3. This will play the radio station stored in preset 1, 2 or 3.

To recall a preset 4-10

Press preset button 4+.

The display will show a list of the presets stored number 1-10.

Use the 'Navigation' dial to choose a preset and press 'Select' to play that station.

Display information

While FM radio is playing, the screen shows its frequency, or if RDS information is available, station name and any further 'RadioText' information. If no information is available, just the frequency and a No RadioText message is shown.

Press Info to cycle through info display options:

- RDS Radio text
- Programme type
- Frequency, name
- Mono/stereo
- Power status
- Date

FM Menu

- > Scan settings
 - Strong stations ONLY
 - All Stations
- > Audio settings
 - Stereo allowed
 - Forced mono
- > System settings - see page 13

Scan settings

By default, FM scans stop at only stations with a strong signal.

To change scan settings to stop at all stations

Press Menu > Scan settings > All stations.

Audio settings

By default, all stereo stations are reproduced in stereo. For weak stations, this may result in poor quality audio. The audio quality can be improved using mono.

To play weak stations in mono

Press Menu > Audio settings > Forced mono.

Bluetooth

Bluetooth mode allows Aria to act as a wireless speaker playing audio content from a connected Bluetooth device.

To enter Bluetooth mode, press 'Source', use the 'Navigation' dial and 'Select' button to choose Bluetooth from the icon menu.

To connect a Bluetooth device, use your Bluetooth smart device to pair and connect with the Aria.

Use the Press '⏮', '⏸' or '⏭' button for music playback.

Bluetooth Menu

Aria does not have Bluetooth menu settings; please check your connected device for settings.

Aux-In mode

Aux-In mode plays audio from an external source such as an MP3 player.

To enter AUX-IN mode, press 'Source', use the 'Navigation' dial and 'Select' button to choose AUX-IN from the icon menu.

To connect to an external audio source:

1. Turn the volume low on both Aria and, if adjustable, the audio source device.
2. Connect the external audio source to the Aux-In 3.5mm stereo socket.
3. Adjust the volume of Aria (and, if necessary, the audio source device) as required.

Alarms

Aria has 2 alarms which can be set independently of each other. Icons on the 'home screen' will indicate which alarms are active. If there are no icons, no alarms are active.

Note: Alarms will only function when the Aria unit is On (Mains power only) or in Standby mode (Mains power only).

Note: Alarms can be switched on or off in standby mode (see below), however, the alarm parameters can only be set when the Aria is on.

To set alarms

Press Menu/Back > System settings > Alarms

Navigate to either Alarm 1 or 2

The alarm setup prompts you for the parameters listed below

Use the 'Navigation' dial and 'Select' button to input the alarm parameters

Parameters

Alarm – Off | On

Frequency – Daily | Once | Weekends | Weekdays

Choose the days on which the alarm is active.

Note: If you choose 'Once', you are prompted to enter the required date.

On time – hours and minutes.

Source – Buzzer | DAB | FM

If DAB or FM is chosen as the audio source you will also be prompted to select the Last played station or one of the preset stations (if set).

Duration – 15 | 30 | 45 | 60 | 90 minutes.

If the alarm is not cancelled Aria returns to standby after this time period.

Volume – (use the volume dial to set the required alarm volume 4-16).

This is the volume the alarm will build up to. (Initially the alarm sounds at a low volume and gradually gets louder to the set volume).

Alarms are indicated by displaying the relevant Alarm 1 and/or Alarm 2 icons on the 'Home Screen'.

At the set time, the alarm will sound and the icons in the display flashes.

Snooze sounding alarm

To snooze sounding alarm - press the 'Navigation' dial once to snooze the alarm for 5 minutes. The radio returns to standby for 5 minutes with a snooze countdown displayed. When the countdown reaches 0 (zero) the alarm is triggered again.

To cancel a sounding alarm and switch the radio to standby
Press Standby or Alarm.

Sleep

To set the sleep timer while the radio is playing press

Menu/Back > System settings > Sleep

You can choose the sleep delay time in minutes from:

Sleep Off | 15 | 30 | 45 | 60 | 90

Use the 'Navigation' Dial and 'Select' button to choose an option.

Once you select a sleep delay period, the display returns to the Now playing screen displaying a Crescent moon icon and the remaining time, in minutes, before the sleep time expires.

After the sleep delay period the radio switches to standby mode.

System settings

System setting can be accessed whichever mode you are in

Press Menu/Back button > System settings

Then choose from the various options as described in the menu as below.

- Sleep
- Alarms
- Equaliser
- Time/Date
- Backlight
- Language
- Factory Reset
- Software upgrade
- Software version

Sleep - see page 13.

This allows Aria to automatically turn itself off after a set amount of time.

Use the 'Navigation' Dial to select either

15, 30, 45 or 90 minutes sleep period. Press 'Select' to active.

Alarms - see page 12.

Equaliser

This presents a number of preset settings plus a My Equaliser option to allow you to create your own equaliser settings.

My EQ... | Normal | Classic | Jazz | Pop | Rock | Speech

My EQ...

This option allows you to set a bias in the treble and bass audio frequencies and turn 'Loudness' On or Off. Values can be set between -7 (Minus 7) and +7 (plus 7).

Treble – (Use the 'Select' control button to choose a bias value between -7 and +7)

Bass – (Use the 'Select' control button to choose a bias value between -7 and +7)

Loudness – On or Off. (When On, low-level high and low frequency sounds are boosted to give a 'fuller' sound.)

Time/Date

The time and date can be updated manually or automatically. With auto-update, the time and date are automatically synchronised with national time signals broadcast over DAB and FM (when available).

You can also select the display format for the time and date.

The time menu contains the following options:

- Set Time/Date – (see below)
- Auto update – Update from Any | Update from DAB | Update from FM | No Update
- Set 12/24 hour – 12 | 24
- Set date format – dd-mm-yyyy | mm-dd-yyyy.

Set time/date

This option is for manually setting the time and date displayed. The time displays as hh:mm, with the first value, hh, active (flashing). Adjust each value using the 'Select' control button and press 'Select' to confirm. The next value then becomes active and flashes. The date values follow and are set in the same way.

Note: The date displays as dd-mm-yyyy or mm-dd-yyyy depending on your choice of date format (see above).

12/24 hour display

To change between 12 and 24 hour display, select Set 12/24 hour and then select your preference.

Auto-update

Auto-update works with data sent over DAB, FM. The clock is only updated when in a corresponding mode, so it is best to select a mode you use regularly.

Manual set

If you set 'No update', the wizard now prompts you to set the time and date manually. The date and time are displayed as dd-mm-yyyy and hh:mm.

Backlight

Aria has a backlight with three brightness settings, and adjustable timeout (this is the time delay, in seconds, after which the display switches to the Dim level).

There are three settings:

- Timeout - Light On | 10 | 20 | 30 | 45 | 60 | 90 | 120 | 180
- On level - Low | Mid | High
- Dim level - Low | Mid | High

Note: A green tick indicates the currently selected value for each setting.

Language

The language used for display messages can be selected from:
English | Français | Deutsch | Italiano

Factory reset

A factory reset clears all user defined settings, replacing them with the original default values, so time/date, preferences/settings, DAB station list and preset stations are all lost.

If you select 'Factory reset', you are asked to confirm by selecting "Yes".

Troubleshooting and error messages

Error messages

Message	Description
	DAB mode
Service not available	No DAB reception
Signal error	The DAB signal has been interrupted
No DAB Station	The listed station cannot be found
(No Name)	The current station does not broadcast an identity name
No stations found	No DAB stations are available – check antenna
	FM mode
No RadioText	No RDS text information is available on this station
No PTY	No RDS programme type information is available
No Name	No RDS station name is being broadcast
	General messages
Update failed	Software upgrade failed
Time is not set	No time value is currently set on this platform
Time Not saved	Any changes made to the time settings will be lost
Alarm Not saved	Any changes made to the Alarm settings will be lost
Invalid Date	The entered value does not match a valid date

Troubleshooting

Problem	Cause	Solutions
FM: Hiss	Low signal strength	Check/move antenna Move radio
DAB: Bubbling/intermittent cut-out		Rescan high-strength stations only For DAB or DAB+, check the current status of local coverage with your national digital radio authority
DAB: 'No stations available' message	Low signal strength	As above then rescan stations

Troubleshooting guide

Problem	Cause	Solution
The unit does not work	Incorrect/lack of connections	Check adapter lead is correctly plugged into the mains and the DC input jack at the side of the unit. Check socket used is connected to the power outlet
No sound	Volume may be set to minimum or headphones not plugged in	Turn up volume and/or check headphones are plugged into the jack
Radio reception noisy (FM)	Signal strength too low	Extend the antenna or adjust the position of the radio. FM stereo - if weak switch to MONO as this requires less signal strength.
Radio reception stutters/bubbling sounds (DAB)	Signal is weak	Extend the antenna or adjust the location of the radio. Positions higher up or nearer windows may improve the reception.
No DAB reception	Location or local coverage	Try re-orienting the antenna or moving the radio to a different location. Check that your local area has DAB coverage.

Technical specifications:

Model:	Aria
Type:	Digital Radio with FM and Bluetooth
Power supply (adaptor input):	100-240V 50/60hz
Adaptor output:	9V 1.5A DC
Radio input:	9V 1.5A DC
Speaker output:	5W RMS, 7W (Peak)
Frequency response:	80Hz-18kHz
Resistance:	Speaker impedance 4Ω

Service

This product should only be repaired or serviced by an authorised service engineer and only genuine approved spare parts should be used.



This symbol  indicates that this product should not be treated as normal household waste and it should be recycled. John Lewis do not operate instore take back, but as members of the Distributor Take Back scheme have funded the development and upgrade of recycling facilities across the UK. Please take it to your nearest collection facility or for further details contact your local council or visit www.recycle-more.co.uk.

Guarantee

For 2 years in respect of defects found to be due to faulty workmanship or material. Proof of purchase is required for validity of the guarantee. This guarantee is no longer valid if the damage has been caused by accidental damage, alteration, repair by any unauthorised persons or poor maintenance. This guarantee in no way affects your statutory rights.

Retain these instructions for future reference



John Lewis Partnership
171 Victoria Street
London SW1E 5NN
johnlewis.com