

INSTALLATION INSTRUCTIONS

DURA BATTERY OPERATED DRAWER LIGHT WITH IR SENSOR

CODE: SE16096C0

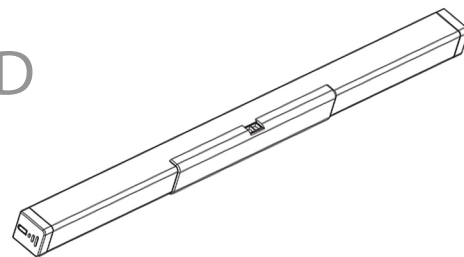

IMPORTANT: Please read these instructions before commencing installation and retain for future reference

Components

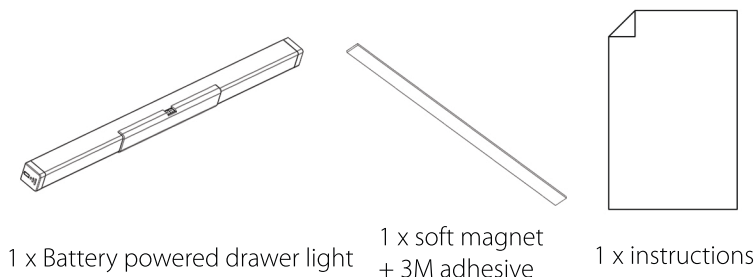

1 x Battery powered drawer light

1 x soft magnet
+ 3M adhesive

1 x instructions

Tools Required

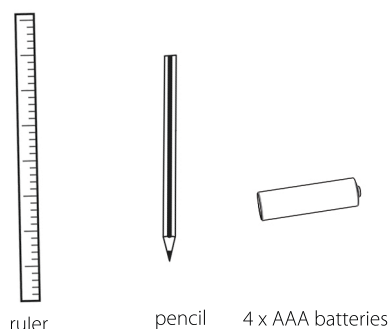

ruler

pencil

4 x AAA batteries

Important Safety Information

Please read these instructions carefully before attempting to install this product. It is advisable to keep these instructions in a safe place for further reference.

These products must not be modified, if any modifications are made it may invalidate the warranty and may render the product unsafe.

Install on smooth, flat and secure surface(s) only.

Position the light where they will not be exposed to steam or splashes.

Suitable for furniture lighting.

When the lamp expires the fitting must be replaced.

Product features

The IR Sensor on this product has two modes. The mode can be changed by using the switch. The switch is located on the reverse side of the IR sensor.

Door Mode: When the switch is turned to the left the door mode will start. When used in a drawer or in a cabinet the light will activate when the drawer/door is opened and will deactivate when the drawer/door is closed.

Swipe switch Mode: When the switch is turned to the right the swipe switch mode will start. When used underneath a cabinet, when the IR sensor is blocked (e.g. passing your hand over the sensor) the light will activate, block the sensor again and the light will deactivate.

This product requires 4 x AAA batteries to run (not included).

Waste Electrical & Electronic Equipment (WEEE)

The symbol on the product, or on the document accompanying the product, the crossed out wheelie bin symbol, indicates that this product may not be treated as household waste. Instead it should be handed over to the applicable collection point for recycling or electrical and electronic waste.



RoHS
Compliant ✓



Installation

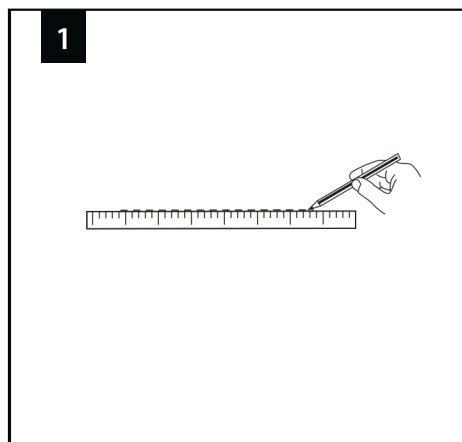

Mark where you want to position the light fitting.

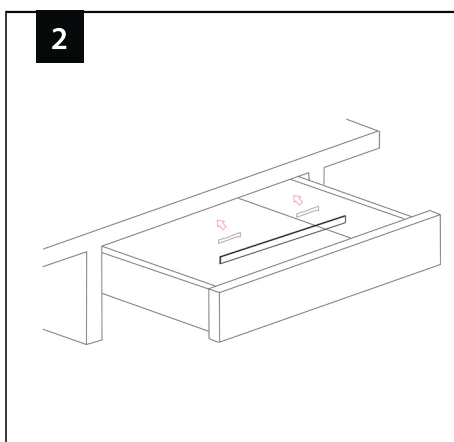

Use the double sided 3M adhesive provided to stick the magnet to the top of the drawer.

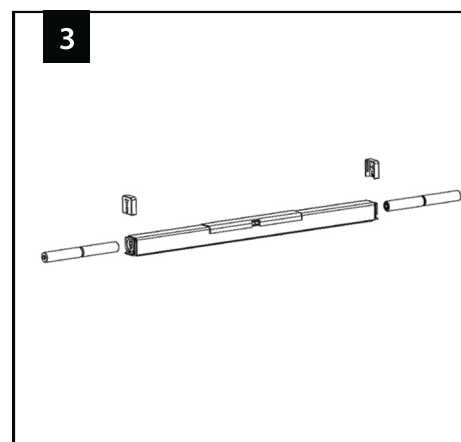

Remove both of the end caps of the fitting and insert the batteries into the compartments. Once finished replace the end caps.

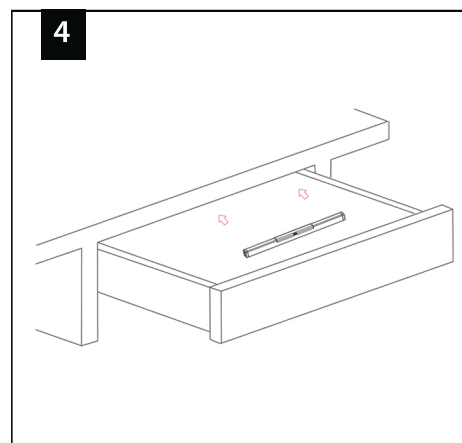

Fix the light fitting onto the magnet.

Important Information:

1. LED's are not replaceable
2. Please ensure the batteries are inserted with the correct polarity
3. Exhausted batteries are to be removed from the fitting as soon as they expire
4. We recommend that different types of batteries or new and used batteries are not mixed
5. Do not use rechargeable batteries in this fitting
6. The battery supply terminals are not to be short-circuited

Maintenance & Care

- Ensure that the power is disconnected prior to cleaning.
- To keep the finish of this product, wipe over with soft cloth periodically.
- Do not use harsh chemical solvents, this may dis-colour or damage the finish.