

1 x QUANTUM DIFFUSED LED FLEXIBLE STRIP

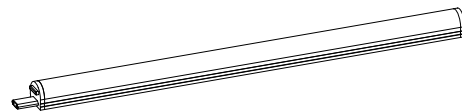

INSTALLATION INSTRUCTIONS

CODE: SE20105C0, SE20105W0, SE20115C0, SE20115W0

IMPORTANT: please read these instructions before commencing installation and retain for future reference.

Components

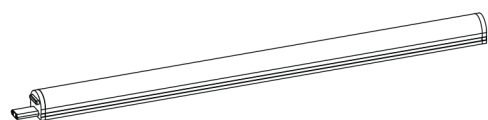

1 x Flexible Strip



1 x End Cap



2 x Mounting Clips

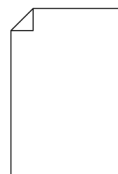

1 x instructions

Tools required



10mm Drill Bit

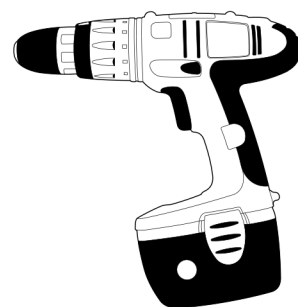

Power Drill

Important safety instructions

Please read these instructions carefully before attempting to install this product. It is advisable to keep these instructions in a safe place for further reference.

We recommend that you consult a qualified electrician.
All electrical installations must be carried out in accordance with current IEE wiring regulations (BS7671).

These products must not be modified, if any modifications are made, it may invalidate the warranty and may render the product unsafe. These LED lights operate low voltage (24V).

Do not wire the individual LED light fittings directly to the mains.
This product is for indoor use only. Keep out of moisture and use only in dry rooms.

- If in doubt installation must be carried out by a qualified electrician.
- Install on smooth flat surface(s) only.
- Make sure that the appropriate LED driver is used with this flexible strip.
- The SE200570 driver connection lead is required to use this product.

Safety instructions

1. Before commencing installation or maintenance, isolate the main electrical supply for the appropriate circuit at the fuse board.
2. This product is only suitable for connecting to a 240V 50Hz supply with use of a 24V driver.
3. The light should be mounted onto a secure surface.
4. Never exceed the total output of the LED driver you are using.

5. Suitable for furniture lighting.
6. When the lamp expires the fitting must be replaced .
7. Class III safety extra low voltage (SELV).

Waste Electrical & Electronic Equipment (WEEE)

The symbol on the product, or on the document accompanying the product, the crossed out wheellie bin symbol, indicated that this product may not be treated as household waste. Instead it shall be handed over to the applicable collection point for the recycling of electrical and electronic waste.



RoHS ✓
Compliant



Installation

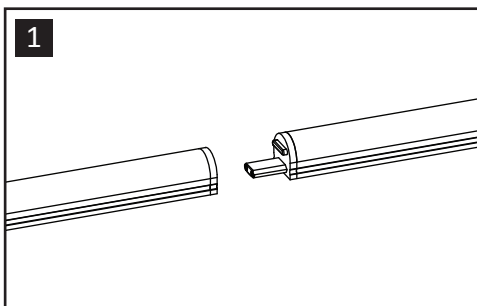

Fittings can be directly interlinked via the male & female connectors on each fitting. Interlink fittings as required before beginning installation.

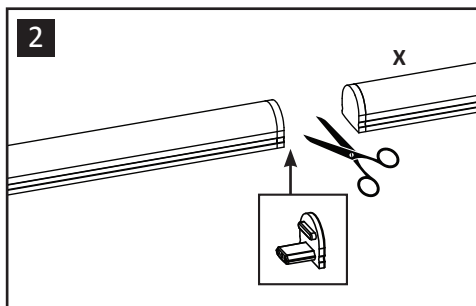

Each strip can be cut to length via the cut points on the back of the strip, which are located at 41mm intervals. Each strip can only be cut ONCE and one cut part must then be discarded. The cut end should then be sealed with the end cap provided and no further strips can be connected.

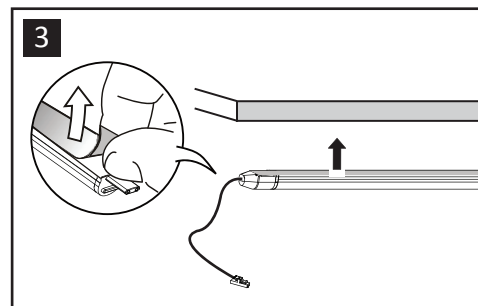

Peel the backing off all linked strips to reveal the 3M adhesive coating on the back of the strip. Carefully secure the strip to the surface in the required position. Mounting clips and screws are also provided to offer additional security. If the product is being mounted under a cabinet we suggest to install using the mounting clips.

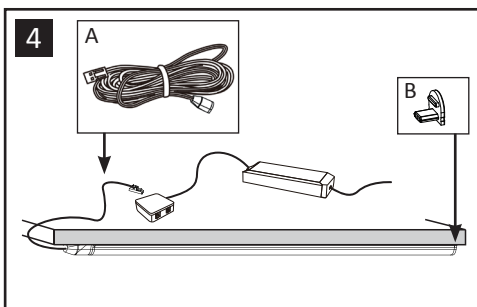

The last strip in the run should be connected to the driver connection lead SE200570 (a). The driver lead connects into one of the ports on the distribution block of the driver (see point 5). Finally replace the end cap (b) to protect the end of the fitting if you have not already done so.

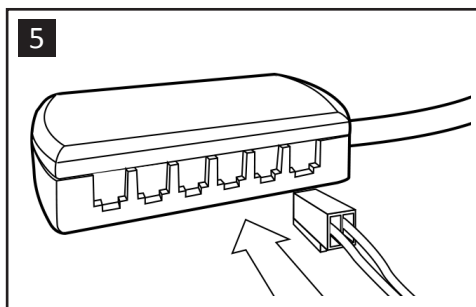

Plug the white connector on the end of the driver connection cable(s) into the 24V LED driver distributor block. Beware not to exceed the wattage of the LED driver, the max wattage will be displayed on the LED driver and on the light unit fitting it will display the wattage requirement.

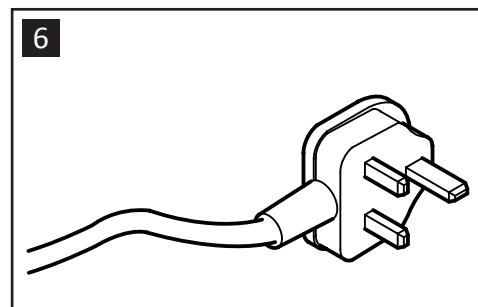

Finally, wire the LED driver to 240V mains supply or 13A plug top.

If the driver will be inside a cabinet use a hole cut between 8mm and 10mm for the cable feed

Accessories listing

SE200570 1.5m Driver Connection

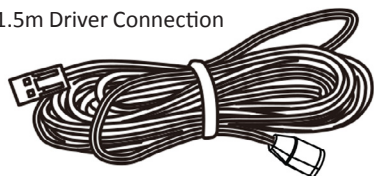

*This item is required to run the flexible strip.

The driver connection lead is an essential accessory to power EACH RUN of the flexible LED strip light.

Corner fitting

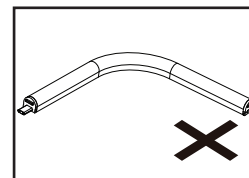
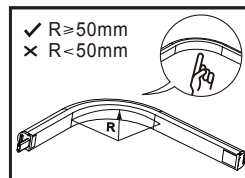
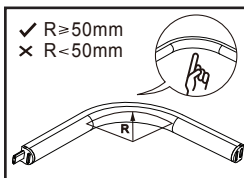

Maintenance & Care

- Ensure that the power is disconnected prior to cleaning.
- To keep the finish of this product, wipe over with a soft cloth periodically.
- Do not use harsh chemical solvents, this may dis-colour or damage the finish.