

If width (X) is greater than 100mm or height (Y) greater than 100mm STOP installation now and contact the customer help line.

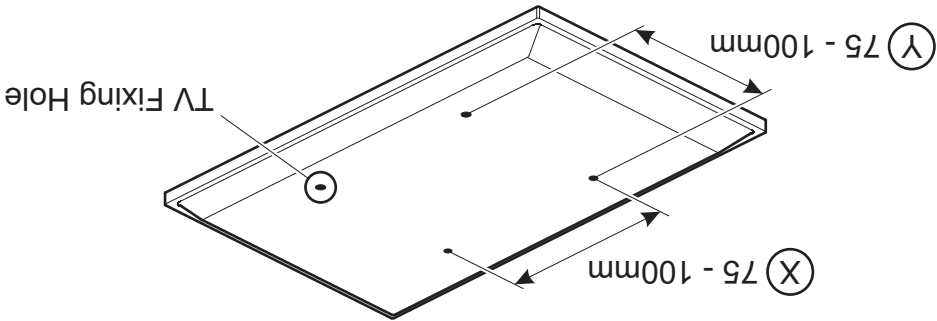

#### 1 Measure the TV Fixing Holes

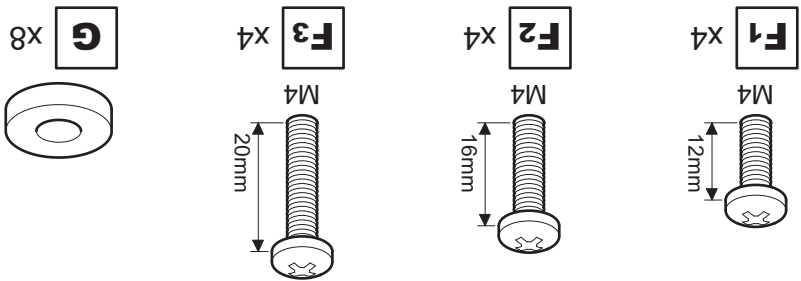

#### TV Screws and Spacers

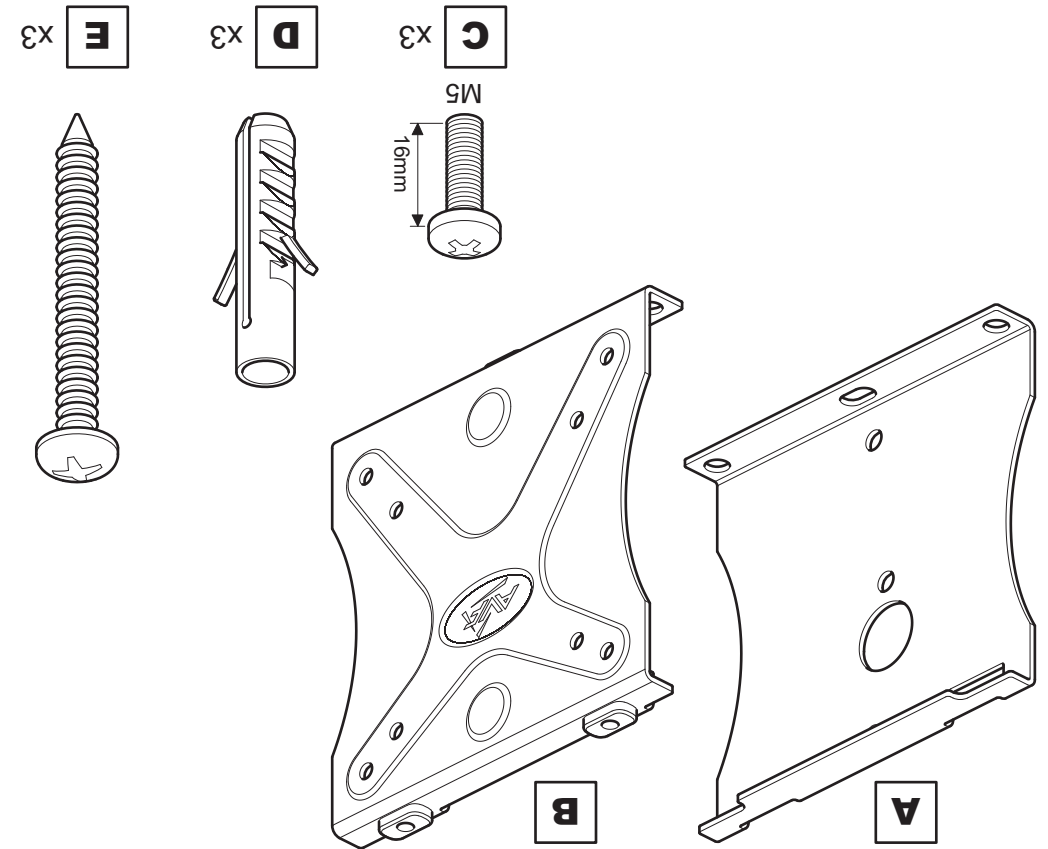

#### Boxed Parts

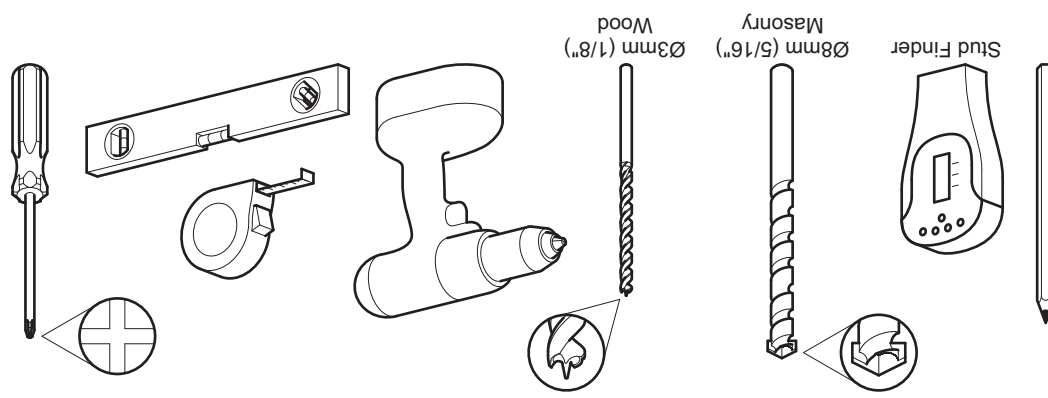

#### Tools Recommended

#### 4 Attach the TV

##### Attaching

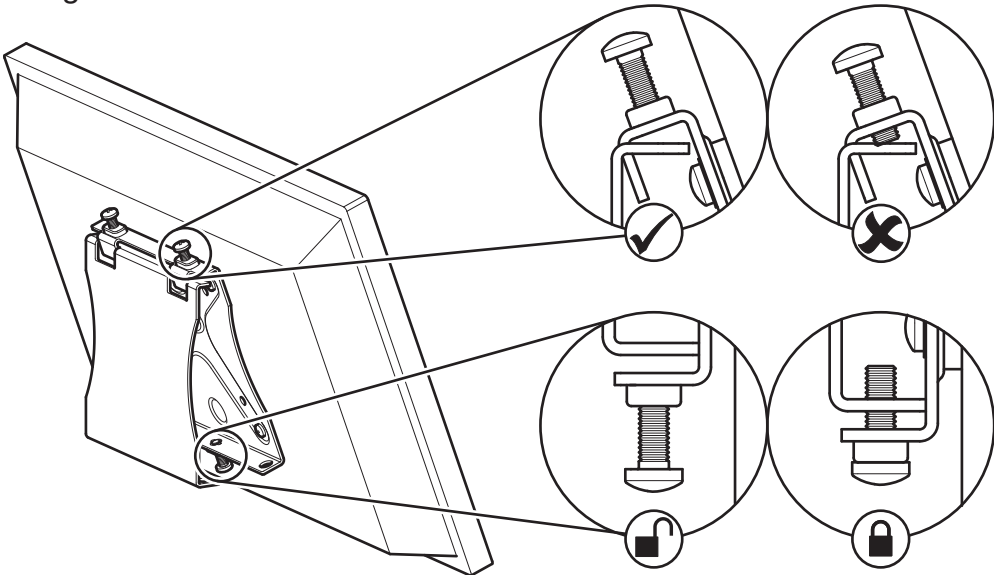

##### TV Levelling

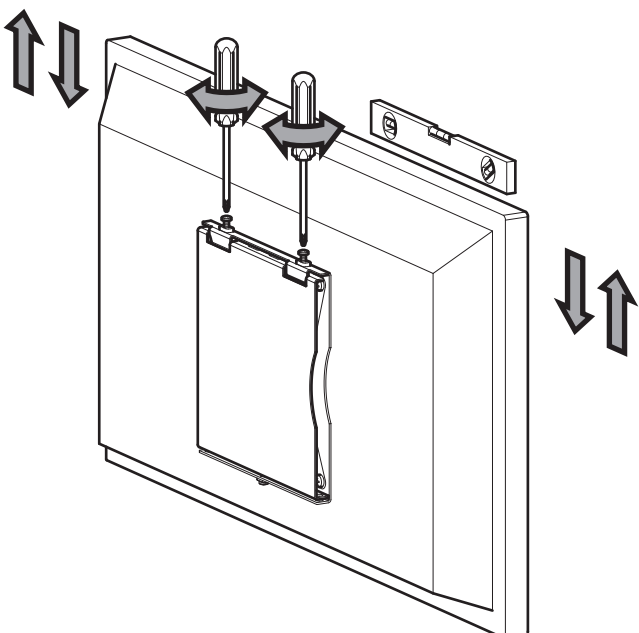

Check all fittings are tight

# JZL100

Leaflet No. 463440 rev00

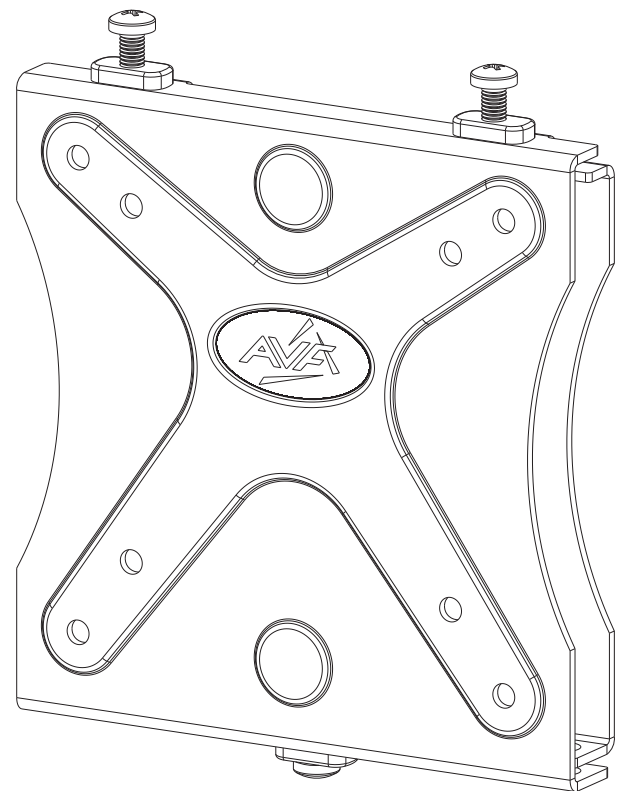

Read through **ALL** instructions before commencing installation. If you have any questions about this product or issues with installation contact the customer services helpline before returning this product to the store. See [j.l.avfgroup.com/p/jzl100](http://j.l.avfgroup.com/p/jzl100) for more information.

CUSTOMER SERVICES HELP LINE NUMBER:

01952 670009  
0870 0609777

33lbs  
15kg

25"  
63cm

AVF Group Ltd. Road 30. Hortonwood Ind Est, Telford, Shropshire, TF1 7YE, England

## 2

## Fitting the TV Bracket

## No Spacers

For TVs with flat/unobstructed back

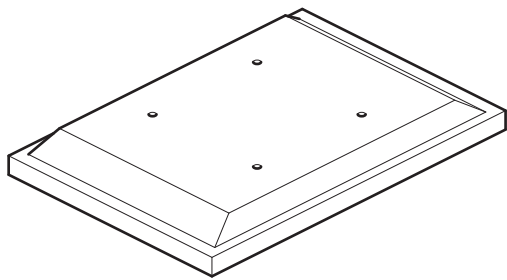

## Spacers

G

For TVs with irregular/obstructed back

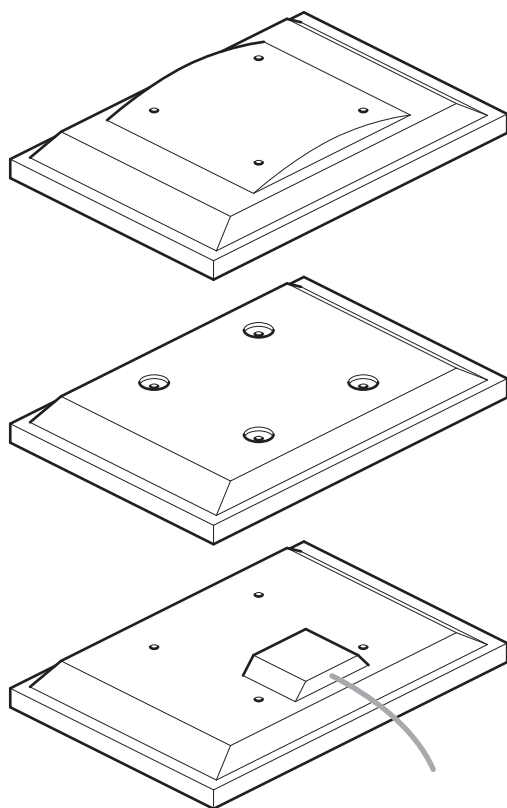

## WARNING

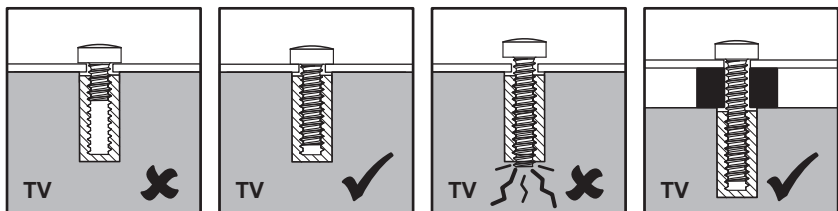

After completing step 2 you will have fittings left over, please keep for future reference.

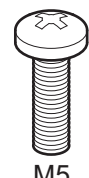
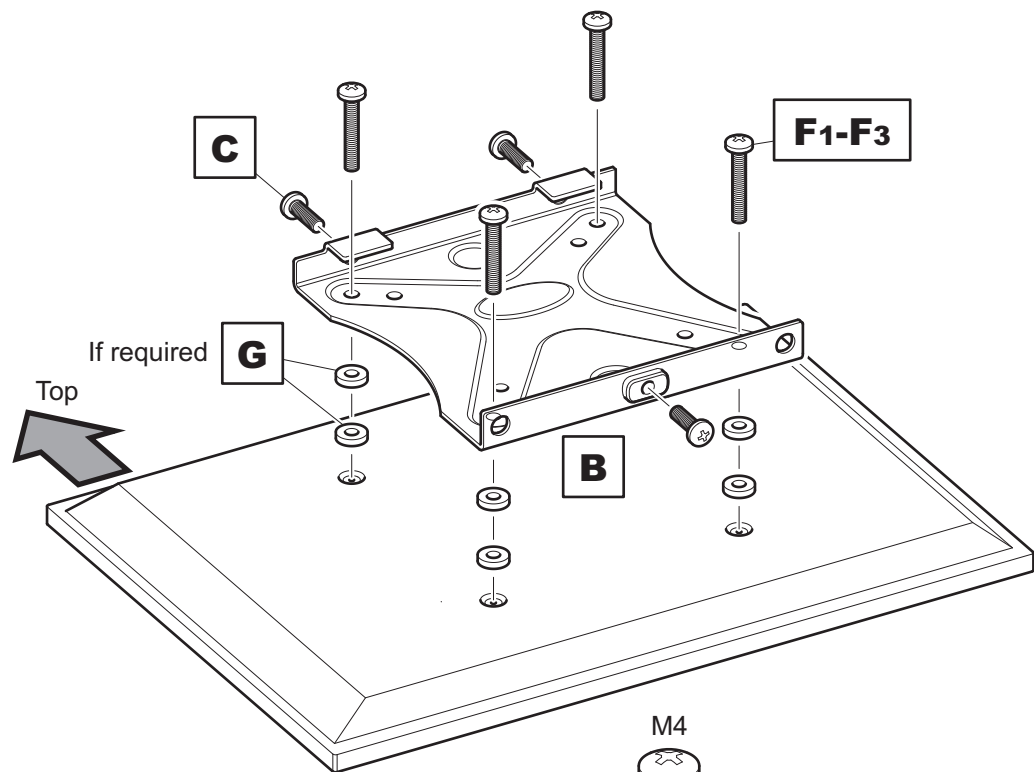

C x3

M4

F1-F3 x4

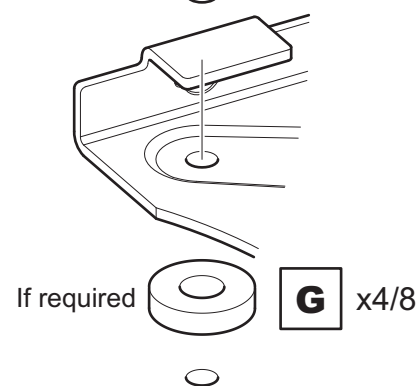

Attach the bracket to the back of your TV using suitable screw and spacer combinations.

## 3

## Fitting the Wall Bracket

## Solid Wall

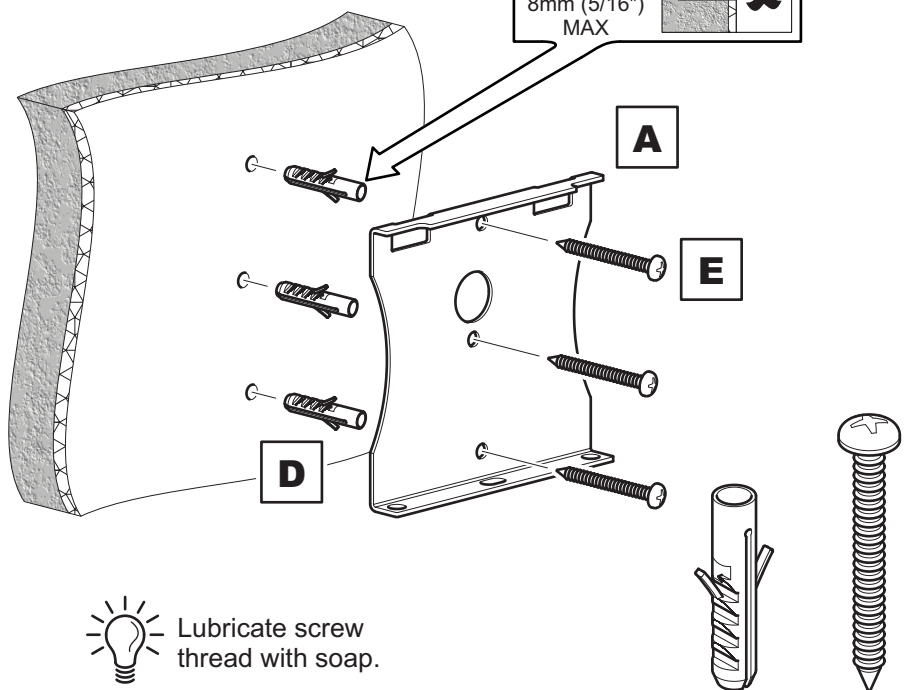
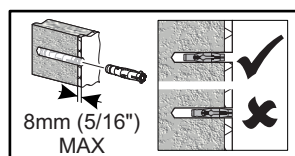
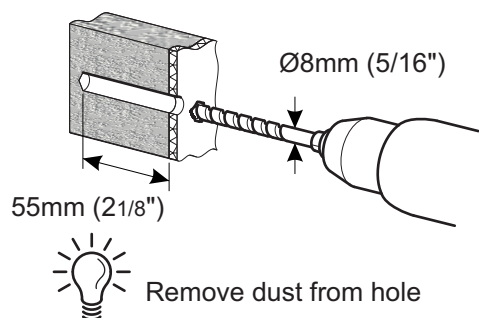
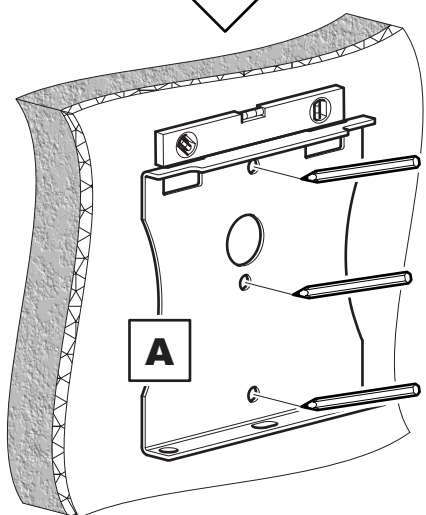

Lubricate screw thread with soap.



DO NOT over tighten screws. Tighten screws by hand only.

D x3

E x3

## Wood Stud

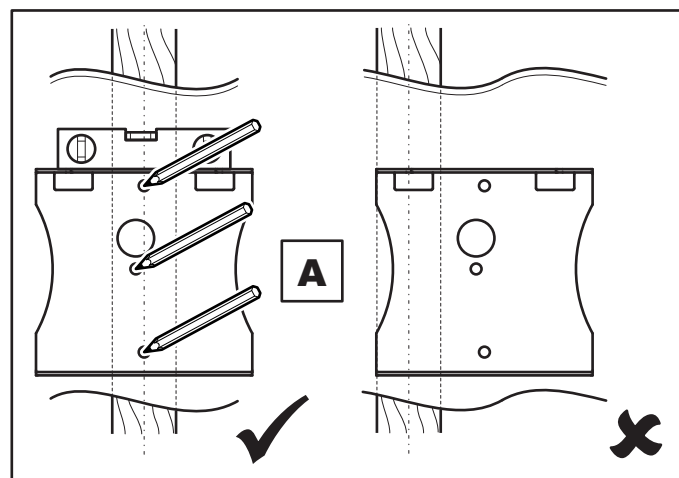

Ensure bracket is in the centre of the wood stud.

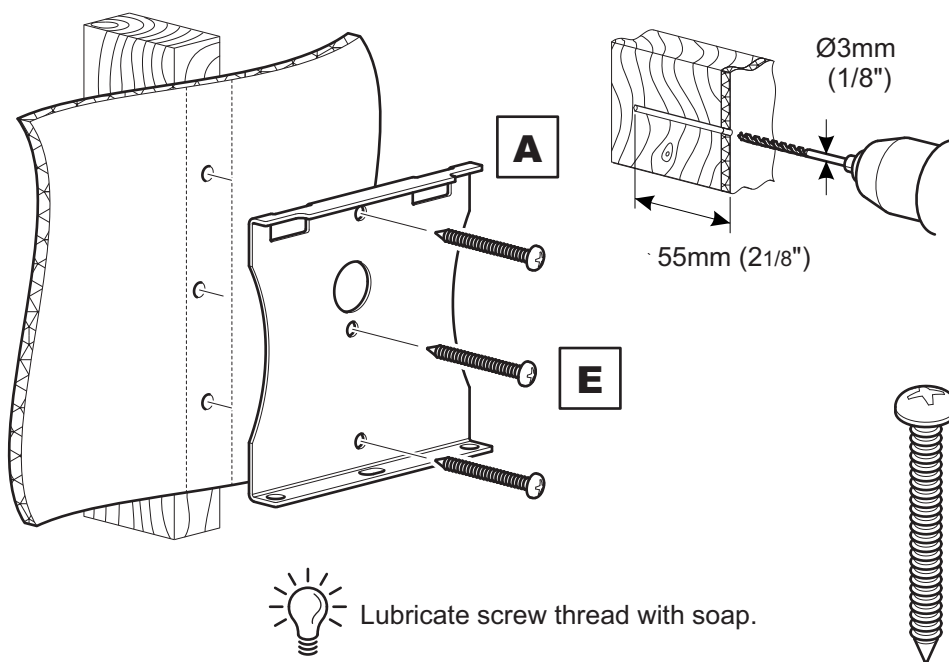

Lubricate screw thread with soap.



DO NOT over tighten screws. Tighten screws by hand only.

E x3