

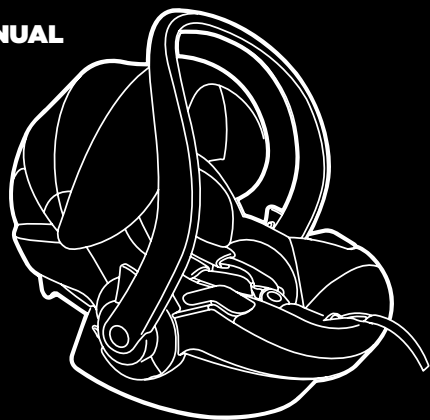



**BeSafe®**

# BeSafe iZi Go Modular™ i-Size

## USER MANUAL



















-  Stature height 40-75 cm
-  Max. weight 13 kg
-  Age 0-12 mths



UN regulation no. R129  
i-Size

SCANDINAVIAN  
SAFETY

	8		104
	14		110
	20		116
	26		122
	32		128
	38		134
	44		140
	50		146
	56		152
	62		158
	68		164
	74		170
	80		176
	86		182
	92		188
	98		194

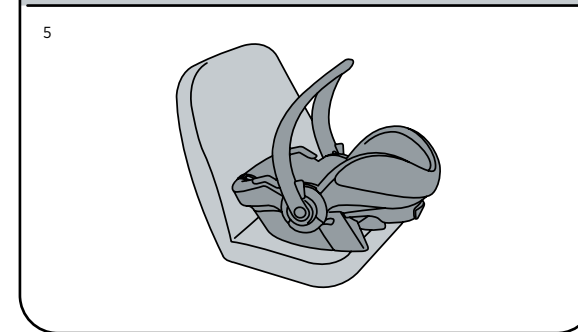
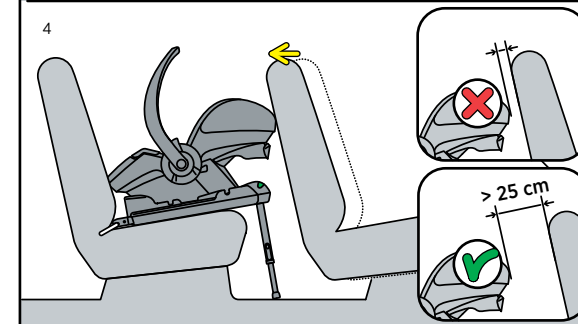
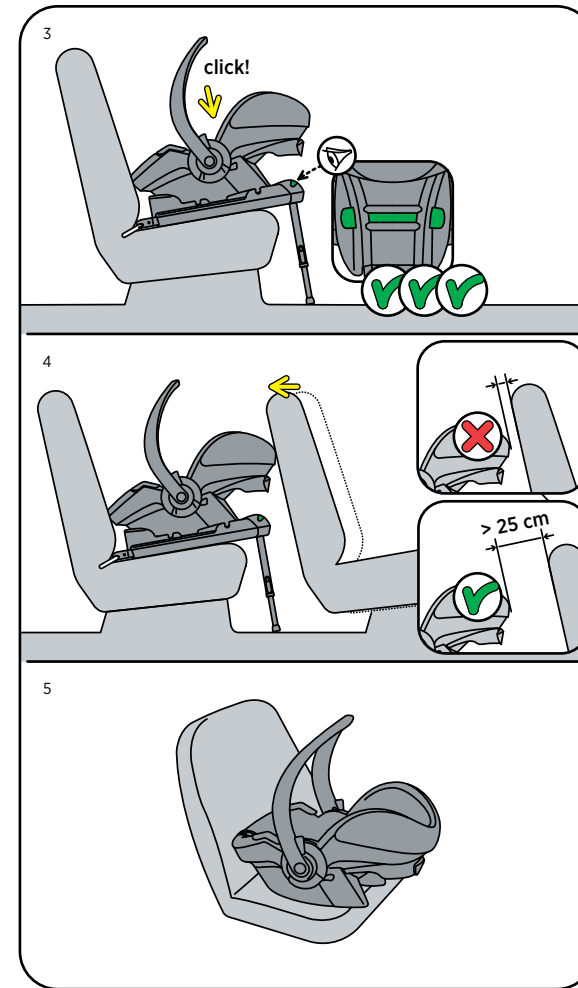
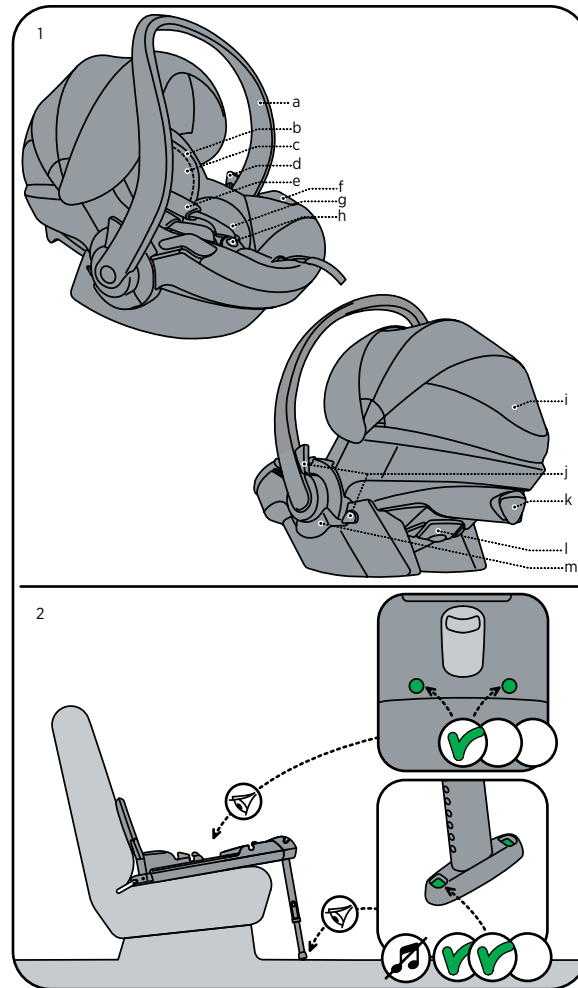

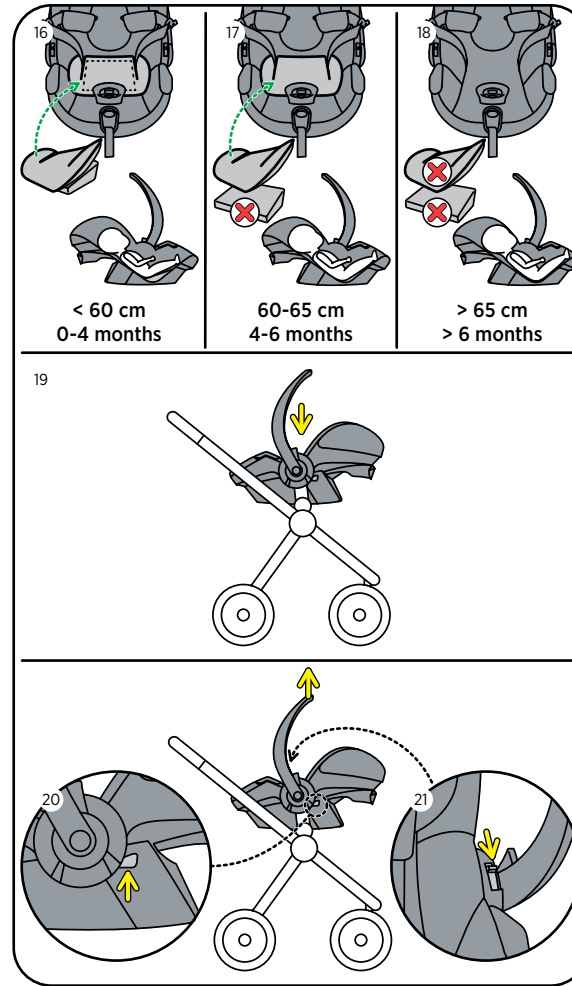
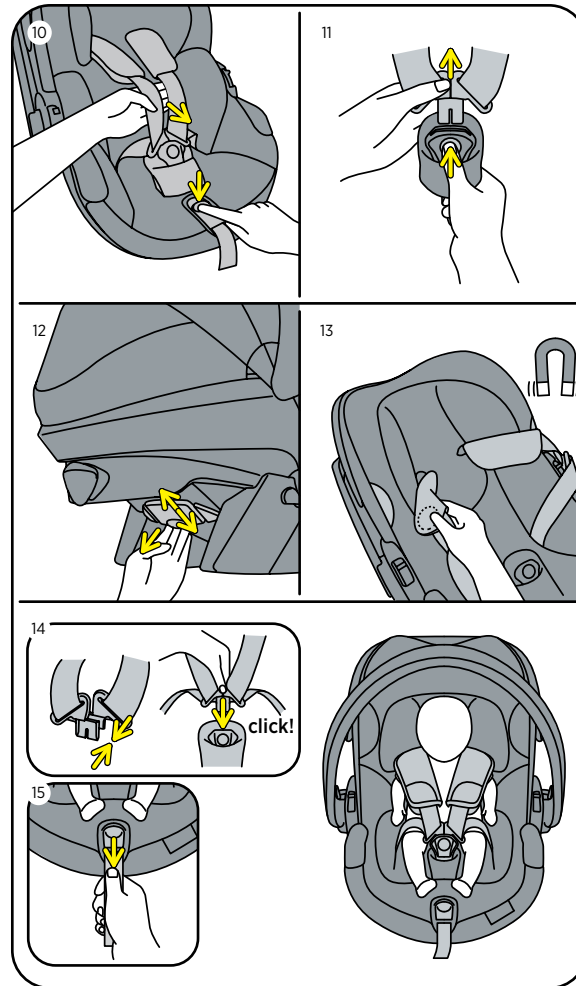
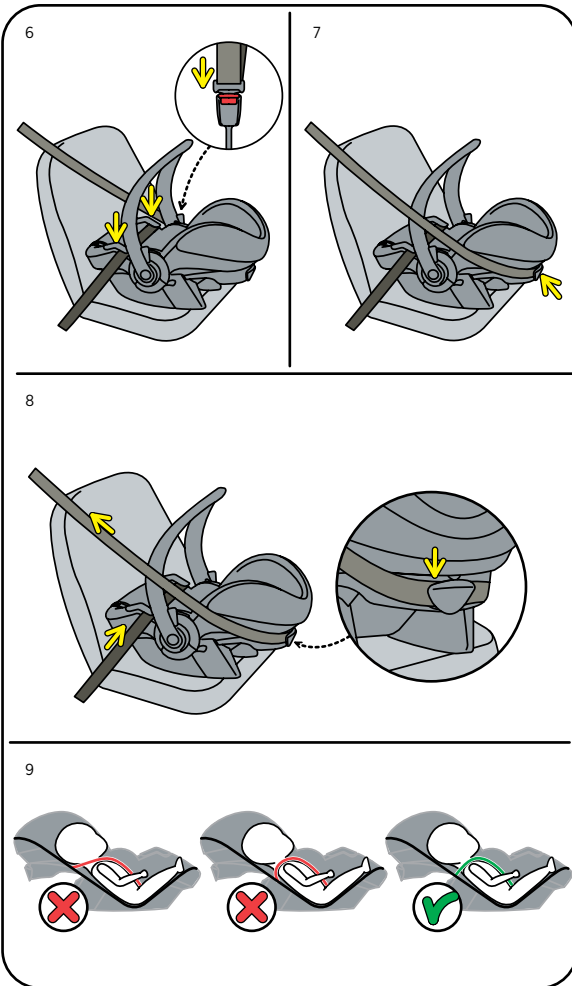

## Thank you for choosing BeSafe iZi Go Modular

! It is important that you read this user manual BEFORE installing your seat. Incorrect installation could endanger your child.

### ! Vital information

- The child seat MUST NOT be installed in a front passenger seat WITH AN ACTIVATED AIRBAG.
- iZi Go Modular can be installed rearfacing on iZi Modular i-Size base or can be installed rearfacing with a 3-point car belt, approved according to UN/ECE Regulation No.16 or other equivalent standards.
- iZi Go Modular is approved for children with a stature height from 40 to 75 cm, with a max. weight of 13 kg.
- The harness straps must always be locked when the child is in the seat.
- The harness straps must be tightened without slack and not twisted.
- The shoulder pads contain magnets. Magnets can influence electronic equipment such as pacemakers.
- Protect any part of the child's body which is exposed to the sun.
- Remove the head space reducers on both sides from the headrest when the child is older than 3 months or if the head is not fitting anymore. These reducers can be removed by opening the velcro on the back of the head rests.
- Remove the baby cushion (bottom part) when the child is taller than 60 cm, or over 4 months.
- Remove the baby cushion (bottom part) and body hugger (upper part) when the child is taller than 65 cm, or over 6 months.
- After an accident, the seat must be replaced. Although it may look undamaged, if you were to have another accident, the seat may not be able to protect your child to the level to which it was designed.
- Prevent the seat from becoming trapped or weighed down by luggage, seats and/or slamming doors.
- Make sure you can fit no more than one finger between the harness and your child (1 cm).
- DO NOT attempt to dismantle, modify or add any part to the seat. Warranty will be void if non-original parts or accessories are used.
- Never leave your child unattended in the seat.
- Make sure all passengers are informed about how to release your child in case of emergency.



- Make sure luggage or other objects are properly secured. Unsecured luggage may cause severe injuries to children and adults in case of accidents.
- Never use the seat without the cover. The cover is a safety feature and may only be replaced by an original BeSafe cover.
- Do not use any aggressive cleaning products; these may harm the construction material of the seat.
- BeSafe advises that child seats should not be bought or sold second-hand.
- KEEP this user manual for later use with the seat.
- DO NOT use the seat for longer than 7 years. Due to ageing, the quality of the material may change.

! Warnings (EN 12790-2009) using the seat as a reclined cradle



- Do not use the seat as reclined cradle once your child can sit unaided.
- This seat is not intended for prolonged periods of sleeping.
- It is dangerous to use this seat on an elevated surface.
- If in doubt, consult either the car seat manufacturer or the retailer.

## Preparing to install

- Carrying handle (1a)
- Head cushion (1b)
- Head space reducer (1c)
- Handle release buttons (2x) (1d)
- Shoulder straps (2x) (1e)
- Hip belt hook (2x) (1f)
- Baby cushion (1g)
- Harness buckle (1h)
- Sun canopy (1i)
- Stroller release handles (4x) (1j)
- Shoulder belt hook (1k)
- Harness height adjuster (1l)
- Stroller adapter house (1m)

## Installation of the seat on the i-Size base

1. Check if the ISOfix and floor support indicators on the base are green. (2)
2. Position the seat in the correct position on the base until it clicks with the base and the indicator at the front shows green. (3)
3. Leave the carrying handle up in the carrying position.
4. When the seat is positioned rearfacing on the back seat of the vehicle, you should, if possible, push the front seat of the vehicle backwards, so that it is in contact with the child seat. If it is not possible to obtain contact with the child seat, push the back rest of the front seat of the vehicle forward as far as possible. (4)
5. The seat is delivered with removable SIP+ (side impact protection +). This extra side impact protection should be used on the doorside of the vehicle. It can be connected by slotting between the seatshell and the fabric. The seat already offers high level integrated side impact protection. This extra side impact protection improves the protection in the side impact still further. (Not on all models)

## Removal of the seat of the i-Size base

- The seat can be taken off by pulling the seat release handle at the front of the base.

## Belt installation

1. Position the seat on the vehicle seat. Make sure the carrying handle is up in the carrying position. (5)
2. Guide the hip belt of the 3-point-belt over the blue sections under the hip belt hooks and fasten the seat belt with a 'click'. (6)
3. Guide the shoulder belt over the blue section through the shoulder belt hook at the rear side of the seat shell. (7)
4. Tighten the 3-point belt by pulling the belt through the hip belt hooks and through the shoulder belt hook until it is as tight as possible. (8)
5. Leave the carrying handle up in carrying position.

## Positioning of the child

1. Check that the shoulder strap slots are level with your child's shoulders. (9)
2. Pull the shoulder straps up while pressing the button of the central adjuster. (10)
3. Open the harness buckle. (11)
4. The height of the shoulder straps and the head cushion can be adjusted by pulling the release handle upwards at the back of the seat and pulling the handle up or down. (12)
5. Position the shoulder straps over the marking at the sides of the seat to use the magnets to keep the harness open while you position the child. (13)
6. When the child is positioned, place the shoulder straps over the child's shoulders and close the buckle: CLICK! (14)
7. Pull the harness strap through the central adjuster in the direction of the arrow straight up/forwards. Continue pulling until the harness is a comfortable but a firm fit. (15)
8. You can protect your child against the sun by raising the sun canopy.

## Baby cushion

The baby cushion offers extra comfort for young babies. As baby grows the thickness of the baby cushions can be adjusted.

- 0-4 m (16)
- 4-6 m (17)
- 6 m + (18)

## Using the iZi Go with a pushchair

The iZi Go can be installed on a range of pushchairs. For a complete list check [www.besafe.com](http://www.besafe.com)

### Installation on a pushchair

- Align the stroller adapter housings above the adapters of the pushchair and push straight down, click (2x) ! (19)

### Removing from a pushchair

1. Move the carrying handle into carrying position.
2. Push the pushchair release levers up at both sides while lifting the seat vertically from the pushchair. (20)
3. You can also release the seat from the pushchair by pushing the release levers beside the carrying handle towards the front of the car seat. (21)

### Removing and refitting the cover

- Do take care when you remove the cover, as re-fitting the cover is done in reverse.

### **Warning: potential misuse**

- The child seat MUST NOT be installed in a front passenger seat WITH AN ACTIVATED AIRBAG.
- The floor support must always be used. Make sure that the floor support is fully pushed down.
- Make sure the indicators are green before you drive.



## Guarantee

- Should this product prove faulty within 24 months of purchase due to materials or manufacturing fault, except covers and harness straps, please return it to the original place of purchase.
- The guarantee is only valid when you use your seat appropriately and with care. Please contact your retailer, they will decide if the seat will be returned to the manufacturer for repair. Replacement or return cannot be claimed. The guarantee is not extended through repair.
- The guarantee expires: when there is no receipt, when defects are caused by incorrect and improper use, when defects are caused by abuse, misuse or negligence.

**BeSafe®**

SCANDINAVIAN  
SAFETY

HTS BeSafe as  
N-3535 Krøderen, Norway - [www.besafe.com](http://www.besafe.com)