

2017

John Lewis



kitchens



## CREATING YOUR PERFECT KITCHEN

Your kitchen is the heart of your home and we understand how important it is to get everything just right. From designing to installing, to making sure everything works effortlessly for many years to come, you can rely on us. We've selected nine inspirational kitchen styles that show what you could achieve in your own home, all of which can be created from our kitchen ranges. You can choose from the most modern to the true classic, each one distinctive, beautifully designed and carefully built. We'll help you create a kitchen you'll love to cook and entertain in, at the very heart of your home





## 80 YEARS OF EXPERTISE

We've been fitting bespoke kitchens since 1932 and we bring all our experience and skills to every kitchen we make.

From designing our ranges to reflect changing styles and the ways we use our homes, to planning and installing your perfect kitchen, we'll make sure every last detail is exactly right.



Fitted kitchen with bespoke window seat - Northamptonshire

## BEAUTIFULLY BESPOKE

Your John Lewis kitchen is unique; a bespoke one-off design that's tailored exactly to your needs and your space.

It's designed for you and hand built to order, and the sheer versatility we offer through our customisable options means that it's a real reflection of your style and needs.

No two John Lewis kitchens are the same, because no two customers are the same.

## SIMPLY BETTER SERVICE

We'll make the journey from idea to installation as easy as possible.

Our planners will work closely with you, and carefully survey and measure your site.

We'll consider every detail before designing a plan that's tailored exactly to your space.

Then we'll expertly build your kitchen and install it.



## BRINGING YOUR VISION TO LIFE

Our planners will design your kitchen to perfectly fit your space and practical requirements.

And if you'd like to experiment with different styles, layouts and colours yourself, try our easy-to-use visualising tool.

Just visit [johnlewis/fittedkitchens.com](http://johnlewis/fittedkitchens.com) to get started.

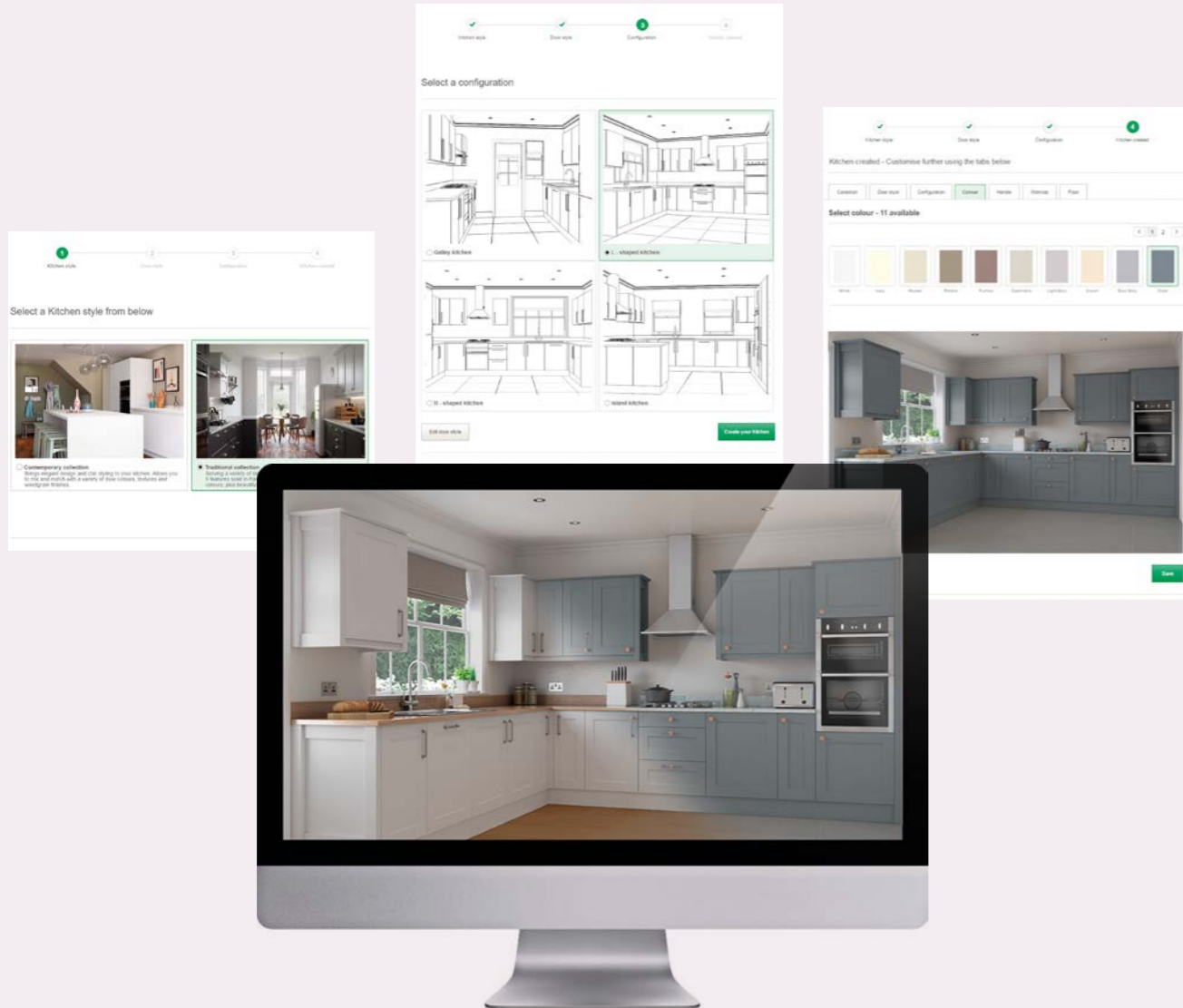

## EXPERTLY INSTALLED, WITH QUALITY GUARANTEED

A good kitchen will stand the test of time, and ours are as durable as they are beautiful. We also believe that a perfect finish should come with complete peace of mind, so your kitchen cabinets are made by skilled craftspeople and covered by our 10-year cabinetry guarantee. And each of our kitchen installers is independently accredited by the BiKBBi ([www.ikkbi.org](http://www.ikkbi.org)).



**10-YEAR  
GUARANTEE  
INCLUDED**

## EVERYTHING YOU NEED, ALL IN ONE PLACE

When you're creating your dream kitchen there are all the extra touches to think about too.

Our unique range of products and services makes it all much easier. We stock everything from beautiful flooring and lighting, to the latest hi-tech appliances and designer tableware.





A MODERN CLASSIC WITH A HOMELY FEEL, this look is defined by its beautiful detailing, exceptional craftsmanship and well-considered materials. Combining warm neutral tones, its relaxed and timeless aesthetic creates a space you'll love coming home to



**Above:** Specially crafted end panels give this look a distinct feel

**Top:** Baskets add texture into a room and are also a practical way to store smaller items



Hide your appliances away, as with this fridge freezer cabinet





Created with our Carradale range in painted cashmere with quartz and wooden worktops

# Get the look

Choose individual pieces with a mixture of warm finishes and textures to complement this look



John Lewis Croft Collection Kyla bar stool  
Offering warmth and character with its solid oak construction and classic design 836 74901



Perrin & Rowe lo two-hole mixer tap with lever handles and rinse 807 00136



Blanco Subline 350/150-U undermount sink 807 10695



Slaked lime (105)  
Little Greene Paint Co.



French grey (113)  
Little Greene Paint Co.



Dolphin (246)  
Little Greene Paint Co.



1



2

3



4



5

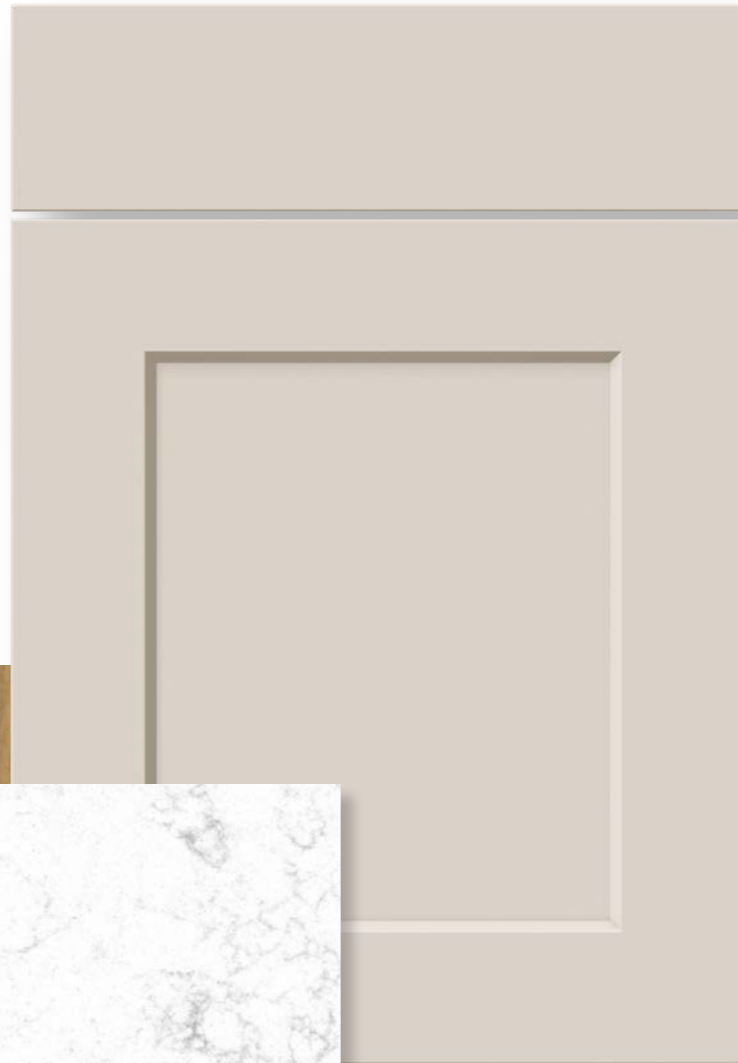

Cashmere painted door



John Lewis Croft Collection 32cm mocha bottle vase 73541002



Original BTC Hector dome switched medium wall light  
A beautiful wall lamp that is made with classic translucent bone china and a movable shade 107 00103



Croft Collection handled chopping board 812 90307

- 1 John Lewis Croft Collection Aiden factory ceiling light  
Add a touch of industrial chic to your home space with this striking metal pendant shade 70142012
- 2 Cast iron finish knob handle
- 3 40mm white oiled character oak wood worktop 808 81208
- 4 John Lewis Wood Elite 15 vinyl flooring NW/109 639 06710
- 5 30mm Jupiter quartz worktop 808 73701



A RUSTIC, RELAXED COUNTRY STYLE with a crafted feel that recalls classic farmhouse kitchens. Warm colours work beautifully with traditional materials to shape an informal, lived-in aesthetic, and a welcoming family space at the heart of your home



**Above left:** Open shelving near the cooking area gives quick easy access to storage



**Top:** Using an accent finish gives the room a feature and focal point

A solid oak table with benches combined with a ceramic sink add to the farmhouse feel





Created with our Leckford range in painted hemp and natural oak with wooden worktops



# Get the look

Copper and oak play a significant role in making up the warmth of this colour palette



Sitting Firm for John Lewis Croft Collection  
Melbury armchair 862 10102



Abode Astbury 2-lever pewter kitchen tap  
With its curvaceous and fluid profile this tap harks back to a golden era in kitchen design 807 03026



Britannia RC-10XGG-QL Q-line dual fuel  
black range cooker 866 83474



Grey moss (234)  
Little Green Paint Co.



Serpentine (233)  
Little Green Paint Co.



Cool arbour (232)  
Little Green Paint Co.



2



1

3



4



Painted hemp door

1 Davey lighting factory copper  
ceiling light 104 00408

2 Cast iron finish knob and  
shell handles

3 John Lewis Wood superior  
vinyl flooring 639 05706

4 40mm character oak wood  
worktop 808 81207



John Lewis 24cm copper casserole dish  
This copper pot has a classic look that's too attractive to store behind cupboard doors  
813 41454



The Oak and Rope Company personalised  
thin round chopping board  
Personalise this beautifully oiled serving  
and chopping board by adding wording  
of your choice 771 70905



Kilner preserve jars, set of 3  
848 23541



A TIMELESS AND ELEGANT STYLE that combines period finesse with subtle modern touches. With its delicate colour palette and traditional textures, this is a light and inspiring kitchen that's beautifully easy to live with



Above left: Furniture can be used to create practical spaces in any room, such as this window seat

Top: A plate rack adds practical storage and classic charm to this kitchen

Adding mirrors to the back of this glazed cabinet creates an elegant feel



Created with our Kensington range in painted dove with Minerva worktops



# Get the look

Choose light coloured pieces to harmonise with the bright, airy feel of this kitchen



**John Lewis Simone leather bar chair**  
This smart button-back bar chair with its sturdy wooden frame, is upholstered in hardwearing faux leather with a padded seat 836 71802



**Abode Fluid monobloc tap**  
Soft and sweeping design makes this tap an attractive addition to your kitchen 807 03132



**LSA International 29cm flower bouquet flared vase** 735 41708



**Loft white (222)**  
Little Green Paint Co.



**Shallows (223)**  
Little Green Paint Co.



**Urbane grey (225)**  
Little Green Paint Co.



1



2

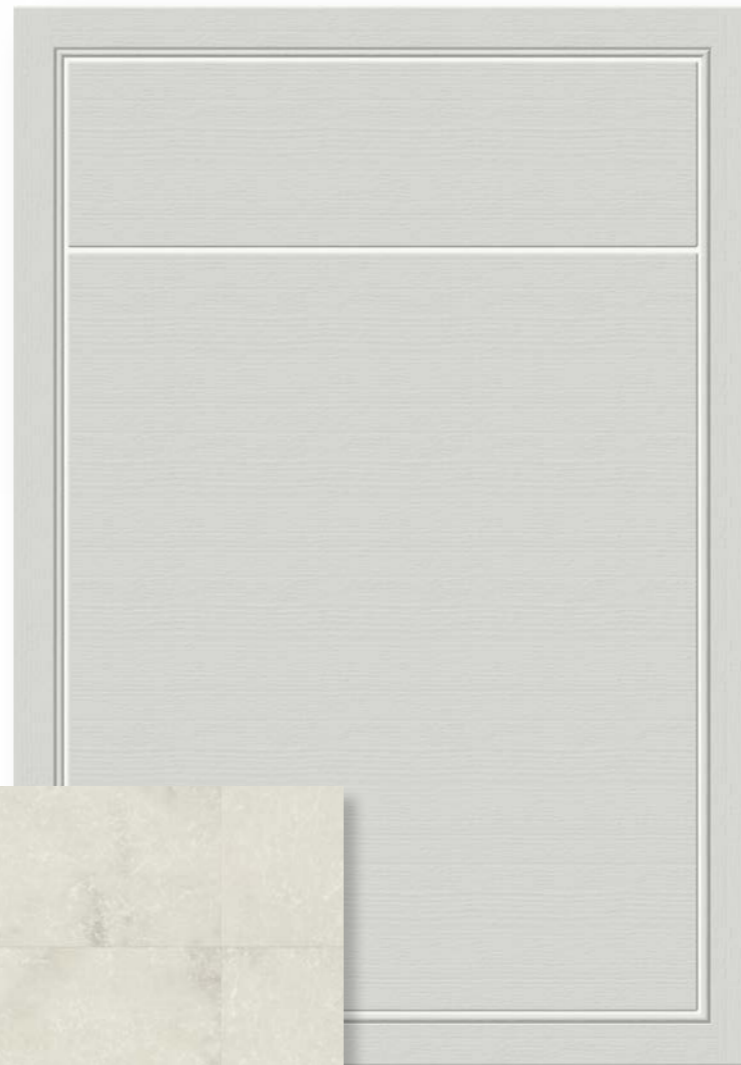

Painted dove door

3



4

1 John Lewis easy-to-fit Madison glass pendant shade 701 81113

2 Stainless steel finish knob handle

3 25mm Minerva Carrara white worktop 808 81509

4 Karndean Art Select Stones Marble flooring 631 52911



**Le Creuset 24cm signature cast iron round casserole pot** 813 48205



**DeLonghi Distinta EC1341 pump espresso coffee maker**  
With a sophisticated matt metallic finish and chrome detailing, this will be a stylish addition to your kitchen 855 08854



**John Lewis Rye plain knit cushion** 603 88410

A CLASSIC  
KITCHEN WITH A  
CONTEMPORARY  
TWIST

using a distinctly bold and confident aesthetic, this is a modern rethink of the classic formal kitchen. Monochrome tones with chrome details deliver beautiful contrasts, creating a dramatic space that offers a true style statement



**Above:** Extending the worktop over your cabinets can create a functional and stylish breakfast bar

**Top:** Accentuate the height of a room with extra tall wall cabinets



Tall cabinets provide ultimate storage and when combined with integrated appliances give clean, elegant lines





Created with our Burford range in painted graphite and cotton with quartz worktops



# Get the look

Pick modern pieces with classic detailing to complement the monochrome painted doors



**Magis Deja Vu bar stool**  
This stylish and contemporary bar stool has a polished finish that gives it a chic look 836 72501



**Abode Hargrave brushed nickel mixer tap** 807 03113



**Smeg TSF02 4-slice 2-slot toaster**  
With its iconic 50s styling, this toaster will add a retro style to any kitchen 855 20512



**Loft white (222)**  
Little Green Paint Co.



**French grey pale (161)**  
Little Green Paint Co.



**French grey (113)**  
Little Green Paint Co.



2



1

3



4



Painted graphite door

1 John Lewis Barrington ceiling pendant  
701 41912

2 Chrome knob and shell handles

3 John Lewis Wood Ultimate 20 vinyl  
flooring LD/111 639 07708

4 30mm Ceres quartz worktop 808 72001



**Hahn premium wall pan rack**  
Beautifully made, and sturdy and strong, this Hahn wall rack is perfect for showing off your pots and pans 807 62709



**Says Who for John Lewis Cotta chair**  
A simple modern chair, that's sure to be a classic for years to come 836 48702



**John Lewis Botanist large wooden crate**  
570 71574



A VERSATILE  
KITCHEN FOR BOTH  
CLASSIC AND  
CONTEMPORARY  
TASTES

giving a refined modern  
update of a timeless heritage  
style. Cool grey tones,  
traditional textures and simple  
detailing combine beautifully,  
to create a kitchen that suits  
both small and large spaces



**Above:** Using decorative items  
instead of wall units can make the  
room feel more open

**Top:** Different depths can be used  
to give an interesting twist to a  
simple run of cabinets



The slim frame of this door  
combined with a brushed  
nickel handle creates a classic  
yet modern feel



Created with our Rialto range in matt dark grey with granite worktops



# Get the look

A simple selection of accessories keeps this kitchen clean and uncluttered



John Lewis lidded jar 848 22007



**Abode Linear style 2 lever chrome kitchen tap**  
Tall and elegant, this tap is a versatile design that will complement a host of interior styles, offering outstanding functionality 807 03021



**Blanco Andano 400-U single bowl stainless steel undermounted sink**  
A simple yet sophisticated sink with high quality features including a covered C-overflow and modern basket strainer 807 12118



**Shallows (223)**  
Little Green Paint Co.



**Urbane grey (225)**  
Little Green Paint Co.



**Scree (227)**  
Little Green Paint Co.



1

2

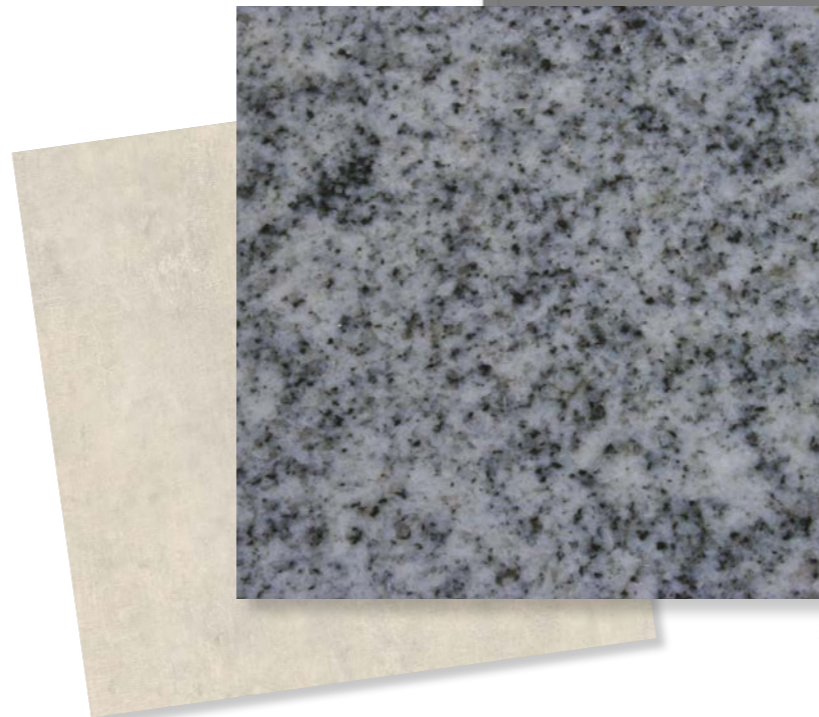

3

Matt dark grey door

- 1 Brushed nickel bridge handles
- 2 John Lewis Smooth Superior 10 vinyl flooring HC/80 639 15701
- 3 30mm Bianco granite worktop 808 76201



**John Lewis JLHDA633 stainless steel and glass cooker hood**  
With its stainless steel finish, this cooker hood will make a smart addition to any modern kitchen, while a glass canopy adds a touch of elegance 866 70247



**Brabantia roll top bread bin.**  
A sleek bread bin crafted from durable and corrosion-resistant pre-coated steel that's easy to clean 848 23141



Emma Hardicker - London, framed print 775 55002



## A WONDERFULLY PRACTICAL KITCHEN

designed to sit comfortably at the heart of a modern home. With its warm wooden tones and clever use of space, this is an informal, versatile and affordable solution for contemporary urban living



**Above left:** Stacking different size wall cabinets makes use of every inch of space

**Top:** Wall rack storage system allows you to adapt your space based on how you use your kitchen



Matching furniture wall panels heightens the overall look and feel in this kitchen





Created with our House by John Lewis range in bardolino grey with matching laminate worktops



# Get the look

These pieces sit perfectly in this House by John Lewis open plan kitchen where bursts of colour complement the wooden tones



**House by John Lewis Fluent chair**  
This simple dining chair has sleek, curved lines making it the ideal match for this interior style 836 48001



**John Lewis Blade kitchen tap** 807 05013



**John Lewis 1.0 stainless steel sink with left hand bowl** 807 11803



**Basalt (221)**  
Little Green Paint Co.



**Lead (117)**  
Little Green Paint Co.



**Shirting (129)**  
Little Green Paint Co.



2

1 Brushed aluminium wrapover handles

2 40mm Bardolino grey laminate worktop

3 John Lewis Tile Elite 15 vinyl flooring ED/07 639 26717



Bardolino grey door



3



**LEON 24cm yellow stock pot**  
This sunny yellow stock pot will cheer up your kitchen 813 46601



**House by John Lewis steel colour grid cushion**  
650 44302



**Breville VKJ946 high gloss kettle**  
This kettle features a super high-gloss finish with a unique perforated metal design 855 57319



A SCANDINAVIAN  
FEEL, MINIMAL  
YET WARM

combining light grey and  
wooden tones which capture a  
pared-back aesthetic that works  
well with warm coloured walls,  
for a practical family kitchen with  
an accessible modernist feel.



**Above left:** Mixing doors with open shelving lets you decide what to keep on show

**Top:** Design cabinets around open shelving lets you decide what to keep on show

A peninsula can be used to create a flexible space for cooking, dining or socialising





Created with our Savina range in painted light grey with quartz worktops



# Get the look

A contemporary mix of materials with accents of both wood and bright colours give a Scandinavian feel



**Says Who for John Lewis Why wood bar stool**  
This classic bar stool is made from oiled solid wood for an attractive natural look and sturdy feel 836 72801



**John Lewis Urbana kitchen mixer tap**  
The urbana kitchen tap features a striking arched spout design and minimalist easy to operate handles 807 05020



**Blanco Andano 700-U single bowl undermounted sink** 807 12177



**Light peach blossom (3)**  
Little Green Paint Co.



**Urbane grey (225)**  
Little Green Paint Co.



**Loft white (222)**  
Little Green Paint Co.



2



3



Painted light grey door

**1 Flos Glo-Ball S1 ceiling light**  
A glowing ball of light suspended from a narrow flex made from hand blown etched opaline glass 701 45414

**2 John Lewis Wood ultimate 20 vinyl flooring LD/101** 639 07701

**3 30mm Ceres quartz worktop** 808 72101



**Anglepoise original 1227 extendable wall light**  
107 10901



**Inaluxe - from Copenhagen with love framed print**  
Noted for its contemporary shapes and vibrant colours this abstract design is perfect for this space 775 95403



**Vitra Eames DSW side chair**  
This iconic chair is beautifully comfortable in design, made from a moulded seat that's designed for every 'body', atop a sturdy maple base 836 46821

SIMPLE, SLEEK  
AND LINEAR,  
minimal yet welcoming.  
This kitchen's clean lines and  
urban feel are the essence of  
fuss-free design. A palette of  
white tones brings the best out  
of your surrounding finishes,  
for a space that's contemporary,  
considered and cool



**Above:** Handleless bi-fold wall cabinets add to the minimal feel of this kitchen

**Top:** The handleless grip rail of these drawers offer a sleek linear design



A utility room can be sleek as well as practical





Created with our Modena matt range in white with white grip rail and Corian worktops

# Get the look

Complement a contemporary linear kitchen with simple angular accessories



**House by John Lewis Asta bar stool**  
A curved seat offers visual contrast to straight legs and parallel stretchers, giving the stool a cohesive aesthetic 836 73202



**John Lewis Profile mixer tap**  
Clean, modernistic design lines with flat and tubular detailing means this tap sits comfortably in this contemporary kitchen 807 05012



**Dark lead (118)**  
Little Green Paint Co.



**French grey (113)**  
Little Green Paint Co.



1

2

3



4

Matt white door

1 **John Lewis Gloria glass brass pendant light** 701 42505

2 **38mm Corian glacier white worktop** 808 82701

3 **John Lewis Wood ultimate 20 vinyl flooring TT37** 639 07714

4 **Design Project by John Lewis no.044 granite grey vinyl wallpaper** 691 03104



**House by John Lewis Hexagonal wood tray**  
Serve your teas, coffees and cakes on this willow wood tray. The shape of the tray offers a different perspective for serveware 621 56503



**Umbrasticks multi hook**  
This innovative piece includes five flip down hooks, and doubles as wall décor when not in use 698 23807



**Michelle Collins - Be Right Back framed print** 775 95205



## BOLD AND MINIMALIST

with a confident design statement for the contemporary urban home. Combining deep blacks and smoky greys with warm copper highlights, it's a sophisticated modern feel that perfectly captures a dramatic city apartment look



**Above:** Black coloured appliances can help complement this kitchen

**Top:** Stack glazed cabinets with simple push open latches

**Right:** Using similar tones throughout the kitchen creates a striking look





Created with our Modena gloss range  
in anthracite with lapitec worktops



# Get the look

Sleek appliances, gadgets and accessories make a bold statement in this kitchen



**La Palma Lem bar stool**  
The steel frame of this stunning bar stool extends downward so that it doubles up as a footrest  
836 70902



**Blanco Culina-s mini CH4600 single lever mixer kitchen tap**  
A delicate stainless steel spring enables freedom of movement down to the bowl area and a precise magnet holder provides comfortable locking  
807 00684



**John Lewis JLWF610 Wine cabinet**  
This compact wine cabinet is ideal for storing and displaying your wine collection  
865 80213



**Shirting (129)**  
Little Green Paint Co.



**Mid lead (114)**  
Little Green Paint Co.



**Scree (227)**  
Little Green Paint Co.



1



2

3



4

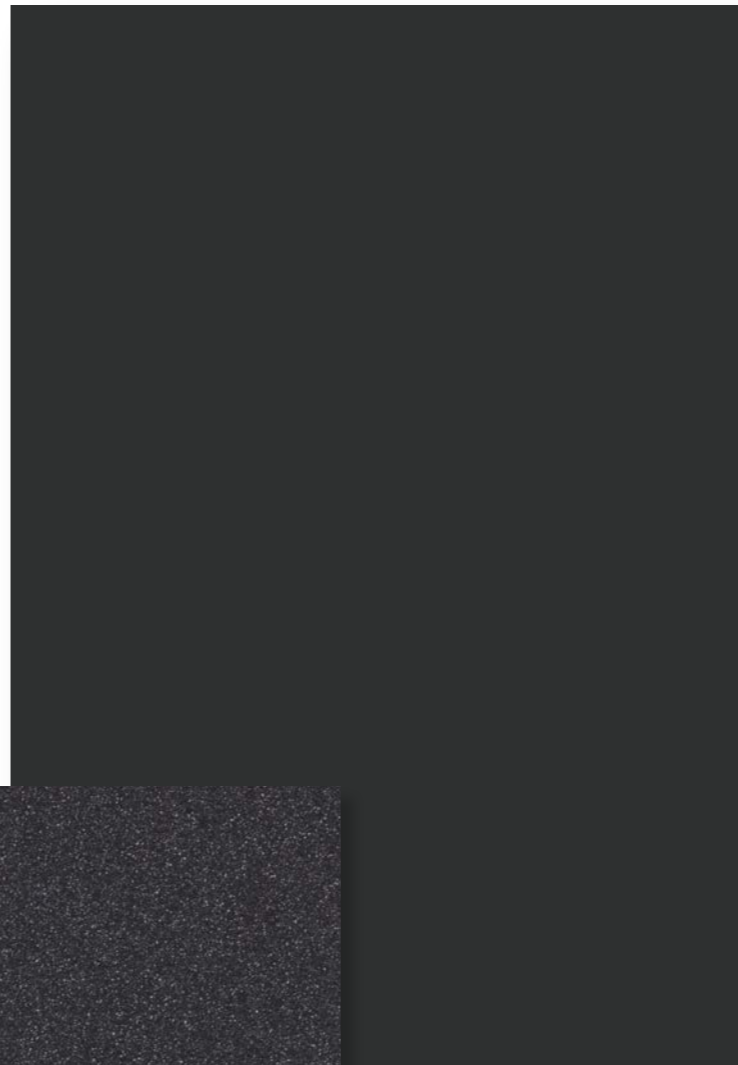

Gloss anthracite door

1 Flos k Tribe bronze s2 ceiling light 10420104

2 Copper finish square bar handle

3 John Lewis Tile Elite 15 vinyl flooring ED/85  
639 26703

4 12mm Lapitec nero anthracite worktop  
808 78801



Elica alpha 60cm chimney cooker hood 866 77342



Blanco subline 400-u granite composite sink



**Tom Dixon brew tray**  
This tray has been engineered with a bold and structured curved edge for a statement piece of serveware  
730 83906

# Turning inspiration into reality

We hope our beautiful kitchens have inspired you. The next step towards making your dream a reality is to book an appointment with one of our Kitchen Selling Partners. We look forward to answering your questions, discussing your plans, and carefully guiding you through the process of creating your perfect kitchen

## To book your appointment

Please go online at [johnlewis.com/fittedkitchens](http://johnlewis.com/fittedkitchens) or visit any of our shops listed opposite



John Lewis fitted kitchen - Northamptonshire

## Shop locations

### LONDON

**John Lewis**  
Oxford Street  
London W1A 1EX  
020 7629 7711

**Peter Jones**  
Sloane Square  
London SW1W 8EL  
020 7730 3434

**John Lewis Brent Cross**  
Brent Cross Shopping Centre  
London NW4 3FL  
020 8202 6535

**John Lewis Kingston**  
Wood Street  
Kingston upon Thames  
KT1 1TE  
020 8547 3000

**John Lewis Stratford**  
101 The Arcade  
Westfield Stratford City  
Montfichet Road  
London E20 1EL  
020 8532 3500

### ENGLAND

**John Lewis Bluewater**  
Greenhithe  
Kent DA9 9SA  
01322 624 123

**John Lewis Birmingham**  
2 Station Street  
Birmingham B2 4AU  
0121 634 6000

**John Lewis Cambridge**  
10 Downing Street  
Cambridge CB2 3DS  
01223 361 292

**John Lewis Cheadle**  
Wilmslow Road  
Cheadle SK8 3BZ  
0161 491 4914

**John Lewis Cribbs Causeway**  
The Mall at Cribbs Causeway  
Bristol BS34 5QU  
0117 959 1100

**John Lewis High Wycombe**  
Holmers Farm Way  
Cressex  
High Wycombe HP12 4NW  
01494 462 666

**John Lewis Leeds**  
Victoria Gate  
Harewood Street  
Leeds S2 7AR  
0113 394 6200

**John Lewis Leicester**  
2 Bath House Lane  
Highcross Shopping Centre  
Leicester LE1 4SA  
0116 242 5777

**John Lewis Liverpool**  
70 South John Street  
Liverpool One  
Liverpool L1 8BJ  
0151 709 7070

**John Lewis Milton Keynes**  
Central Milton Keynes  
MK9 3EP  
01908 679 171

**John Lewis Newcastle**  
Eldon Square  
Newcastle upon Tyne  
NE99 1AB  
0191 232 5000

**John Lewis Norwich**  
All Saints Green  
Norwich NR1 3LX  
01603 660 021

**John Lewis Nottingham**  
Victoria Centre  
Nottingham NG1 3QA  
0115 941 8282

**John Lewis Peterborough**  
Queensgate Centre  
Peterborough PE1 1NL  
01733 344 644

**John Lewis Reading**  
Broad Street  
Reading RG1 2BB  
0118 957 5955

**John Lewis Sheffield**  
Barkers Pool  
Sheffield S1 1EP  
0114 276 8511

**John Lewis Solihull**  
Touchwood  
Solihull  
West Midlands B91 3RA  
0121 704 1121

**John Lewis Southampton**  
West Quay  
Southampton SO15 1QA  
023 8021 6400

**John Lewis Watford**  
The Harlequin Centre  
High Street  
Watford WD17 2TW  
01923 244 266

**John Lewis Welwyn**  
Bridge Road  
Welwyn Garden City  
AL8 6TP  
01707 323 456

**John Lewis York**  
Unit C  
Vangarde Way  
York YO32 9AE  
01904 557 950

### SCOTLAND

**John Lewis Aberdeen**  
George Street  
Aberdeen AB25 1BW  
01224 625 000

**John Lewis Edinburgh**  
69 St James Centre  
Edinburgh EH1 3SP  
0131 556 9121

**John Lewis Glasgow**  
Buchanan Galleries  
Glasgow G1 2GF  
0141 353 6677

### WALES

**John Lewis Cardiff**  
The Hayes  
Cathays  
Cardiff CF10 1EG  
02920 536 000



John Lewis Partnership  
171 Victoria Street  
London SW1E 5NN  
johnlewis.com



IFC 02.17 KBRO/02.17

**John Lewis**  
in store | online | mobile