

Deliveries

Standard delivery is free for all orders of £50 and over, and costs £3.50 when you spend less. We also offer express and next day delivery, as well as delivery on a specific day to suit you. Our delivery service doesn't stop at the front door; we can deliver to the room of your choice and we'll remove any unwanted packaging and recycle responsibly.

Car parking

The nearby Oracle, Queen's Road and Broad Street Mall car parks offer several thousand parking spaces.

John Lewis Financial Services

At John Lewis we offer our own credit card, as well as a range of competitive insurance services, from holiday to home, designed for your peace of mind. You can find out more about our insurance services at [johnlewis.com/insurance](http://johnlewis.com/insurance). If you're interested in the John Lewis credit card, simply ask one of our Partners, or go to [partnershipcard.co.uk](http://partnershipcard.co.uk). Visit our Bureau de change, located on the third floor, to buy foreign currency and traveller's cheques.

John Lewis Insurance

We provide a range of insurance products that are designed to be with you when it matters most. For cover for your home, your car, your pet or even your holiday, you can be reassured we'll always be there for you. To see our full range of insurance products visit [johnlewis.com/insurance](http://johnlewis.com/insurance)

Toilets

Near Women's fashions on the first floor.

Cafés and Restaurants

The Place to Eat on the first floor can seat 220 and serves freshly prepared hot and cold meals, including vegetarian dishes, a children's menu, home-made cakes and pastries.

Facilities for disabled customers

Shopping with us should be easy and convenient for all customers, with no exceptions. All our stores have accessible toilets and lifts, as well as a range of services to help our disabled customers enjoy their shop. To find out what's available, please ask a Partner or visit [johnlewis.com/reading](http://johnlewis.com/reading). You can also call us on 0118 957 5955, or Textphone 18001 + 0118 957 5955 (via Typetalk).

John Lewis

Shopping at John Lewis Reading

If you need this literature in an alternative format, please ask us.

You can find this information and lots more online at [johnlewis.com](http://johnlewis.com)

Shopping hours

Monday	9.30–6.00
Tuesday	9.30–6.00
Wednesday	9.30–6.00
Thursday	9.30–8.00
Friday	9.30–6.00
Saturday	9.00–7.00
Sunday	11.00–5.00
(Sunday browsing)	10.30–11.00

John Lewis  
Broad Street  
Reading RG1 2BB  
Telephone 0118 957 5955  
Fax 0118 952 5999  
[jl\\_reading@johnlewis.co.uk](mailto:jl_reading@johnlewis.co.uk)  
[johnlewis.com](http://johnlewis.com)

John Lewis department stores SD53329 / 02.17



John Lewis  
in store | online | mobile

Welcome to John Lewis Reading

We are part of the John Lewis Partnership and, like all John Lewis department stores, we have three guiding principles:

- To offer the widest possible choice under one roof
- To combine high quality with keen pricing
- To provide a high standard of service, with expert, helpful staff and a whole range of additional benefits and facilities.

About the John Lewis Partnership

There are John Lewis department stores throughout the UK from Aberdeen to Southampton – our first opened in Oxford Street in 1864. In 1929, the company became a profit-sharing democracy; every permanent member of staff is a Partner, benefiting from the success of the business. The Partnership also includes Waitrose food shops.

The widest possible choice

With around 80 types of television, hundreds of large electrical appliances and thousands of different furnishing fabrics – altogether we stock over 350,000 lines. From gloves to garden furniture, cots to computers, pots and pans to curtain poles, there's always a wide range to choose from, to suit most pockets.

Guarantees

John Lewis guarantees are among the best on the market, and are included at no extra cost. All our TVs come with a 5-year guarantee, while all other technology and electrical lighting includes a 2-year guarantee. All our other electrical appliances, large or small, are covered for two years.

Customer collections

Why not drop off your shopping as you go then pick it up when you're ready to leave, from Customer collections. Customer collections is located just off Menswear on the ground floor and also in Mill Lane, just opposite the main Oracle multi-storey car park.

Click & collect

Our Click & collect service is free when you spend £30 and over, and costs £2 when you spend less. Simply order online before 8pm and collect after 2pm the next day from a John Lewis or selected Waitrose shop.

Basement **B**  
Lower ground floor **LG**  
Ground floor **G**  
First floor **1**  
Second floor **2**  
Third floor **3**  
\*Seasonal

## Department listings

Babywear **1**  
Bathroom accessories **2**  
Beauty **G**  
Beauty retreat **LG**  
Beds and bedroom furniture **2**  
Blinds **2**  
Boyswear **1**

Carpets, rugs and flooring **2**  
 Children's shoes **1**  
 Childrenswear **1**  
 China and glass **B**  
 Christmas shop\* **B**  
 Clocks **2**  
 Clothescare **B**  
 Computers **G**  
 Curtains **2**  
 Customer collections **G**  
 Cutlery **B**  
 Electrical appliances  
 (large and small) **B**

Fashion accessories **G**  
 Fashion fabrics **G**  
 Fitted kitchens **B**  
 Floor coverings **2**  
 Frames **G**  
 Furnishing fabrics **2**  
 Furniture **2**

Garden furniture\* **B**  
 Gift List **3**  
 Gifts **G**  
 Girlswear **1**

Haberdashery and crafts **G**  
Handbags **G**  
Hosiery **G**

Jewellery and watches **G**

Kitchenware **B**  
Kuoni Travel **3**

Lighting 2  
Linens 2  
Lingerie 1

Menswear **G**  
Men's shoes **G**  
Mirrors **2**

### Nursery furniture and prams 1

## Pictures 2

Schoolwear **1**  
Silverware **B**  
Sports clothing, shoes  
and equipment **G**  
Stationery **G**  
Sunglasses **G**  
Table linens **B**  
Toys and children's books **1**  
Travel goods **G**  
Women's fashions **1**  
Women's hats **G**  
Women's shoes **1**

Women's fashions **1**  
 Women's hats **G**  
 Women's shoes **1**

BASEMENT

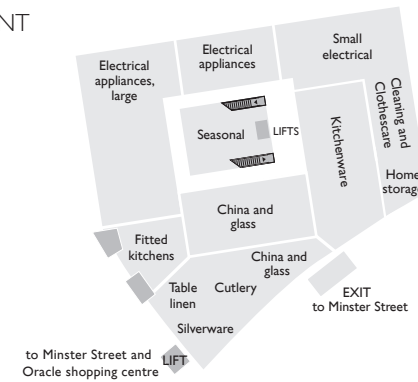

LOWER GROUND  
FLOOR

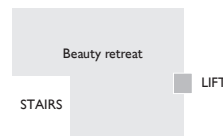

GROUND  
FLOOR



FIRST  
FLOOR

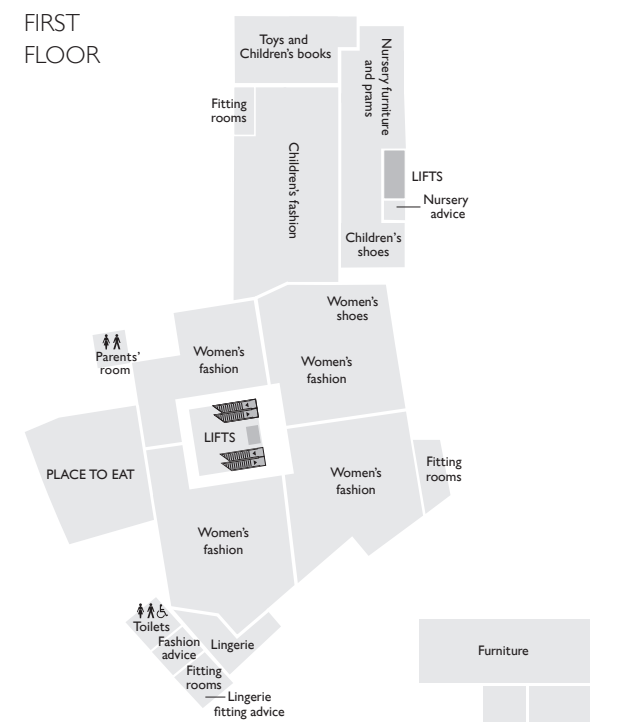

SECOND  
FLOOR



## Services

## Customer support

Bureau de change **3**  
 Customer collection **G**  
 Customer services **3**  
 Export enquiries **3**  
 Lost property **3**  
 Parents' room **1 ♀**  
 Partnership card **3**  
 Toilets **♂♂♀1**

Gift services

Gift list **3**  
Gift wrapping **3**  
Personalised stationery **3**

## Restaurants

## The Place to Eat 1

## Experts on Hand

## Fashion

Beauty treatments **LG**  
Fashion advice **1**  
Lingerie fitting **1**

## Home Design and interiors

Bespoke furnishings and furniture **2**  
 Carpets and flooring **2**  
 Fitted bedroom furniture **2**  
 Home Design service **2**  
 Kitchen design and fit **B**  
 Lighting installation **2**

Nursery

Children shoe fitting **1**  
Nursery advice **1**

### Technical support

Appliance removal and installation **B**  
Computer support and set up **G**  
TV installation and set up **G**